

FOR SALE

IMMACULATE FOUR BEDROOM TOWNHOUSE IN THE PRESTIGIOUS TEMPUS ESTATE

Beautifully designed for modern family living, this spacious one-owner townhouse offers four bedrooms, two bathrooms, and a convenient downstairs powder room, delivering an impressive combination of style, comfort, and functionality. Spread across two levels, this architecturally designed home features light-filled interiors, an open-plan layout, and seamless indoor-outdoor flow - perfect for entertaining or relaxing.

The ground floor welcomes you with a contemporary kitchen, dining, and living space that opens to a private alfresco area and low-maintenance backyard. Upstairs is dedicated to rest and retreat, with four generous bedrooms including a master suite complete with walk-in robe and ensuite.

Set within the highly sought-after Tempus Estate, residents also enjoy access to resort-style facilities including a sparkling pool, BBQ area and landscaped surrounds.

Main Features

- Four generous sized bedrooms, including a master with walk-in robe and ensuite;
- Two stylish bathrooms plus convenient downstairs powder room;
- Modern kitchen with stone bench tops, tiled splashback, breakfast island & quality appliances;
- Light-filled open-plan living and dining area with seamless outdoor connection;
- Covered alfresco entertaining area plus private fenced backyard backing onto bushland;
- Separate laundry and ample storage;
- Single garage with security entry plus an additional covered carport;
- Ducted air-conditioning and ceiling fans throughout;
- Tiled and carpeted flooring;
- Window blinds and curtains;
- High ceilings and security screens;
- NBN internet & individual water meters;
- Gas hot water system;
- Ample storage areas;
- Garden shed;
- Alarm system;
- Sought after side entrance;

4 BED | 2 BATH | 2 CAR

PRICE:

Offers Over \$975,000

OPEN FOR INSPECTION:

N/A



John Perkins

0418380802

john.perkins@atrealty.com.au

mccannperkinsrealestate.com.au

60/28 Bonogin Road
MUDGEERABA

4 Bed

2.5 Bath

2 Car

Internal: 158 m²

External: 12 m²

Total: 170 m²

This is not a legal document. All measurements and images are for illustrative purposes only. Floor plans are intended to give a general indication of the proposed layout only and should only be used as such by any prospective buyer

imagescollab.

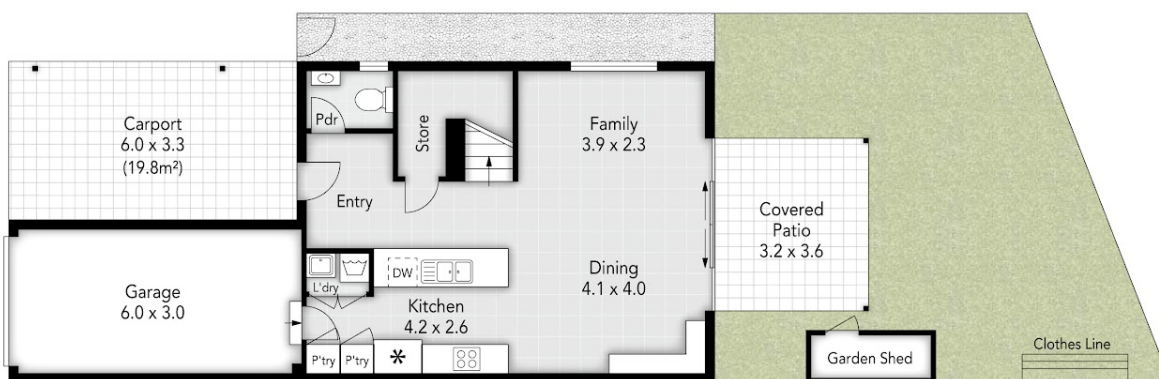

Disclaimer: Please note this floor plan is for marketing purposes and is to be used as a guide only. All dimensions are estimates only and may not be exact measurements.