



SOLD

FRESH, MODERN & EFFORTLESS LIVING – COURT LOCATION

1/4 Nepean Court, Wyndham Vale VIC 3024

Step into style, comfort, and convenience with this light-filled unit that ticks every box for first home buyers, savvy investors, and downsizers alike. Tucked away in a peaceful court, this home offers the perfect blend of modern living and low-maintenance appeal.

From the moment you enter, you'll love the welcoming open-plan layout. The sunlit living and dining zone flows seamlessly into a crisp white kitchen, beautifully appointed with stainless steel appliances, a gas cooktop, and smart storage solutions — making cooking and entertaining a breeze.

The spacious master bedroom boasts his-and-hers built-in robes and sits alongside a sparkling bathroom featuring a wide vanity, contemporary finishes, and a separate laundry for everyday practicality.

Step outside and discover more than you'd expect — a covered carport that opens directly into your own private courtyard via gated entry. This unique feature offers both convenience and security, while the courtyard itself is the ultimate low-maintenance retreat, complete with a handy storage shed and two water tanks.

Why you'll love it:

Bright, open-plan living & dining with split-system heating and cooling

Sleek kitchen with gas cooking & stainless-steel appliances

Spacious bedroom with his-and-hers built-in robes

Stylish bathroom + separate laundry

Covered carport with private gated courtyard access

1 BED | 1 BATH | 1 CAR

PRICE:
\$335,000

OPEN FOR INSPECTION:
N/A



Lynda Lazaridis
0481591932
lyndalazaridis@atrealty.com.au
www.atrealty.com.au

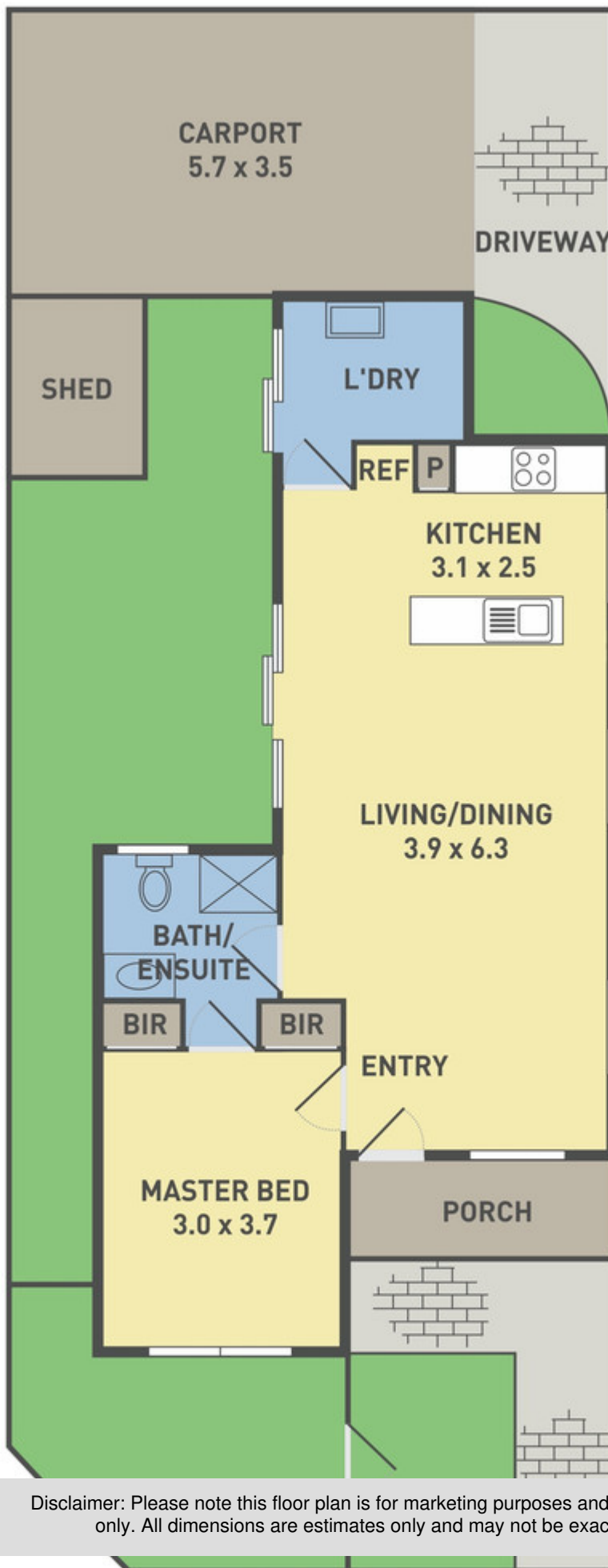

Disclaimer: Please note this floor plan is for marketing purposes and is to be used as a guide only. All dimensions are estimates only and may not be exact measurements.

The measurements provided herein may not be accurate. In order to satisfy yourself of the exact dimension of each room and the premises generally we advise you conduct your own measurements and/or engage the service of a qualified surveyor.

Lynda Lazaridis
0481591932

lyndalazaridis@arealty.com.au

www.atrealty.com.au

