



SOLD

THERE IS NO BETTER VALUE FOR MONEY!!

Welcome to "Meadow Peak", a residential gated enclave of just 124 Units & Townhouses located within the highly regarded Palm Meadows Golf Course Estate. The world-class, 250-hectare par-72 course designed by Graham Marsh is but a few minutes' walk away as is the well renowned Mercure Resort Hotel.

The grand Fountain that greets you as you drive into this impressive precinct, gives you an immediate sense that you are amongst quality properties that exude a sense of prestige.

Perfectly positioned with a northerly aspect capturing stunning Water & Golf Course views, this tastefully renovated and presented Townhouse offers the very best in refined living within tranquil surrounds.

Infused with copious natural light, this immaculately maintained 3-bedroom 2.5-bathroom residence is "move in ready" with absolutely nothing to do – except congratulate your self on making an astute purchasing decision.

Comfort, Quality & Practically are evident in every aspect of the improvements that this lovely home has enjoyed at the hands of its talented owner.

A consummate entertainer will just love the stunning new kitchen, its "heart" where one not only gets to showcase one's culinary skills but remain connected to family & friends whilst being the perfect host.

The spacious Alfresco deck that flows seamlessly out to those amazing all year-round views will become your favourite place to entertain or simply indulge in some personal relaxation.

The upper-level features 3 spacious and light filled bedrooms suitably separated by a lovely sitting area at the top of the staircase landing.

One could retreat purely to the Master Suite and sit quietly on its private balcony, taking in those stunning views.

With exclusive use of two (2) Resort styles Swimming Pools and BBQ Facilities, this idyllic property offers the perfect blend of luxury and convenience.

A personal viewing is the only way to fully appreciate all the features this property has to offer, which include.

3 BED | 2 BATH | 1 CAR

PRICE:
\$1,300,000

OPEN FOR INSPECTION:
N/A



Margaret Baszko
0414806645
margaret.baszko@atrealty.com.au
www.atrealty.com.au

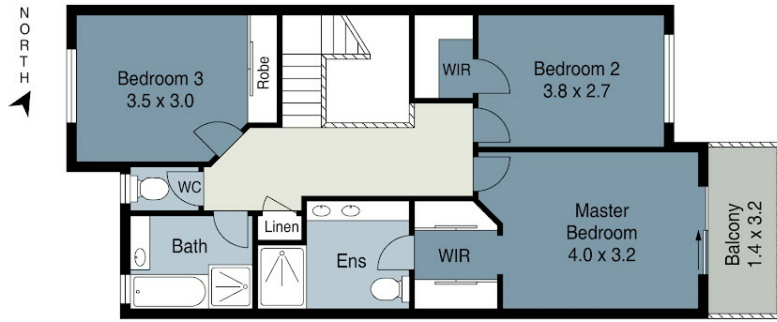

First Floor

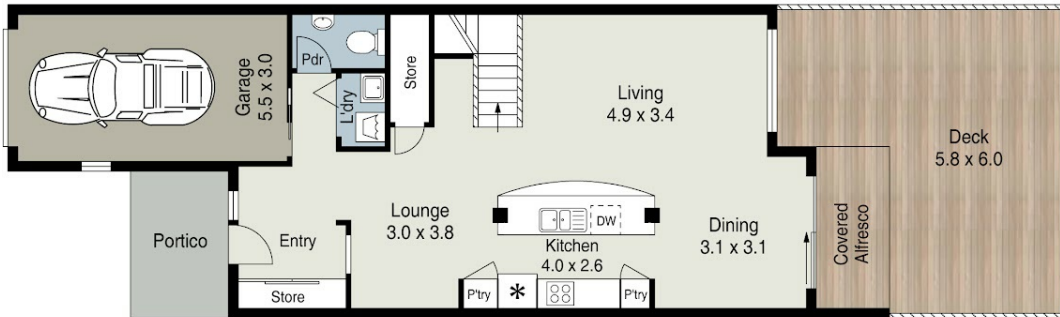

Ground Floor

**22 / 85 Palm Meadows Drive
Carrara**

3 bed | 2.5 bath | 1 car

Property Size

Internal	151m ²
External	63m ²
Total	214m²

All measurements shown in metres are approximate and are for illustration purposes only. It should not be considered 100% accurate. Interested parties should rely on their own enquiries. Reproduction in whole or part of this publication is not permitted without written consent from Izura Photography.



Disclaimer: Please note this floor plan is for marketing purposes and is to be used as a guide only. All dimensions are estimates only and may not be exact measurements.

