



SOLD

SECURE - FULLY EQUIPPED 1BR DARWIN CITY APARTMENT

"Perfectly positioned in Darwin's CBD, sophisticated 1-bedroom apartment offers the ultimate urban lifestyle with convenience at your doorstep. This modern residence comes fully furnished and equipped – simply bring your suitcase and start living immediately.

Step into this thoughtfully designed apartment featuring a well-appointed bedroom with built-in wardrobe and modern bathroom. Open-plan living creates a seamless flow throughout the home, maximising both comfort and functionality. Split system air conditioning assures climate comfort all year-round, essential for Darwin's tropical climate.

- Private balcony perfect for morning coffee or evening relaxation
- Secure parking space included for one vehicle
- Split system air conditioning for optimal climate control
- Built-in wardrobes maximising storage efficiency
- Fully furnished with quality furniture and fittings throughout
- Complete kitchen setup with dishwasher and all essentials provided

This turnkey apartment means you can move in today without the hassle of furniture shopping or setting up utilities. Whether you're relocating for work, seeking a low-maintenance lifestyle, or looking for hassle-free rental accommodation, this fully equipped residence delivers instant comfort and convenience.

Living in Darwin City means immersing yourself in the Territory's rich cultural tapestry. Your new home sits among Darwin's most significant landmarks, including Parliament House, Government House, and the Northern Territory Supreme Court. The stunning George Brown Darwin Botanic Gardens and Bicentennial Park are literally on your doorstep.

CBD location couldn't be more convenient for professionals and urban enthusiasts. You'll have immediate access to employment opportunities and the city's thriving commercial scene. The area's multicultural character, with over 40% of residents born overseas, creates a vibrant and diverse community atmosphere.

- Walking distance to Parliament House and Government House

1 BED | 1 BATH | 1 CAR

PRICE:
\$350,000

OPEN FOR INSPECTION:
N/A



Byron Wauchope
0424181530
byron@atrealty.com.au
www.atrealty.com.au

APARTMENT AREA

INTERNAL	= 59m ²
BALCONY	= 8m ²
TOTAL	= 67m ²

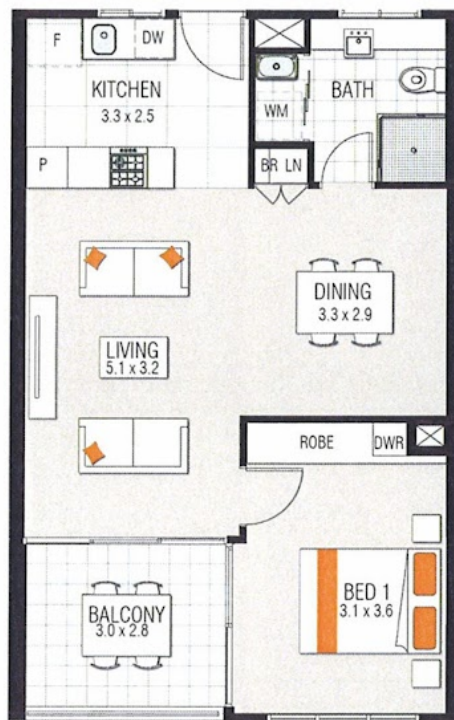

APARTMENTS

- 402, 403, 404, 405, 406, 407, 408, 409, 410
- 502, 503, 504, 505, 506, 507, 508, 509, 510
- 602, 603, 604, 605, 606, 607, 608, 609, 610
- 702, 703, 704, 705, 706, 707, 708, 709, 710
- 802, 803, 804, 805, 806, 807, 808, 809, 810
- 902, 903, 904, 905, 906, 907, 908, 909, 910
- 1002, 1003, 1004, 1005, 1006, 1007, 1008, 1009, 1010
- 1102, 1103, 1104, 1105, 1106, 1107, 1108, 1109, 1110
- 1202, 1203, 1204, 1205, 1206, 1207, 1208, 1209, 1210

BRIGGS ST APARTMENTS, DARWIN

1 BED APARTMENT - LEVELS 4-12



27-11-12

This plan is indicative of the proposed development, design and layout of the unit. The seller may, in its absolute discretion, change the final design and layout of the unit. For example without limitation, the location and size of any internal area or room may be different to that indicated. Area Measurements: Areas noted on architectural plans are generally measured to the centre line of common walls and the outer face of the wall separating internal areas, including where applicable balconies, courtyards and internal access passages. Areas also include the areas of ducts that fall within the outer walls of the lot. Areas shown on draft building formal plans included on all individual apartments may differ from areas on architectural plans due to different methods of measurement. Loose furniture and fittings are for artistic purposes only.

Disclaimer: Please note this floor plan is for marketing purposes and is to be used as a guide only. All dimensions are estimates only and may not be exact measurements.