

SOLD

COMING SOON, OUTSTANDING DUPLEX OPPORTUNITY – SPACE, PRIVACY & LIFESTYLE

COMING SOON, OPEN HOUSE ON HOLD

This sensational two-bedroom duplex is positioned in a quiet, leafy no-through street and offers an exceptional combination of space, privacy, and convenience. Set on a generous block thanks to the clever positioning of the building, this property boasts an expansive outdoor area rarely found in duplex living.

With no body corporate fees (shared building insurance only), this home has been well cared for and updated, including modern kitchen and flooring upgrades in recent years. The open-plan living and dining areas flow effortlessly into the fully enclosed Florida Room – a versatile space ideal for additional living, entertaining, or alfresco dining. Complete with outdoor power and insect-proof screening, it's the perfect spot to relax year-round while enjoying tranquil garden views and the abundance of visiting birdlife.

The established native gardens create a private and leafy retreat, complemented by a feature olive tree at the front entrance and a thriving lime tree at the rear. The spacious grassed yard provides plenty of room for children or pets, with potential for a pool if desired. A 2.7m x 3m garden shed offers excellent storage for tools and equipment.

Inside, both bedrooms are bright and spacious, each with built-in robes, while the modern kitchen enjoys leafy outlooks over the garden and sunroom. Comfort is assured with air conditioning in the main living area and solar power to help keep running costs down.

Property Features:

No body corporate fees (building insurance only)

3.9kW solar power system

Single lock-up garage with internal access

2 BED | 1 BATH | 1 CAR

PRICE:
\$751,000

OPEN FOR INSPECTION:
N/A



Tony Brown
0418961500
tonybrown@atrealty.com.au
www.atrealty.com.au

CONTACT:
TONY BROWN
 tonybrown@realty.com.au
 0418 961 500
 @realty

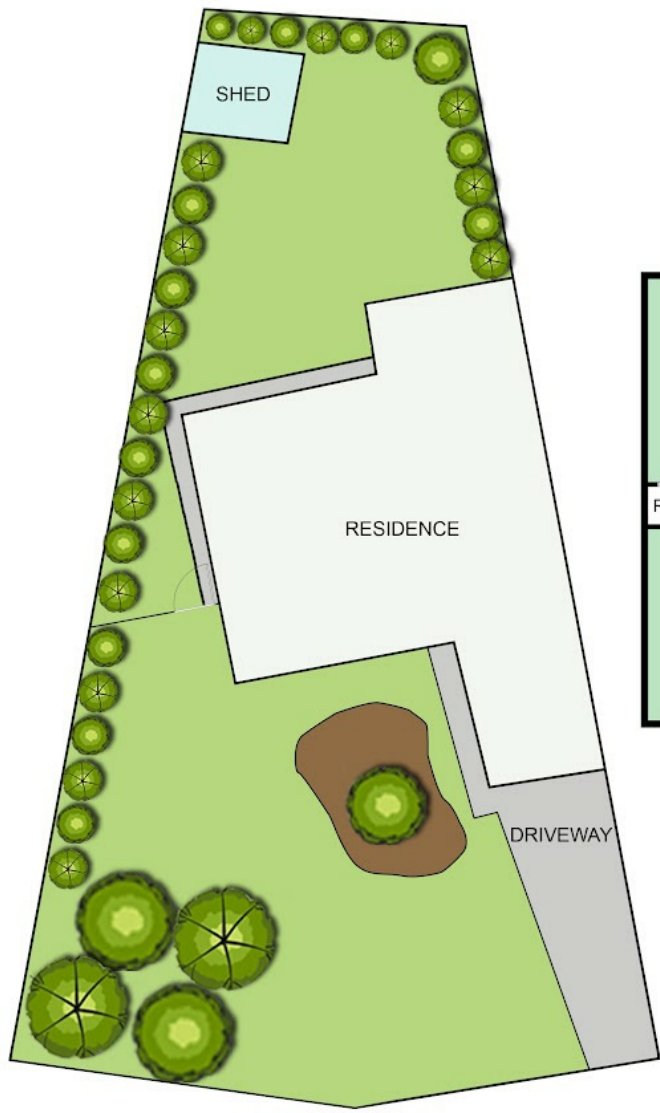

SITE PLAN



FLOOR PLAN

Disclaimer: Please note this floor plan is for marketing purposes and is to be used as a guide only. All dimensions are estimates only and may not be exact measurements.

All buyers must do their own investigations into the accuracy of these plans.

2/4 Gable Street, Oxenford
 Tony Brown
 0418961500
 tonybrown@atrealty.com.au
 www.atrealty.com.au

