

SOLD

MANTRA ON SALT BEACH - ONE BEDROOM TOP FLOOR APARTMENT

Discover Your Beachside Lifestyle Opportunity
Mantra on Salt - Top Floor Location – Water to Mountain Views

Escape to Kingscliff on the Tweed Coast for a lifestyle investment located only steps away from the pristine sands of Salt Beach Mantra Resort with magnificent Top Floor panoramic views. Unwind in this One bedroom fully self contained apartment which offers the best for a holiday lifestyle or solid investment.

Light and bright living spaces with spectacular views

This apartment is located in a quite position accessible by lift from the underground carpark . Positioned top floor with fully equipped kitchen , open living space , privacy shutters and extensive outdoor veranda with ocean glimpses and magnificent mountain views to Mt Warning. King size master bedroom with direct balcony access.

Resort Amenities

Take advantage of the resort's extensive facilities including a sprawling lagoon pool with bar service, soothing spas , gym, bike hire and tennis courts . Plus you're just a short stroll to the local Saltbar and renowned restaurants Fins , Mashuri Thai, La Barrita and Italian Kitchen & Bar Giulia plus stylish boutiques. The walking and cycle tracks connect at your front door to the surfing hub of Cabarita Beach and Kingscliff Beach. Immaculately maintained gardens and BBQ facility.

Fantastic Rental Returns Potential

This well located apartment presents a diversified opportunity for the astute investor to secure a stable investment with excellent holiday rental returns and the opportunity to plan your holiday getaways each year. Currently Accor managed.

Location Location Location !!

- Direct Beach access
- Top Floor Views
- Gold Coast Airport is 15 minutes drive ,
- Byron Bay 40 Minutes drive ,
- Ballina airport 55 minutes
- Brisbane a 75 minute drive

1 BED | 1 BATH | 1 CAR

PRICE:
\$440,000

OPEN FOR INSPECTION:
N/A



Mark Humphries
0411989772
markh@atrealty.com.au
www.atrealty.com.au

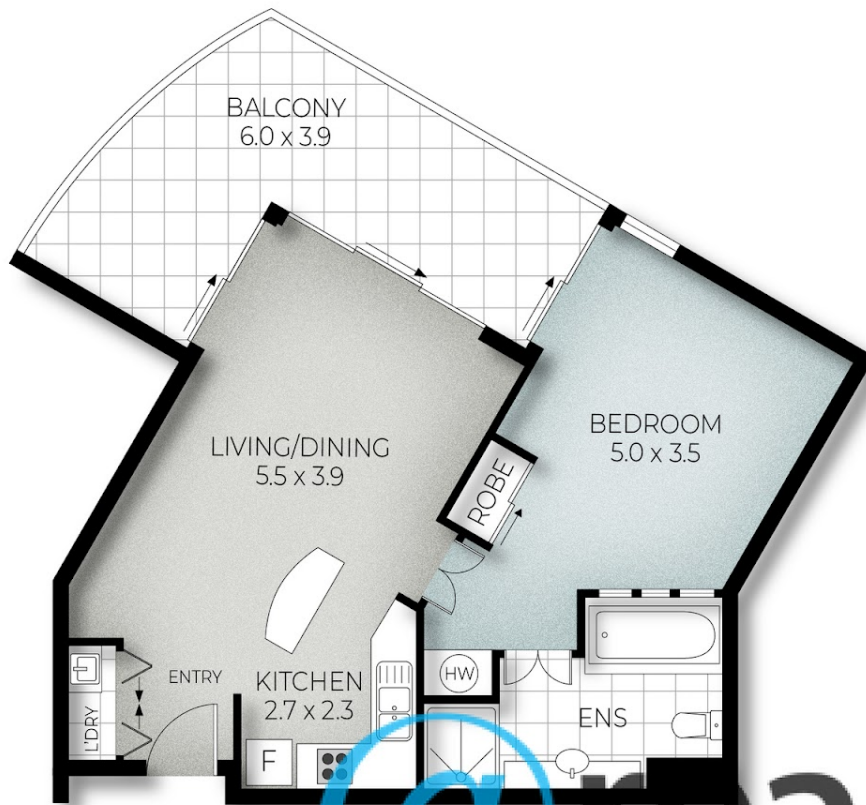

Plans are indicative only. Dimensions are approximate. All information contained herein is gathered from sources we believe to be reliable. However, we cannot guarantee its accuracy and interested persons should rely on their own enquiries

6306 / 9 GUNNAMATTA DRIVE, KINGSCLIFF

Internal: 58 m² | External: 17 m² | Total: 75 m²

Disclaimer: Please note this floor plan is for marketing purposes and is to be used as a guide only. All dimensions are estimates only and may not be exact measurements.