



SOLD

260SQM INVERLOCH SEACHANGE

Embrace the ultimate seachange lifestyle in this exceptional 3-bedroom, 2-bathroom residence, thoughtfully designed for those seeking refined comfort, convenience, and coastal charm. With an impressive 260 square metres of internal living space, this meticulously crafted home offers the perfect blend of luxury and practicality. For more detailed information on this property visit www.59woodlandheath.com

Designed for Effortless Living

Soaring high ceilings and an intelligently designed floor plan create an atmosphere of spacious elegance throughout. The generous open-plan living area flows seamlessly to a large undercover entertaining area—ideal for hosting family gatherings or intimate dinner parties with friends old and new.

The heart of the home features a stunning kitchen with waterfall stone island, perfect for those who appreciate quality and enjoy entertaining. An additional office space offers flexibility as a quiet retreat for reading or hobbies, and could easily be converted to a fourth bedroom for visiting family and grandchildren.

Storage and Convenience Redefined

The oversized drive-through garage accommodates multiple vehicles with ease, while the substantial 10x5 metre shed provides exceptional storage for recreational equipment, workshop space, or seasonal items—perfect for pursuing new interests and maintaining cherished hobbies.

Location Excellence

Positioned in prestigious Woodland Heath Drive, this home boasts an exceptional walk score, placing Inverloch's boutique shops, cafes, pristine beaches, and scenic walking trails within comfortable reach. Enjoy the freedom of strolling to daily amenities while living in one of the area's most sought-after neighbourhoods.

Your Low-Maintenance Haven

3 BED | 2 BATH | 3 CAR

PRICE:
\$997,500

OPEN FOR INSPECTION:
N/A



Leo Edwards
0472523445
leo@atrealty.com.au
www.atrealty.com.au

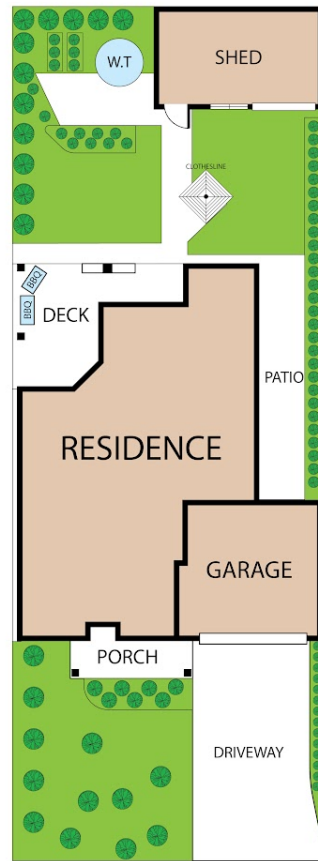
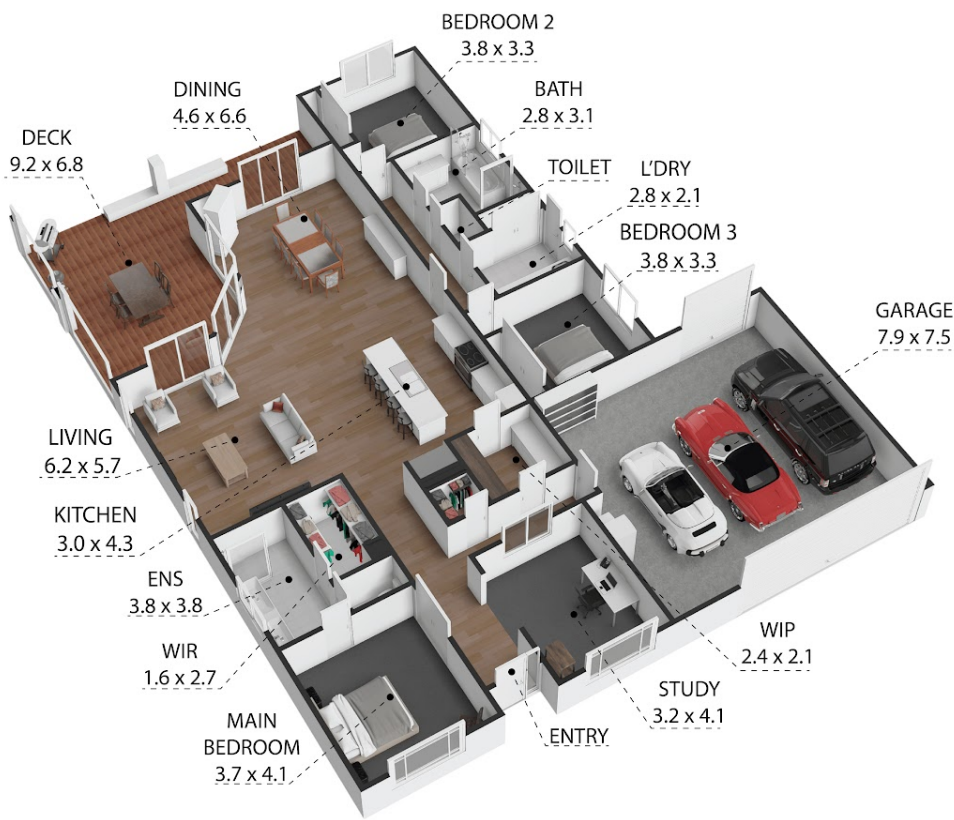

59 Woodland Heath Drive, Inverloch, VIC, 3996

TOTAL APPROX. FLOOR AREA 260 SQ.M

Whilst every attempt has been made to ensure the accuracy of the floor plan contained here, measurements of doors, windows, rooms and any other items are approximate and no responsibility is taken for any error, omission, or misstatement. This plan is for illustrative purposes only and should be used as such by any prospective purchaser.

INVERLOCH
EST. 1988

@realty

Disclaimer: Please note this floor plan is for marketing purposes and is to be used as a guide only. All dimensions are estimates only and may not be exact measurements.

Leo Edwards
0472523445
leo@atrealty.com.au
www.atrealty.com.au

@realty