

# FOR SALE

## THE HEDONISTIC 1980S!

### Shore | Countdown

Absolutely all offers presented by 5pm Wednesday December 10th.  
(Seller reserves the right to sell prior). WILL BE SOLD.

### The Hedonistic 1980s!

Grand Mediterranean Masterpiece by La Villa Homes  
With Hilltop Ocean Views

This home would've been the most exciting thing going around during its construction in the peak of the heady 1980s and is the type of home that personified this suburb at the time!

Perched high on the hill, with tremendous ocean views, this colossal, architecturally significant home, built over three levels was constructed with the very best of everything.

A grand curved external stairway guides you to the front door and allows you to mentally transition from the street as you take in the homes inspiring presence. Sweeping, surround verandas capture the ocean views. Leone Spiccia inspired "wheel house" corner windows which drew their inspiration from the crayfishing fleets running in and out of Fremantle, demand your attention. This is a bold, confident and exciting power home.

Internally the home is warm and inviting. Double storey voids greet you on entry. The living areas and the bedrooms are all generous in size. There are open fireplaces fitted with convenient gas logs on both floors.

All living areas flow onto ocean view balconies to the west and all-weather protected pool gardens to the east, such that the architecture naturally draws you in to an indoor outdoors lifestyle habitually.

The parquet floors under foot still add warmth and have design relevance to this day, as to do the authentic imported European terracotta floor tiles. The kitchen is fitted with Gaggenau appliances.

There is a grand internal staircase with timber balustrades. There is a double garage which has a gym alongside it (which is exactly the same size as a third garage) +2 adjacent storerooms,

4 BED | 3 BATH | 2 CAR

### PRICE:

Shore | Countdown All Offers by Dec 10

### OPEN FOR INSPECTION:

N/A



**Scott Swingler**

**0403344649**

[scott@shore-property.com.au](mailto:scott@shore-property.com.au)

Shore Property

# Approximate Areas:

Ground Floor	204 m <sup>2</sup>
First Floor	186 m <sup>2</sup>
Store	16 m <sup>2</sup>
Balcony A	13 m <sup>2</sup>
Balcony B	13 m <sup>2</sup>
Garage	51 m <sup>2</sup>
Porch	16 m <sup>2</sup>
Workshop	19 m <sup>2</sup>

**Total 518 m<sup>2</sup>**

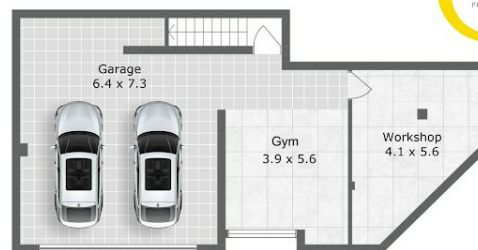
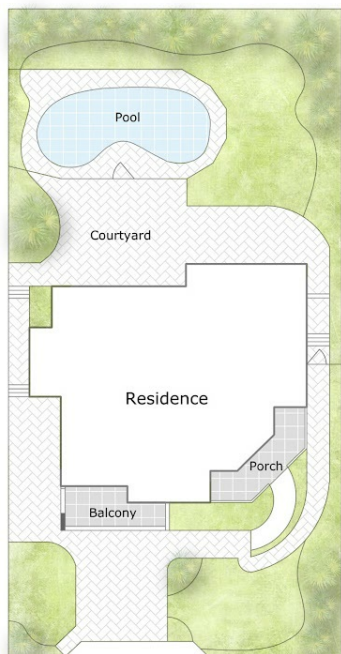

Lower Floor



First Floor



FINESSE

## 46 Kinkuna Way, City Beach WA 6015

Care has been taken to ensure the accuracy of this floor/site plan, however all dimensions and areas should be considered as approximate. It has been produced as a guide for the purpose of the property sale or lease only. No credit is taken for the original building or landscape design. This floor plan/site plan design is subject to strict copyright and should not be reproduced, copied or altered without prior consent. The Agent, Vendor & Finesse Photography will not be held liable or responsible for any error, omission, misstatement or use of any data shown on this plan.

Disclaimer: Please note this floor plan is for marketing purposes and is to be used as a guide only. All dimensions are estimates only and may not be exact measurements.