



# SOLD

## TENANTED 3-BEDROOM HOME IN PRIME LOCATION

Unit 64/69 Boulter Road, Berrimah, is currently tenanted with a lease in place that cannot be ended early, making it a secure investment option from day one. Set in a well-kept complex, this low-maintenance property combines modern features with a central location, appealing to investors, professionals, and families seeking convenience and accessibility.

Enjoy the benefits of a private residence with shared amenities including a grassed communal park, shaded seating areas, and a BBQ space for relaxed weekends. With Northlakes Shopping Centre, local schools, shops, and Darwin International Airport just minutes away, everything you need is within easy reach.

### Property Highlights:

- 3 large bedrooms with built-in robes
- 2 bathrooms, including en-suite to the main bedroom
- Open-plan living and dining area
- Modern kitchen with stone benchtops
- Air-conditioned throughout, NBN ready
- Internal laundry and ample storage
- Small private yard for low-maintenance outdoor living
- 1 carport space, plus room for a small vehicle
- Park/Playground on the vacant land under Olive Avenue

Whether you're looking to move in or invest, this property ticks all the boxes for comfort, style, and convenience. Don't miss your opportunity to secure a smart buy in a growing area.

### Additional Information:

- Year Built: 2014
- Status: Tenanted – ideal for investors seeking immediate rental income
- Current Rent: \$630 per week
- Lease Ending: 27/05/2026
- Body Corp Manager: North Management
- Total Body Corporate Fees (approx.): \$1,075 per quarter (admin fund approx \$1,010 pq + sinking fund approx \$65 pq)

3 BED | 2 BATH | 1 CAR

PRICE:  
\$460,000

OPEN FOR INSPECTION:  
N/A



**Nicole Wheeler**  
0417508800  
nicolewheeler@atrealty.com.au  
[www.atrealty.com.au](http://www.atrealty.com.au)

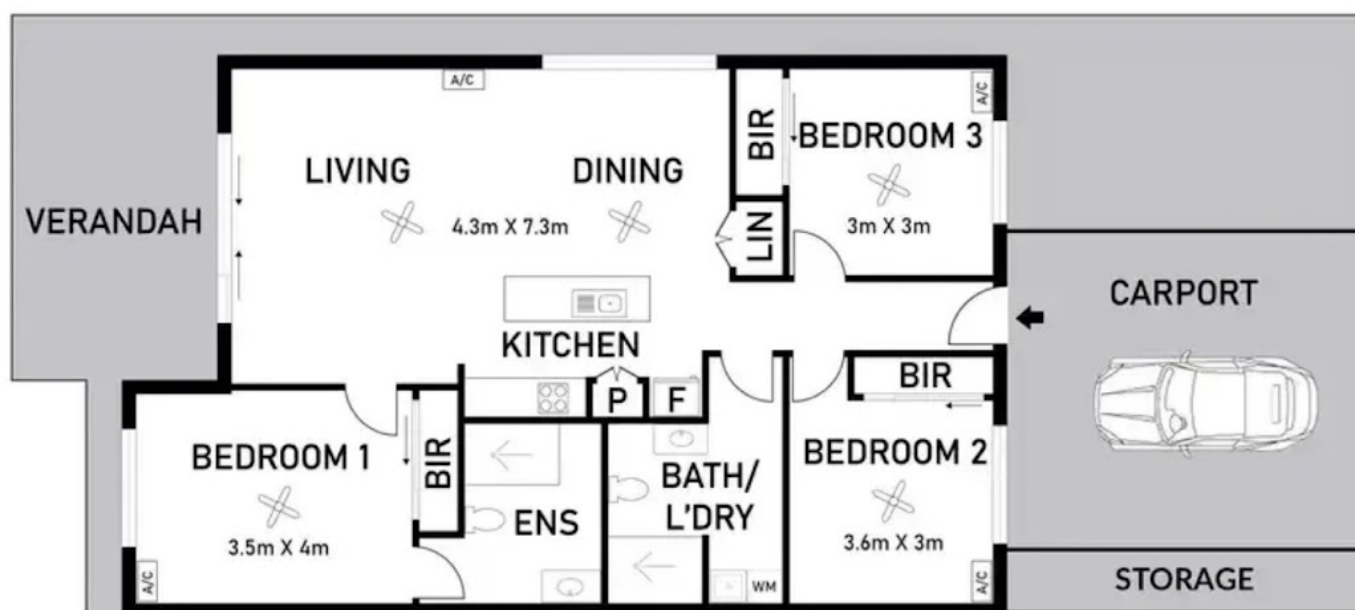

## 64/69 BOULTER ROAD BERRIMAH NT 0828

Disclaimer: Please note this floor plan is for marketing purposes and is to be used as a guide only. All dimensions are estimates only and may not be exact measurements.