

# FOR SALE

## OCEANFRONT SOUTH CITY BEACH WITH PRIVATE GARDEN GATE ONTO DUNES

Brand New ~887sqm Architectural Residence

Huge 840sqm Oceanfront Landholding

Private Garden Gate Onto Coastal Dunes

Shore | By Negotiation

\*Currently Negotiating...So Be Quick!!!  
WILL BE SOLD.

Architect / Designer :  
Neil Salvia

Builder :  
Brian Gray

Interior Design:  
Moda Interiors

- The first brand-new property to come onto the market on the South City Beach waterfront in around 20 years
- One of only four landholdings of the 27 on the front row that are big enough to build a house of this size and scale
- The big landholding enabled the home to be designed in a U shape so that you did not see any neighbours and all windows are focused on the central cascading network of pool and spas and the ocean beyond.
- The second closest home on the oceanfront strip of 27, to the highly sought after and tightly held groyned and cafe precinct

5 BED | 5 BATH | 8 CAR

PRICE:

Shore | By Negotiation Offers

OPEN FOR INSPECTION:

N/A



**Scott Swingler**

**0403344649**

scott@shore-property.com.au

Shore Property

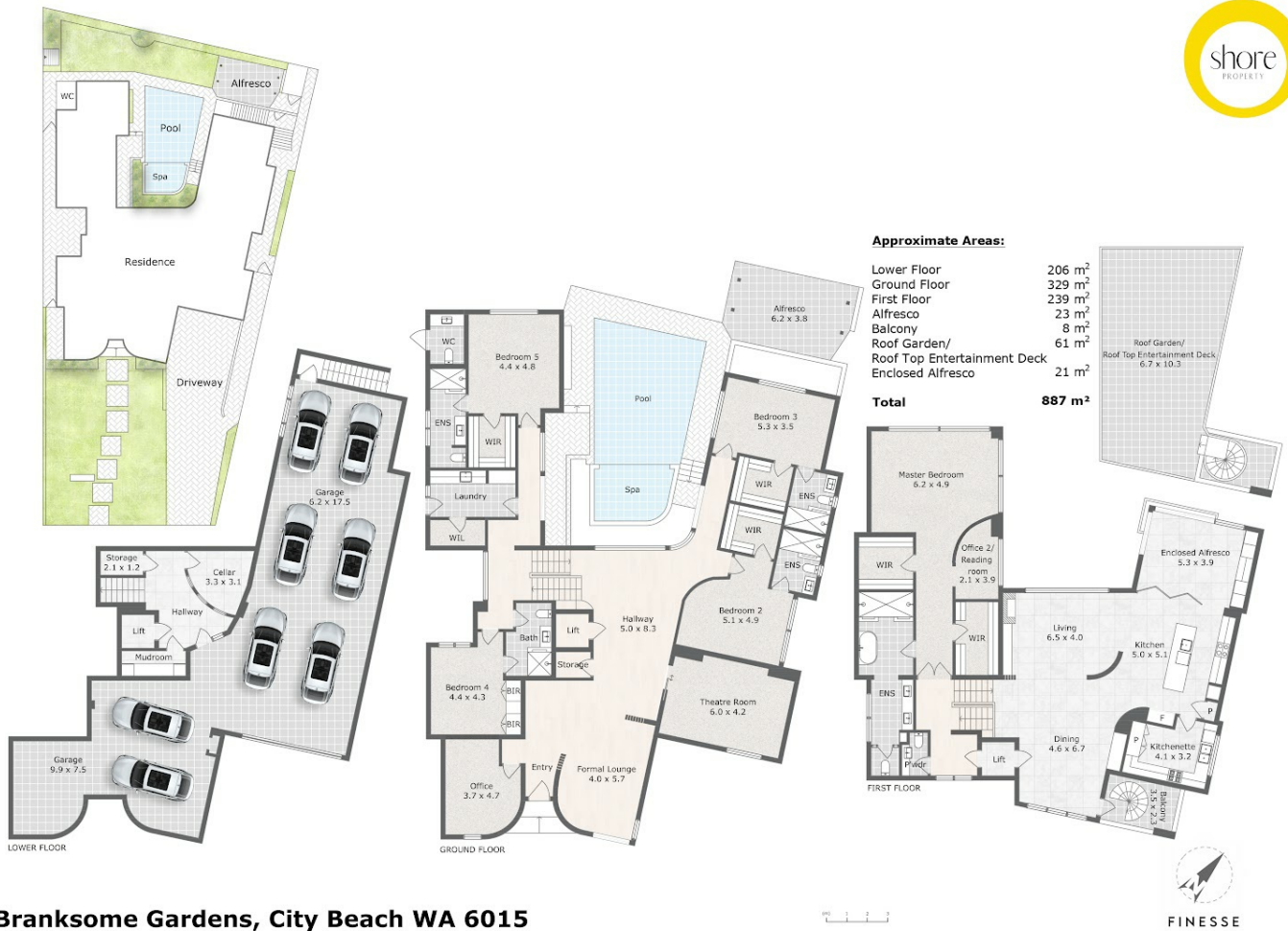

## 16 Branksome Gardens, City Beach WA 6015

Care has been taken to ensure the accuracy of this floor/site plan, however all dimensions and areas should be considered as approximate. It has been produced as a guide for the purpose of the property sale or lease only. No credit is taken for the original building or landscape design. This floor plan/site plan design is subject to strict copyright and should not be reproduced, copied or altered without prior consent. The Agent, Vendor & Finesse Photography will not be held liable or responsible for any error, omission, misstatement or use of any data shown on this plan.

Disclaimer: Please note this floor plan is for marketing purposes and is to be used as a guide only. All dimensions are estimates only and may not be exact measurements.