



SOLD

MODERN FAMILY LIVING IN PRIME TARNEIT LOCATION

Welcome to 6 Isla Street, Tarneit – a beautifully designed 25.6-square (approx.) home that seamlessly blends comfort, style, and convenience. Perfectly positioned in one of Tarneit's most sought-after pockets, this spacious residence boasts quality finishes, multiple upgrades, and proximity to a wide range of future lifestyle amenities.

Step inside and you'll be greeted by:

Elegant pendant lights, chandeliers, plantation shutters, and designer downlights, creating a warm, modern ambience

A chef-inspired kitchen featuring an extended stone island benchtop, 900mm stainless steel appliances, dishwasher, and a spacious walk-in pantry – perfect for those who love cooking and entertaining

Stylish feature walls and curtains, adding a contemporary designer touch throughout the home

Year-round comfort with ducted heating, solar-powered split air conditioners (x2), and energy-saving solar panels

Outdoor Features:

An inviting alfresco area ideal for entertaining

Low-maintenance front and backyard with concrete pathways throughout

All set on a 14-metre wide frontage, enhancing street appeal and space

Location Highlights:

Walking distance to the upcoming Grove Shopping Centre

Only 2 minutes to Davis Creek Primary School, Islamic College of Melbourne, and the Grand

4 BED | 2 BATH | 2 CAR

PRICE:
\$685,000

OPEN FOR INSPECTION:
N/A



Mickey Grover
0450168887
mickeygrover@atrealty.com.au
www.atrealty.com.au

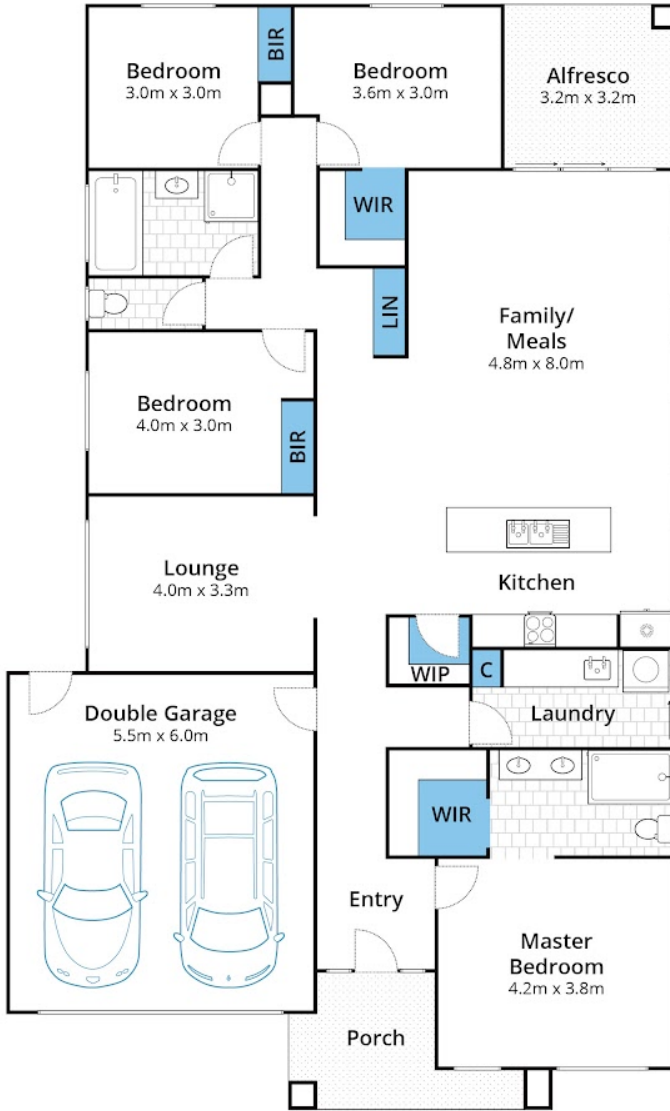

Floor Plan

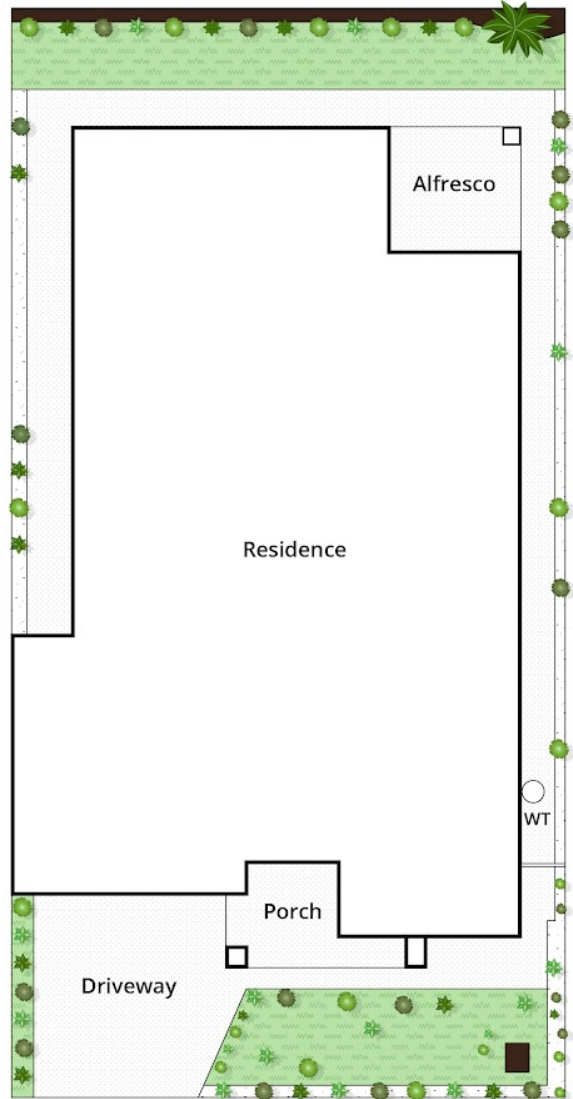

Site Plan

Disclaimer: Please note this floor plan is for marketing purposes and is to be used as a guide only. All dimensions are estimates only and may not be exact measurements.

6 ISIA Street, Tarnait

Mickey Grover
0450168887
mickeygrover@atrealty.com.au
www.atrealty.com.au

