

40 FIELD ROAD, WOODSTOCK, QLD, 4816



# FOR SALE

## 11 ACRES OF RURAL LIVING WOODSTOCK

Situated in the Woodstock area this prime 4.41ha (11 acres) is probably one of the last blocks left for sale in this area. The property has a 20m x 18m shed with a block 2 bedroom home inside. The home consists of 2 bedrooms, storeroom, bathroom and open plan kitchen/dining room. Covered Patio at back with laundry. Power & water both connected. No one has lived here for a while and the home needs a fair bit of TLC but is solid. Maybe live here while you build a new home.

Boundary fenced, plus a couple of paddocks. Mostly cleared. Bitumen road access. 2 bores, power, old stables, hen house and cow shed.

A country lifestyle just waiting for you to make your home.

Maybe a horse, a cow and the kangaroos are already here. Living that rural dream. This area is a tightly held area where properties like this seldom come on the market. Be quick and you can own one.

This property is at Woodstock with Primary School and Pony Club/Sports Club. The Renovated Woodstock Roadhouse is nearing completion. High School children commute by bus to Townsville. Everything Townsville has to offer Shopping Centers etc. are only approx. 30 minutes away.

A great opportunity to secure a rural property before they all run out.

Price: \$550,000

2 BED | 1 BATH | 4 CAR

PRICE:  
\$550,000

OPEN FOR INSPECTION:  
N/A



**Ken Entriken**  
0419689498

kenentriken@atrealty.com.au

[www.atrealty.com.au](http://www.atrealty.com.au)

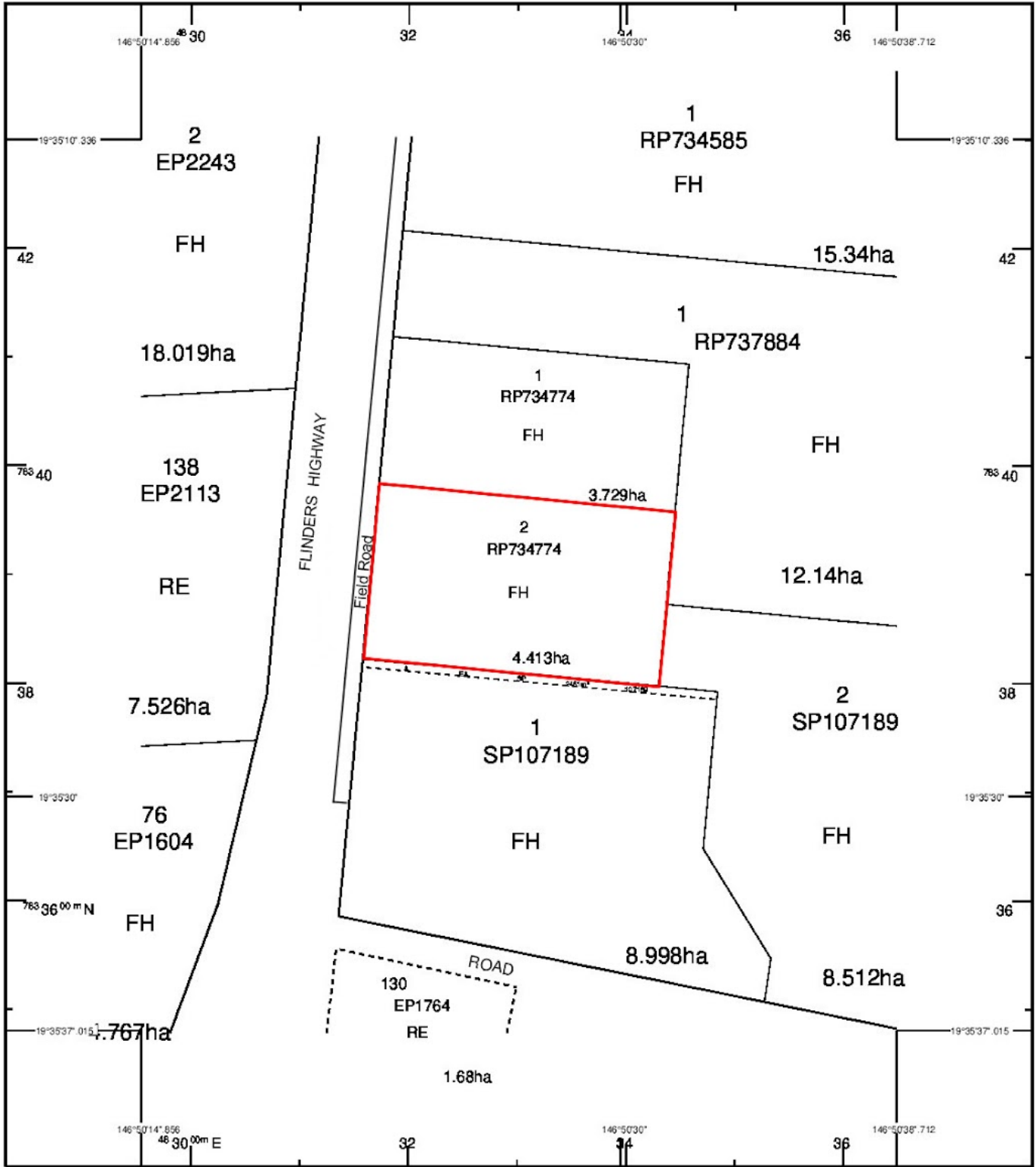

STANDARD MAP NUMBER  
8258-14242

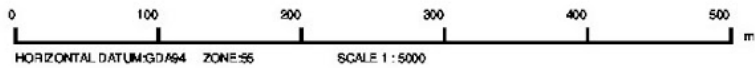

**SmartMap**  
An External Product of  
SmartMap Information Services  
Based upon an extraction from the  
Digital Cadastral Data Base

MAP WINDOW POSITION & NEAREST LOCATION  
146°50'14" E 856  
19°35'10" S 336  
030 M

SUBJECT PARCEL DESCRIPTION

DCDB  
Lot/Plan 2/RP734774  
Area/Volume 4.413ha

CLIENT SERVICE STANDARDS

PRINTED 30/09/2025

Disclaimer: Please note this floor plan is for marketing purposes and is to be used as a guide only. All dimensions are estimates only and may not be exact measurements.

**Ken Triken**  
0419689498  
kenetriken@atrealty.com.au  
www.atrealty.com.au

Despite Department of Resources best efforts, RESOURCES makes no representations or warranties in relation to the information, and, to the extent permitted by law, exclude or limit all warranties relating to correctness, accuracy, reliability, completeness or currency and all liability for any direct, indirect and consequential costs, losses, damages and expenses incurred in any way (including but not limited to that arising from negligence) in connection with any use of or reliance on the information.  
For further information on SmartMap products visit  
<https://www.qld.gov.au/hauling/buying-owning-home/property-land-valuations/smartmap>

Queensland Government  
(c) The State of Queensland,  
(Department of Resources) 2025  
**@realty**