



SOLD

LUXURY 419M² FAMILY LIVING – FORMER METRICON DISPLAY HOME IN PACIFIC PINES

A Metricon Masterpiece in a Premier Location

Experience the perfect fusion of design excellence, comfort, and sophistication in this exceptional ex-Metricon display home, ideally positioned in one of Pacific Pines' most sought-after locations. Offering an expansive 419m² of luxury living, this architecturally crafted residence promises an unrivalled lifestyle for the modern family.

From the moment you arrive, the home's commanding street appeal, striking façade, and immaculate landscaping set a tone of understated elegance. Step inside to discover a thoughtfully designed floorplan where every detail has been curated for quality, function, and contemporary style.

Key Features

Spacious luxury across two levels, with multiple living zones designed for modern family living and effortless entertaining

Five generous bedrooms, including a palatial master suite with a walk-in robe and a beautifully appointed ensuite

Gourmet designer kitchen featuring premium stone benchtops, a large island breakfast bar, quality appliances, and a walk-in pantry — the true heart of the home

Open-plan living and dining areas seamlessly connecting to the outdoor alfresco for year-round entertaining

Multiple versatile spaces including a separate media room, upstairs retreat, and a dedicated study/home office (or optional fifth bedroom)

High ceilings, natural light, and modern finishes that enhance a sense of space and luxury throughout

5 BED | 3 BATH | 2 CAR

PRICE:
\$1,805,000

OPEN FOR INSPECTION:
N/A



Tony Brown
0418961500
tonybrown@atrealty.com.au
www.atrealty.com.au



GROUND FLOOR

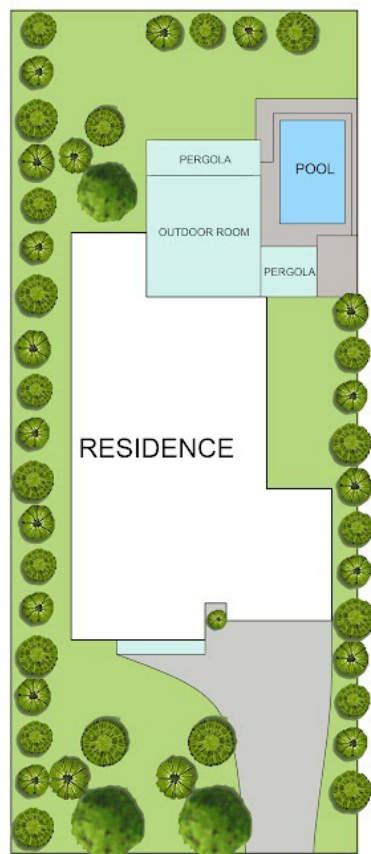

SITE PLAN



Disclaimer: Please note this floor plan is for marketing purposes and is to be used as a guide only. All dimensions are estimates only and may not be exact measurements.

All buyers must do their own investigations into the accuracy of these plans.

3 Laughlen Chase, Pacific Pines