



SOLD

MOVE IN FOR CHRISTMAS!!

This modern, 3 bedroom home is new to the market and offering, low maintenance, coastal living in a prime location. With the main bedroom having the all essential ensuite and walk in robe and being to the opposite end of the home to the other 2 bedrooms, the added privacy is a bonus. The main bathroom is centrally located to bedrooms 2 and 3 and have a separate shower to bath and both bedrooms have built in robes. The home is fully airconditioned with security screen doors, open plan living, brekky bar, large gas cooker, dishwasher and pantry. All bedrooms have vinyl planking and the living is tiled throughout for cooler everyday comfort. Double, remote control lock up garage, Single bay Shed with drive through access, loads of room for a pool next to the outdoor entertaining and it's all situated on a fully fenced 662m2 allotment at the end of a nice cul de sac surrounded by quality homes. Close to schools, bus stops, shopping centres, restaurants, medical centres and the Beach. Please call Jodie for a private viewing 0407 211322.

Rates: \$2,028.57 per half year
Water: \$106.08 per half year
Estimated Rental Return: \$750 to \$800 p/w

Disclaimer: All information has been obtained from the seller. The agent/s cannot verify its accuracy and do not give any warranty as to errors or omissions, if any, in these particulars. Prospective purchasers should satisfy themselves by inspection and making their own inquiries or otherwise as to the accuracy of the particulars. Location shots and use of furniture (real or virtual) are for visual display purposes only and not included in sale. Grass has been enhanced for visual appeal. We are not financial advisors or deem to provide financial advice and urge all prospective purchasers to make their own inquiry into funding available.

3 BED | 2 BATH | 3 CAR

PRICE:
\$720,000

OPEN FOR INSPECTION:
N/A



Jodie Cowin
0407211322
jodiecowin@atrealty.com.au
www.atrealty.com.au

166.48 m²
 58.3 l/m
 23.0m²
 5.7 l/m
 11.2m²

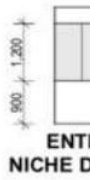
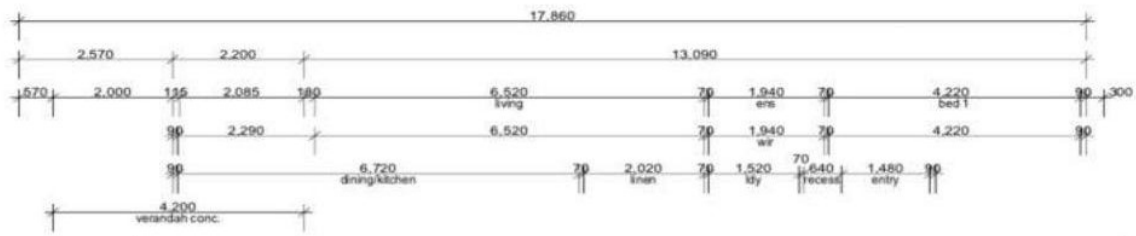

ENTRANCE NICHE D

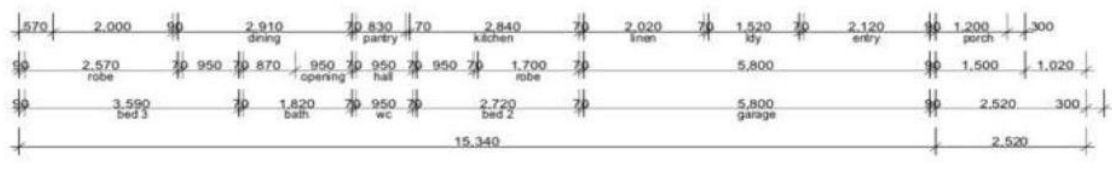
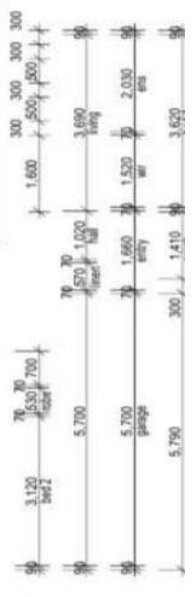
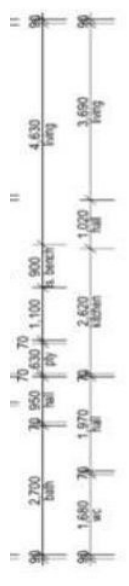

TRACT
 07/1



Disclaimer: Please note this floor plan is for marketing purposes and is to be used as a guide only. All dimensions are estimates only and may not be exact measurements.

Jodie Cowin
 0407211322
 jodicowin@atrealty.com.au
 www.atrealty.com.au

