



# FOR SALE

## LIFESTYLE/INCOME - 3 TITLES - 4 BEDS-2 BATHS - 490 ACRES CATTLE PROPERTY.

PRICE REDUCED - Owners committed elsewhere and looking for offers. \$1,850,000 ONO

“Sandy Creek” is located at the end of Lagoon Road, (part sealed and part gravel) West Coraki, with no through traffic, providing total privacy and seclusion, but is close to many key destinations:

- 10 mins to the pretty Riverside Village of Coraki.
- 30 mins to the picturesque beachside town of Evans Head, offering pristine beaches, restaurants etc.
- 30 mins to Lismore / Casino with hospitals, schools, shopping centres etc .
- 10 mins Coraki to the M1.
- 35 mins Coraki to Ballina/Byron Airport.
- 50 mins Coraki to both Byron Bay and Yamba respectively.

“Sandy Creek” is situated in the beautiful Northern Rivers on 198.5 HA (490 acres) of undulating to flat established cattle country. There is natural and unspoilt creek frontage that has numerous wildlife species and amazing birdlife, fauna and flora with various horse trails.

There are 3 dams, one being spring fed and over 2 kms of creek running through the property plus 5 troughs throughout the property. Currently running 55 breeders plus 19 weaners, however, “Sandy Creek” has the capacity with further pasture improvement and clearing to run up to 100+ breeders.

There are 9 paddocks with good fencing and laneways leading to a solid set of cattle yards, with near new crush, head bale and neck scoop. There are 5 concrete gravity fed troughs and a new 22,000L poly header tank. The entire 490 acres is stock proof with mostly 4 and 5 barb fencing in very good to good condition (some new concrete new fencing on the northern boundary) backed up with electric fencing along “Sandy Creek”.

Beautiful gardens greet you on entry to the home with an established rose garden and pretty bougainvillea. The wide stairs lead to the charming country style, open plan home.

Some of the features are:

- Newly oiled verandah with views over the property, sit back and enjoy with a cold beverage.

4 BED | 2 BATH | 6 CAR

PRICE:  
\$1,850,000

OPEN FOR INSPECTION:  
N/A



**Murgha Mack**  
**0414666970**  
murghamack@atrealty.com.au  
[www.atrealty.com.au](http://www.atrealty.com.au)

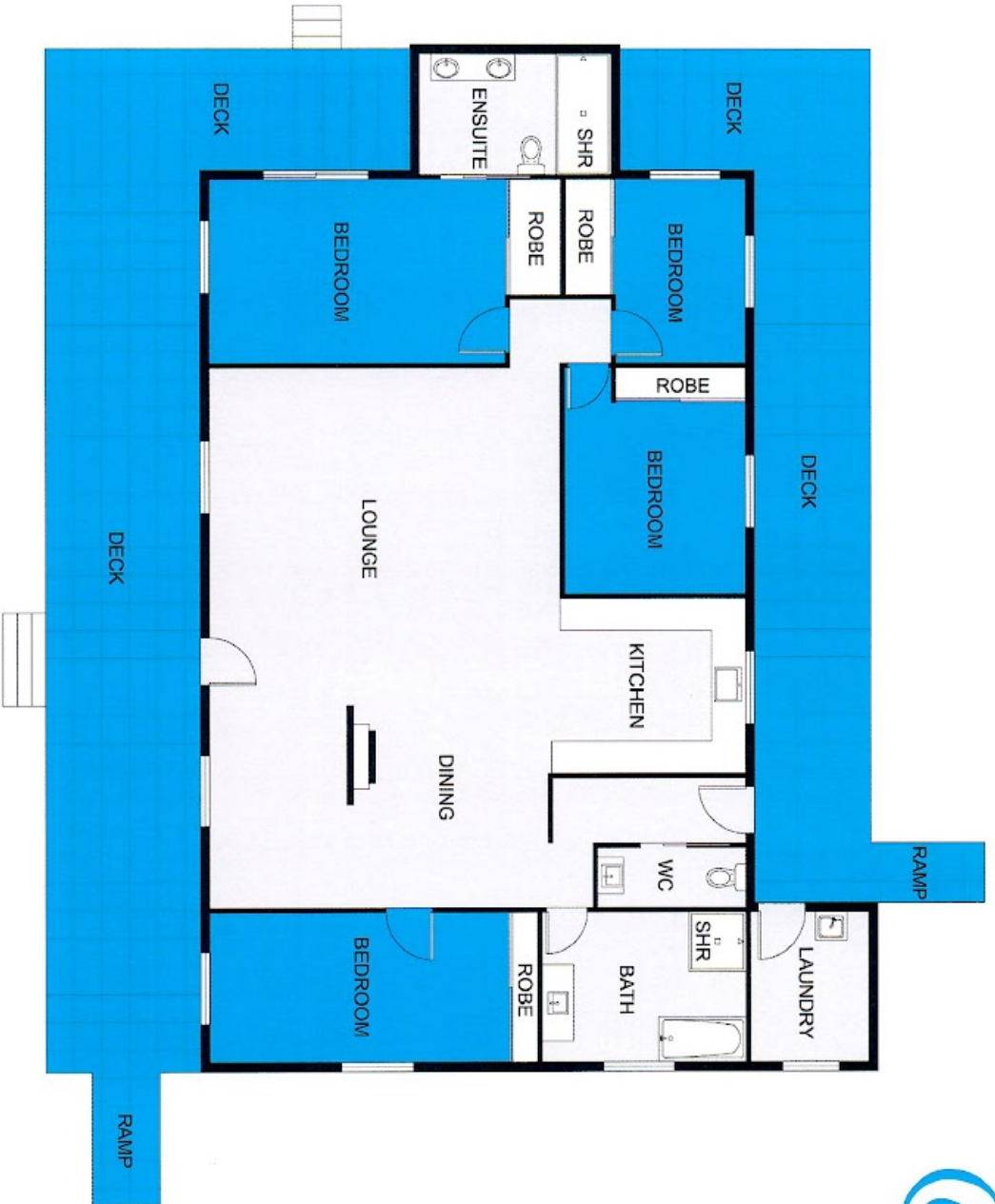

## FLOOR PLAN

This floor plan including furniture, fixture measurements and dimensions are approximate and for illustrative purposes only.  
@areal gives no guarantee, warranty or representation as to the accuracy and layout.  
All enquiries must be directed to the agent, vendor or party representing this floor plan.

Disclaimer: Please note this floor plan is for marketing purposes and is to be used as a guide only. All dimensions are estimates only and may not be exact measurements.

