



## FOR SALE

### SPACIOUS COUNTRY LIVING WITH ENDLESS POTENTIAL

Welcome to a rare opportunity in the peaceful Glenwood community. This generous 16,147m<sup>2</sup> (approx. 4 acres) parcel offers space, privacy and rural lifestyle appeal, just minutes from local services, scenic highways and a nearby state school. Positioned near the end of a no-through road, the property enjoys extremely limited passing traffic, enhancing the sense of quiet and seclusion. The solid three bedroom, two bathroom home strikes a perfect balance between relaxed country living and everyday practicality, ideal for families, investors or lifestyle buyers seeking acreage without sacrificing convenience.

Step inside to discover comfortable living spaces that flow effortlessly between the living areas, bedrooms and outdoors, all designed to capture natural light, cooling country breezes and expansive views across the property. The main bathroom features a spa bath, adding a touch of comfort and relaxation. Beneath the home, a large undercover area provides excellent usable space for storage or future possibilities.

Outdoors is where this property truly shines. The wide-open grounds offer ample room for animals, kids and gardens. A dam equipped with Honda pump supports practical rural living, and ample tank water is connected to both the house and the shed, ensuring reliable water supply year-round. The impressive 3-bay lock-up shed (6 x 9 metres) is ideal for vehicle storage, a workshop or accommodating the tools and toys that come with an acreage lifestyle. With plenty of room to expand, add infrastructure or further enhance the landscape, this property offers outstanding versatility.

With strong demand for lifestyle properties and Glenwood continuing to grow, this is a rare opportunity to secure peaceful country living with the future in mind. Whether you're seeking a family haven, a rural escape or a smart long-term investment, 422 Arborten Road is ready to welcome you home.

3 BED | 2 BATH | 2 CAR

PRICE:  
\$770,000

OPEN FOR INSPECTION:  
Apr 11 at 9:30am - 10:00am



**Sally Newman**  
0412780359  
sally.engeman@atrealty.com.au  
[www.atrealty.com.au](http://www.atrealty.com.au)

# 422 Arborten Rd Glenwood

422 Arborten Road, 4570 Glenwood, Queensland, AU  
 TOTAL AREA: 203.34 m<sup>2</sup> • LIVING AREA: 135.66 m<sup>2</sup> • FLOORS: 1

TOTAL AREA: 203.34 m<sup>2</sup> • LIVING AREA: 135.66 m<sup>2</sup> •

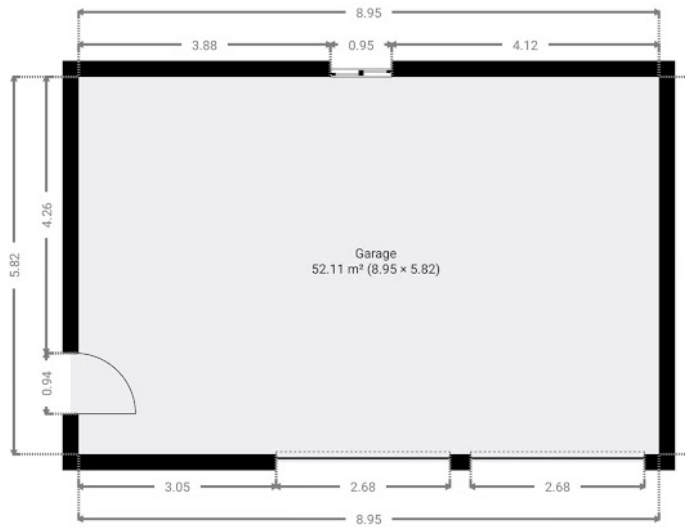

Disclaimer: Please note this floor plan is for marketing purposes and is to be used as a guide only. All dimensions are estimates only and may not be exact measurements.

THIS FLOORPLAN IS PROVIDED WITHOUT WARRANTY OF ANY KIND.

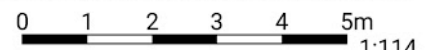

1:114