



SOLD

TWO HOMES IN ONE! - PERFECT FOR DUAL FAMILIES OR AN EXTRA LARGE CLAN

Nestled against the peaceful green surrounds of Reed Park, this extraordinary 8-bedroom family sanctuary at 89 Bong Bong Road presents a rare opportunity to secure a substantial home in one of Horsley's most convenient locations. This impressive residence combines generous proportions with thoughtful design, offering multiple living zones and endless possibilities for large / blended families, multi-generational living, or those seeking a lifestyle property with room to grow.

Both levels of this vast and intriguing residence provides two homes on the one block, complete with four bedrooms, kitchen, bathrooms and living on each storey.

The home's grand scale is immediately evident with a total of eight well-appointed bedrooms, including terrific storage with built-in-robos in seven of them, complemented by three bathrooms including a convenient ensuite off the main. At least three generous living areas provide flexible living zones to suit everyone. The heart of the home features modern conveniences in both the upper and lower level kitchens, including a dishwasher and gas cooking. Seasonal comfort is taken care of with four air conditioners throughout and there's even a lift to access both the top and bottom floor.

Step outside to discover your own private oasis, where the sparkling in-ground swimming pool takes centre stage in the fully fenced backyard, imagine the fun to be had! The outdoor entertainment area provides an undercover setting for Bbq's and alfresco dining, while the huge shed is ideal for the handy person, man cave, all weather play space or a fabulous storage option. Secure parking is never a concern with a remote triple garage accommodating several vehicles or possibly the perfect space to set up a home business (STCA) with side entry access, complemented by further off street parking in the wide driveway.

This property has all bases covered with disability access from the front ramp and also the internal lift to reach the top level.

With a sunny northerly aspect providing ample natural light, this treasured family home sits on a substantial 721 square metre block, offering space and privacy while maintaining the convenience of suburban living. Horsley's terrific location provides both easy access to all the natural beauty of the Illawarra region and urban amenities, making it an ideal base for families seeking the best of both worlds. You have the convenience of a bus stop practically next door,

8 BED | 3 BATH | 3 CAR

PRICE:
\$1,300,000

OPEN FOR INSPECTION:
N/A



Monique Headington
0412122293
mon@atrealty.com.au
www.atrealty.com.au

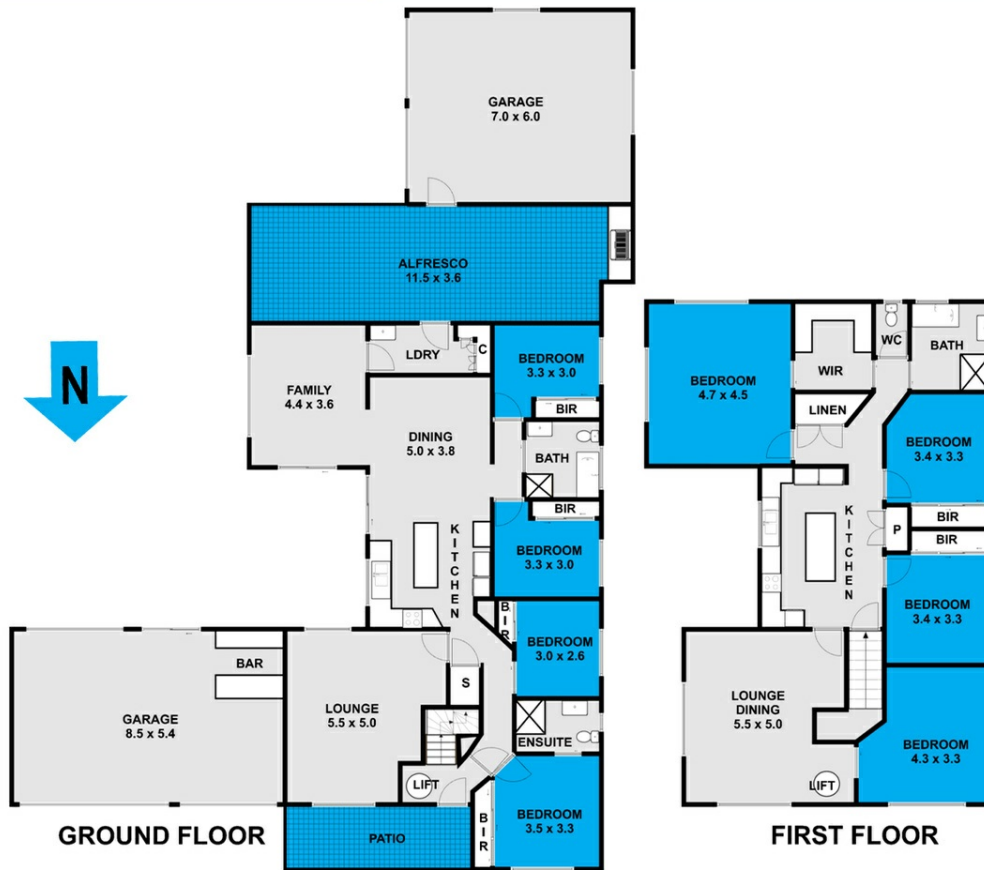

This floor plan including furniture, future measurements and dimensions are approximate and for illustrative purposes only.
@Realty gives no guarantee, warranty or representation as to the accuracy and layout.
All enquiries must be directed to the agent, vendor or party representing this floor plan.

89 Bong Bong Road Horsley

Disclaimer: Please note this floor plan is for marketing purposes and is to be used as a guide only. All dimensions are estimates only and may not be exact measurements.