



FOR SALE

1004M² HIGH BLOCK | DUAL LIVING FLOOD-FREE EOI MID- \$400,000S

1004m² HIGH BLOCK | DUAL LIVING | FLOOD-FREE | EXPRESSIONS OF INTEREST AROUND MID-\$400,000s

Perched high on the hill in sought-after East Innisfail, this grand and very solid two-storey residence is now ready for market.

Freshly painted inside and showcasing stunning polished timber floors, the home combines timeless character with exceptional space and versatility — all on a generous 1,004m² elevated corner block capturing cooling breezes and leafy views.

Constructed of solid external brick and block, this substantial property offers peace of mind, privacy, and absolute flood-free living just minutes from the CBD and scenic river walk. A spacious wrap-around verandah extends along two sides of the home, creating the perfect setting for entertaining, relaxing, or enjoying the elevated outlook.

Upstairs – Light-Filled Family Living

Beautiful freshly painted interiors with gleaming timber floors

- Open-plan living and dining filled with natural light
- Large family kitchen with abundant storage
- Three generous bedrooms with built-ins, fans & air-conditioning
- Family bathroom with separate toilet
- Expansive wrap-around verandah for outdoor living

Downstairs – Legal Height Dual Living

Legal height level with bedroom, office space and second bathroom

Ideal for extended family, teenagers, guests, or rental income
Perfect setup for a home business, studio, or consulting rooms

Additional Highlights

- Undercover parking for 2–3 vehicles plus boat or caravan space
- Large tiered block with room for pool, gardens, or shed
- Absolute flood-free elevated position
- Close to CBD, schools, cafes, library and beautiful river walk

4 BED | 2 BATH | 3 CAR

PRICE:

1004m² BLOCK DUAL LIVING
FLOOD-FREE MID-\$400,000s

OPEN FOR INSPECTION:

N/A



Jean Laterre

0437696969

jean.ccr@atrealty.com.au

www.atrealty.com.au



FIRST LEVEL



GROUND LEVEL

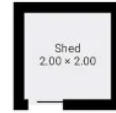

Disclaimer: Please note this floor plan is for marketing purposes and is to be used as a guide only. All dimensions are estimates only and may not be exact measurements.