



SOLD

607SQM NEXT GENERATION OPPORTUNITY - DUAL INCOME POTENTIAL

I am pleased to present a fantastic property opportunity in Strathpine. Positioned in a rapidly evolving pocket of Strathpine, this property presents an exciting opportunity for homeowners, investors and forward-thinking buyers seeking flexibility, income potential and future growth.

This highset home features an open plan living area, separate dining with reverse cycle air-conditioning, electric cooking appliances in the kitchen, and polished timber floors throughout. Three well-proportioned bedrooms, all with wardrobe cupboards. A substantial basement level, complete with laundry and existing plumbing. Single garage and a covered carport to the rear of the property.

Set on a generous 607sqm block with side access to the rear, the home offers scope to personalise or upgrade while also providing future development potential for those looking to maximise value. Subject to council approval, the property provides the opportunity to:

- Add a detached granny flat to the rear
- Convert the basement level into a flatette / self-contained living space
- Create multi-generational living arrangements
- Generate additional rental income streams
- Add long-term capital value through future improvements
- Ideal for extended family, home-based living, or investment strategies
- Located in a growth corridor close to schools, transport, and shopping

Situated within a Next Generation Neighbourhood planning precinct, this location benefits from the council's strategic vision for higher-quality residential development and ongoing infrastructure growth, making it an attractive prospect for investors and families alike.

Whether you're searching for a comfortable home, a bold renovation project, or a high-potential investment, this property delivers options rarely found in one package.

Flood zone and bushfire risks are not detected.
Rates - \$631 per qtr

3 BED | 1 BATH | 2 CAR

PRICE:
\$950,000

OPEN FOR INSPECTION:
N/A



Karen Moke
0406521370
karenmoke@atrealty.com.au
www.atrealty.com.au

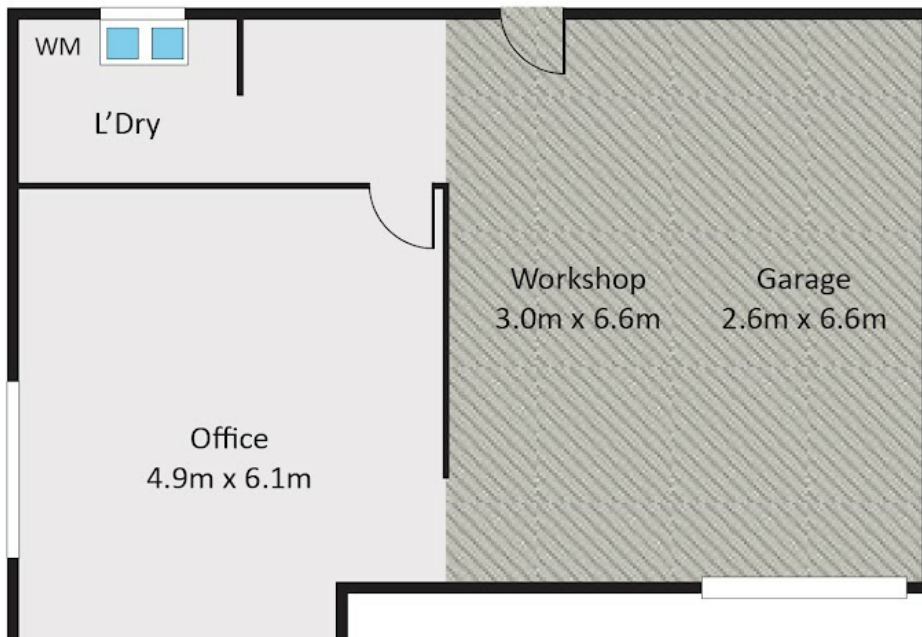

Disclaimer: Please note this floor plan is for marketing purposes and is to be used as a guide only. All dimensions are estimates only and may not be exact measurements.

