



SOLD

READY TO MOVE IN HARRIS BUILD 7.7 STAR

This isn't just sustainable living—it's intelligent living. This Adapt Design / Harris Build home represents next-generation residential design, where cutting-edge technology meets environmental responsibility to deliver a home that thinks ahead.

PERFORMANCE SPECIFICATIONS:

- 7.7-star energy rating - exceeding new national construction standards
- Maintains 18-25°C year-round with minimal active heating/cooling required
- 4.9kW solar system with battery-ready Fronius inverter for seamless energy storage expansion
- 10,000L rainwater harvesting

INTELLIGENT ENERGY MANAGEMENT:

Engineered like a precision instrument, this Wonthaggi home eliminates your three largest utility expenses. The sophisticated passive solar design captures and stores solar energy through insulated concrete floors and strategically positioned north-facing double glazing. Every detail—from orientation to insulation—works in harmony to create a naturally comfortable environment.

FUTURE-READY INFRASTRUCTURE:

- All-electric systems - no gas dependency, ready for renewable energy integration
- Battery-ready solar installation - easily expand to complete grid independence
- EV charging compatible - seamlessly integrate electric vehicle ownership
- Smart home ready - designed for modern connected living

THE ECONOMICS OF INNOVATION:

This home doesn't just reduce costs—it's designed to eliminate them. With no gas bills, minimal electricity costs, and potential solar feed-in revenue, you're looking at significant annual savings that compound over time. It's an investment in both lifestyle and financial freedom.

THE WONTHAGGI ADVANTAGE:

Location intelligence extends beyond the property boundary. Wonthaggi represents the evolution of coastal living—offering comprehensive urban amenities whilst maintaining genuine connection to nature and community.

Education & Family Infrastructure:

Wonthaggi Secondary College delivers excellent educational outcomes with modern facilities

3 BED | 2 BATH | 2 CAR

PRICE:
\$660,000

OPEN FOR INSPECTION:
N/A



Leo Edwards
0472523445
leo@atrealty.com.au
www.atrealty.com.au

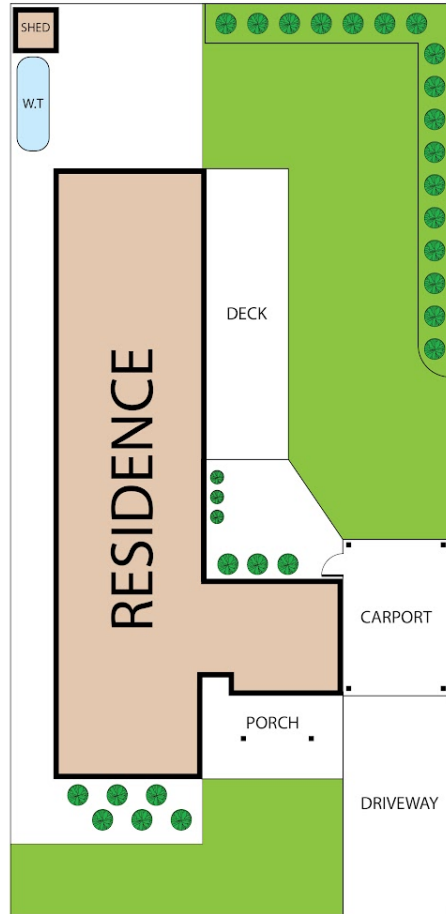
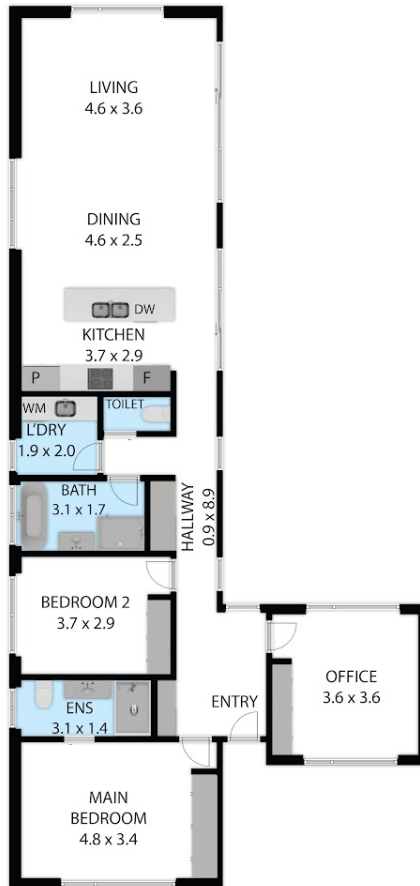

9 Lamp Road, North Wonthaggi, VIC, 3995

TOTAL APPROX. FLOOR AREA 121 SQ.M

Whilst every attempt has been made to ensure the accuracy of the floor plan contained here, measurements of doors, windows, rooms and any other items are approximate and no responsibility is taken for any error, omission, or misstatement. This plan is for illustrative purposes only and should be used as such by any prospective purchaser.



Disclaimer: Please note this floor plan is for marketing purposes and is to be used as a guide only. All dimensions are estimates only and may not be exact measurements.

Leo Edwards
0472523445
 leo@atrealty.com.au
 www.atrealty.com.au

