



SOLD

STUNNING FAMILY HOME IN A GREAT LOCATION

What a fantastic opportunity to purchase a large family home in perfect condition, located in one of Mount Gambier's most desirable areas.

Set on a generous 735m² allotment, this impressive brick and tile home is perfectly positioned just a short stroll from St Martin's Lutheran College and Good Start Berrin Learning. The Marketplace and Mount Gambier's main street are just minutes away, and a park/playground sits only fifty metres up the road from the property, making it ideal for families who want both convenience and a lavish lifestyle.

The spacious interior features four well-sized bedrooms, including a master suite complete with a walk-in robe and ensuite.

At the heart of the home, the light-filled kitchen boasts a solid blackwood kitchen with electric cooking, a dishwasher, a double sink, and ample storage, overlooking the open dining family area. Multiple living zones cater to family needs, featuring a large family room, an excellent location for a growing family to enjoy, maybe a billiards or theatre room, and a space for family gatherings. A formal lounge that may be ideal as a parents' getaway area, and a versatile third space that can serve as a second sitting room or home office.

The main bathroom includes a bath, shower, and vanity, complemented by a separate toilet for added functionality.

Central gas heating is ducted throughout the home, keeping the family friendly and warm throughout the winter months. Split-system air conditioning and ceiling fans keep the house cool throughout the summer months.

Well-appointed bathrooms with a huge laundry with heaps of cupboards and a built-in wine rack.

The home features neutral tones, complemented by quality floor and window treatments—no need to build when you have a quality home in such a location.

Sliding doors lead to a large alfresco area, which features a built-in chimney and café blinds,

4 BED | 2 BATH | 2 CAR

PRICE:
\$680,000

OPEN FOR INSPECTION:
N/A



Peter Dempsey
0418854393
peterdempsey@atrealty.com.au
peterdempseyatrealty.com
RLA: 269823

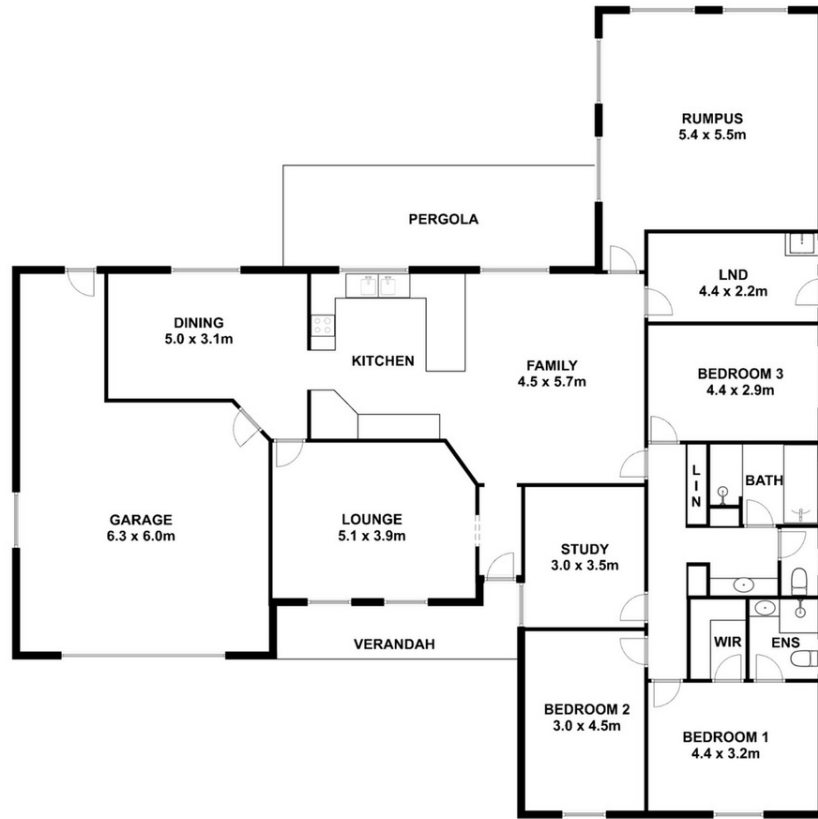

Living : 247 SQ.M
Pergola : 20 SQ.M
Verandah : 9 SQ.M
TOTAL AREA : 276 SQ.M

This drawing is for illustration purpose only. All measurements are approximate only and information intended to be relied upon should be independently verified

Disclaimer: Please note this floor plan is for marketing purposes and is to be used as a guide only. All dimensions are estimates only and may not be exact measurements.