

8 DIANELLA CLOSE, MOORE CREEK, NSW, 2340



## FOR SALE

### MOST PRESTIGIOUS 1-ACRE ENCLAVE - VIEWS H & L PACKAGE - \$1.2M INC STAMP

8 DIANELLA CLOSE , MOORE CREEK

Situated in the most sort after pocket in North West New South Wales, you'll find 8 Dianella Close. This idyllic rural, registered 1 acre (4000 sq metres) block is taking in the views of the surrounding countryside.

#### IN ADDITION

We are now offering a House and Land Package for \$1,200,000 which includes STAMP DUTY. The Hunter Homes Branxton Acreage 265 Design comes with a comprehensive range of high quality features and finishes all included as Standard. A complete list of inclusions is available on the Hunter Homes Website.

This property will be well positioned in one of Tamworth's premier neighbourhoods and just moments from the heart of the city. A rare gem presents a wonderful lifestyle opportunity.

- \* Panoramic views from one of the most stunning vantage points in the area :-
- \* Natural Gas
- \* Sewer
- \* Underground Power
- \* NBN
- \* A building site like no other!

Don't miss this rare opportunity to secure one of the most magical house and land packages still available in Tamworth.

For further information, contact Stuart Watts 0455 031619.

#### Forest Heights Estate:

With the Tamworth Hospital approximately 4 minutes away, Forest Heights is becoming the sought-after area of The New England region, with relocating Professionals, Long term locals, along with Doctors and Retirees , this location as desirable for its convenience, views and ambience. This area is out performing similar areas of other regional city's as we see properties

0 BED | 0 BATH | 0 CAR

PRICE:  
\$440,000

OPEN FOR INSPECTION:  
N/A



**Stuart Watts**  
**0455031619**  
stuart@atrealty.com.au  
[www.atrealty.com.au](http://www.atrealty.com.au)

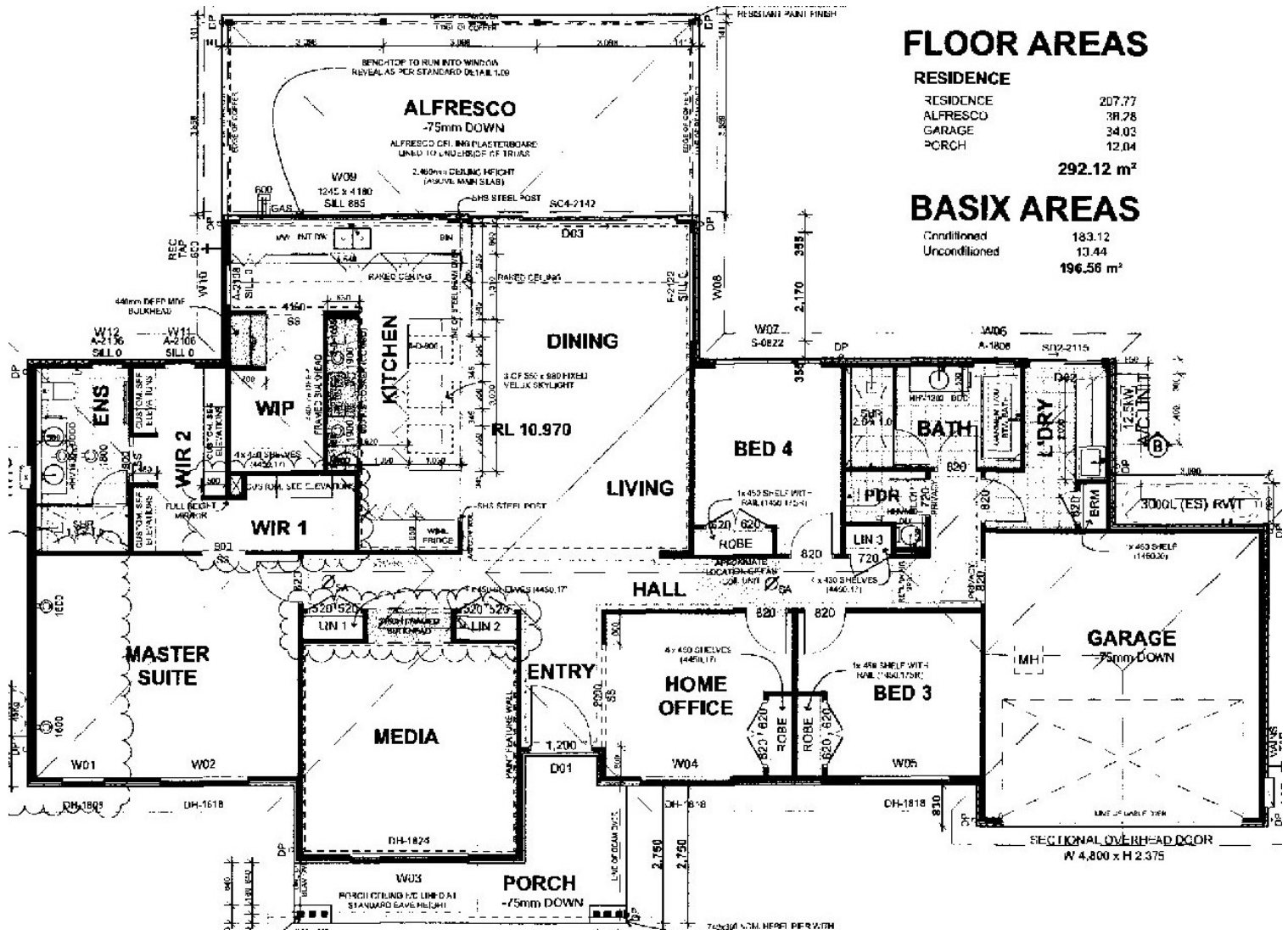

## FLOOR AREAS

RESIDENCE	
RESIDENCE	207.77
ALFRESCO	38.28
GARAGE	34.03
PORCH	12.04
<b>TOTAL</b>	<b>292.12 m<sup>2</sup></b>

## BASIX AREAS

Conditioned	183.12
Unconditioned	13.44
<b>TOTAL</b>	<b>196.56 m<sup>2</sup></b>

Disclaimer: Please note this floor plan is for marketing purposes and is to be used as a guide only. All dimensions are estimates only and may not be exact measurements.