



SOLD

SOLID FAMILY HOME ON 703SQM CORNER BLOCK

A perfect opportunity for first-home buyers, families or investors, this mid-1970's family home offers a convenient location, comfortable living, and the opportunity to further enhance and add value over time. The 703sqm corner block also provides potential for a second dwelling or subdivision (subject to Council approval).

Upstairs features timber floors, a spacious living/dining and functional kitchen. The dining room flows to an expansive rear deck overlooking the large, fenced backyard. The bedrooms and bathroom are located away from the main living areas.

Internal stairs provide easy access between the upper and lower level. Downstairs you will find a generous rumpus, laundry and double lock-up garage with remote doors. There is a delightful covered area leading from the rumpus which provides another outdoor entertainment or relaxation space.

Situated 400m from bus services, and with a selection of retail, dining and medical amenities a short drive away the location is ideal. McDowall State School and Albany Creek State High School are the local school catchments.

Features include:

- *solid 3 bed, 1 bath, 2 car family home
- *rumpus
- *large deck
- *timber floors upstairs
- *air conditioning
- *solar power
- *corner 703 sqm block
- *McDowall State and Albany Creek High School Catchments

Contact Karen Marlow on 0411 033 892 for more information.

3 BED | 1 BATH | 2 CAR

PRICE:
\$1,060,000

OPEN FOR INSPECTION:
N/A



Karen Marlow
0411033892
karenmarlow@atrealty.com.au
www.atrealty.com.au



FIRST FLOOR

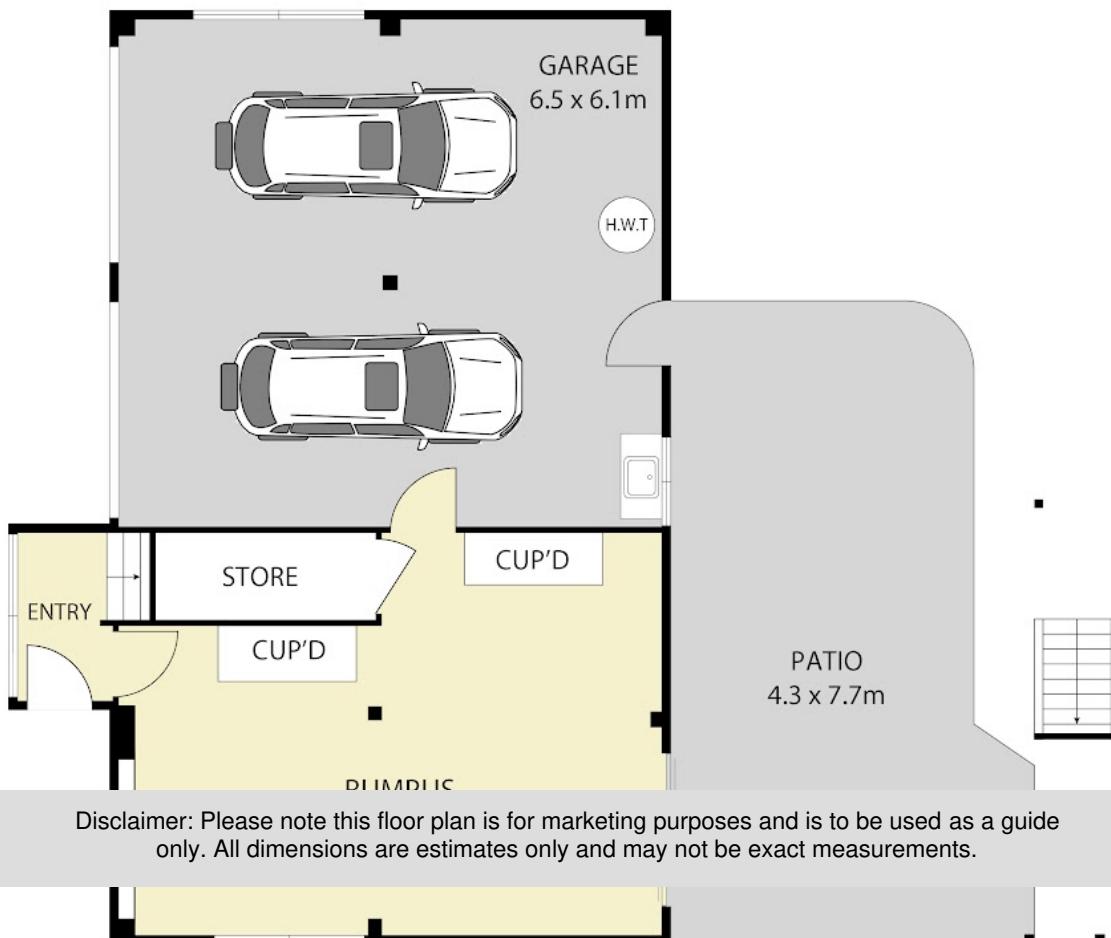

GROUND FLOOR

Disclaimer: Please note this floor plan is for marketing purposes and is to be used as a guide only. All dimensions are estimates only and may not be exact measurements.