



FOR SALE

SORRENTO ARCHITECTURAL SANCTUARY WITH SOARING CATHEDRAL CEILINGS

Exciting opportunity to move into your own private oasis in one of the Gold Coasts most premier suburbs.

This beautifully upgraded townhouse presents a rare opportunity to secure a timelessly stylish, architecturally modern, move-in ready home within one of the coasts most sought-after riverside communities.

Featuring soaring skylights, cathedral ceilings and generous living spaces that free standing homes could only dream of! the property exudes comfort, privacy and effortless elegance. The centrepiece is a lush east-facing, courtyard garden, thoughtfully designed as a tranquil tropical oasis that connects and compliments the surrounding waterways. With secure gate access to Saint Tropez Terrace, the outdoor space is both practical and serene, ideal for relaxing and entertaining. Inside, tasteful renovations deliver warmth and longevity, from the beautifully updated kitchen to the open plan living zones filled with natural light. Upstairs, a cleverly designed mezzanine offers a discreet home office setup, perfectly integrated without interrupting the home's charm or visual flow, oozing natural light, ocean breeze and views from the desk overlooking the open plan living area through to the tropical garden.

Just moments from upmarket, high-end cafés, shops, this is low maintenance living with exceptional lifestyle appeal. This property comes with its own private spa amongst the irrigated tropical gardens.

- Features**
- Timeless, tasteful renovations throughout
 - Striking open cathedral ceilings
 - Light filled open plan living and dining
 - Stunning private courtyard garden, an east facing tropical oasis
 - Secure gate access directly to Saint Tropez Terrace
 - Beautifully updated kitchen with quality finishes
 - Spacious mezzanine for a discreet home office
 - Two generous bedrooms with shared balcony

2 BED | 2 BATH | 2 CAR

PRICE:
For Sale - Contact for Inspections

OPEN FOR INSPECTION:
N/A



Chris Cramp
0452032022
 chris.cramp@atrealty.com.au
www.atrealty.com.au

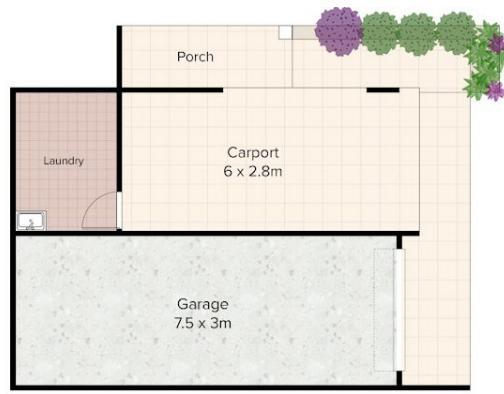

14/9 Freyburg street,
Sorrento

CHRIS CRAMP | 0452 032 022

Internal area approx: 134m²
External Area approx: 64m²
Total area approx: 198m²



Whilst every attempt has been made to ensure the accuracy of the floor plan contained here, measurements of floors, windows, rooms and any other items are approximate and no responsibility is taken for error, omission or mis-statement. This plan is for illustrative purposes only and should only be used as such by any prospective purchaser.

Disclaimer: Please note this floor plan is for marketing purposes and is to be used as a guide only. All dimensions are estimates only and may not be exact measurements.

Chris Cramp
0452032022
chris.cramp@atrealty.com.au
www.atrealty.com.au

