



**SOLD**

## WHAT DO YOU WANT? 5 BEDS, PRIVACY, SHEDS, VIEWS! IT'S GOT THE LOT!

Presented exclusively by your Professional Local Gympie Agents, Ian & Janelle Pye

This 7 acre (approx) block has been carefully landscaped for maximum effect and minimum maintenance making this property an inviting and glamorous retreat, particularly at night. Day or night, the views are spectacular. With 5 bedrooms, 2 ensuites and a third well appointed bathroom, this is a home for a growing or extended family. The master suite features expansive views of the countryside and the city lights. There's inbuilt flexibility in the 4 other bedrooms, making it possible to create a study or guest room to suit your family needs. There are 3 bedrooms upstairs sharing the full length balcony. Some quiet time on the balcony will allow you to experience the magnificent aura that surrounds this property.

The natural bushland setting offers privacy, peace and quiet and requires very little maintenance. This is a wildlife friendly property where you'll be in awe of the magnificent king parrots and the myriad of other wildlife that comes in to feed right there in your backyard.

The large 15 mtr x 7.6 mtr powered shed has accommodation for your cars plus loads of workshop space. This could be perfect for a tradie or hobby enthusiast as this fully powered space has no limits to its potential. Then there is the separate high caravan/carport 9 mtrs x 7 mtrs for your caravan or motor-home storage. Rainwater storage aplenty here too. 5 large tanks capture the rainwater from the enormous combined roof areas of the home and shedding.

Features of 195 Benian Road, The Palms

- Unique double story Tudor style home
- Large Open Plan Kitchen, Dining & Lounge area
- New Guinea Rosewood Kitchen
- Downstairs has 2 Bedrooms with Ensuites & Air-Conditioning
- Upstairs 3 Bedrooms with separate Bathroom
- All bathrooms have Baths and separate Showers
- Enjoy Outdoor Living on the downstairs undercover Sandstone Verandah
- Full Length Deck upstairs taking in the stunning Easterly views
- 15 x 7.6 x 2.7m powered and insulated shed

**5 BED | 3 BATH | 2 CAR**

**PRICE:**  
\$448,000

**OPEN FOR INSPECTION:**  
N/A



**Ian and Janelle Pye**  
**0437778111**  
ianpye@atrealty.com.au  
[www.atrealty.com.au](http://www.atrealty.com.au)

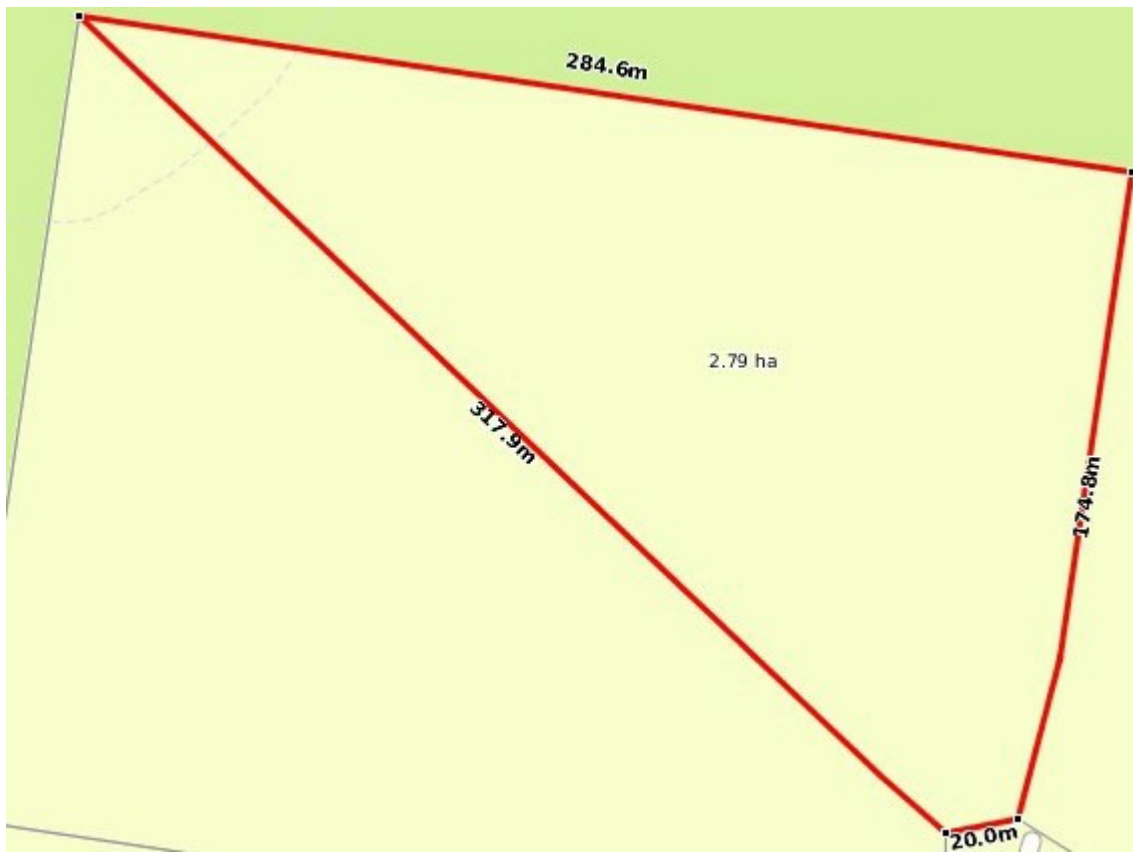

Disclaimer: Please note this floor plan is for marketing purposes and is to be used as a guide only. All dimensions are estimates only and may not be exact measurements.