



SOLD

PRICE ADJUSTED - EFFORTLESS LIVING AT THYME LIFESTYLE RESORT MAREEBA...

This near-new one-bedroom home offers an easy, low-maintenance lifestyle with far more amenities than you might expect and so much more.

Built just two years ago and rarely lived in while the owners travelled, the home presents in excellent condition and is ideal for lock-up-and-leave living.

Designed as part of a duplex, the layout is unique, practical, and spacious. It includes one generous bedroom, a modern bathroom, and a large open-plan living, dining, and kitchen area. A front patio, side patio, and single remote-controlled garage complete the home.

The living space is light-filled and expansive, with the kitchen offering electric cooking, a pantry, and views to the front patio. The large bedroom includes a built-in robe and opens directly to the side patio, which is also accessed from the lounge—perfect for relaxed indoor-outdoor living.

Quality extras set this home apart. Roller blinds in the living area and stylish panel glide blinds in the bedroom allow excellent light control and privacy. The front patio features roll-down blinds on two sides, creating a comfortable and private entertaining space. The side patio is another inviting retreat, enhanced by additional paving and full length blind. Security screen doors as well for added peace of mind. These extras are what sets this home apart from others. The hard work of sourcing and waiting for these to be done is already here, and this equates to having absolutely nothing to do except move in and enjoy.

The fully fenced yard with colourbond fencing is ideal for a small pet. You can add pots or garden beds if you wish, or simply enjoy the ease of a low-maintenance lifestyle—perfect for those who love to travel.

Residents enjoy access to an outstanding range of facilities including bowling, swimming, water aerobics, community gardens, art room, cinema, Lady/Man Shed, communal dining and kitchen facilities, open spaces to chat, a bar as well and secure storage for a caravan or motorhome. Be as involved as you choose, with no pressure—everything is available and fully maintained for your enjoyment.

1 BED | 1 BATH | 1 CAR

PRICE:
\$315,000

OPEN FOR INSPECTION:
N/A



Kendall Booth
0417167695
kendall@atrealty.com.au
[Kendall Booth Website](#)

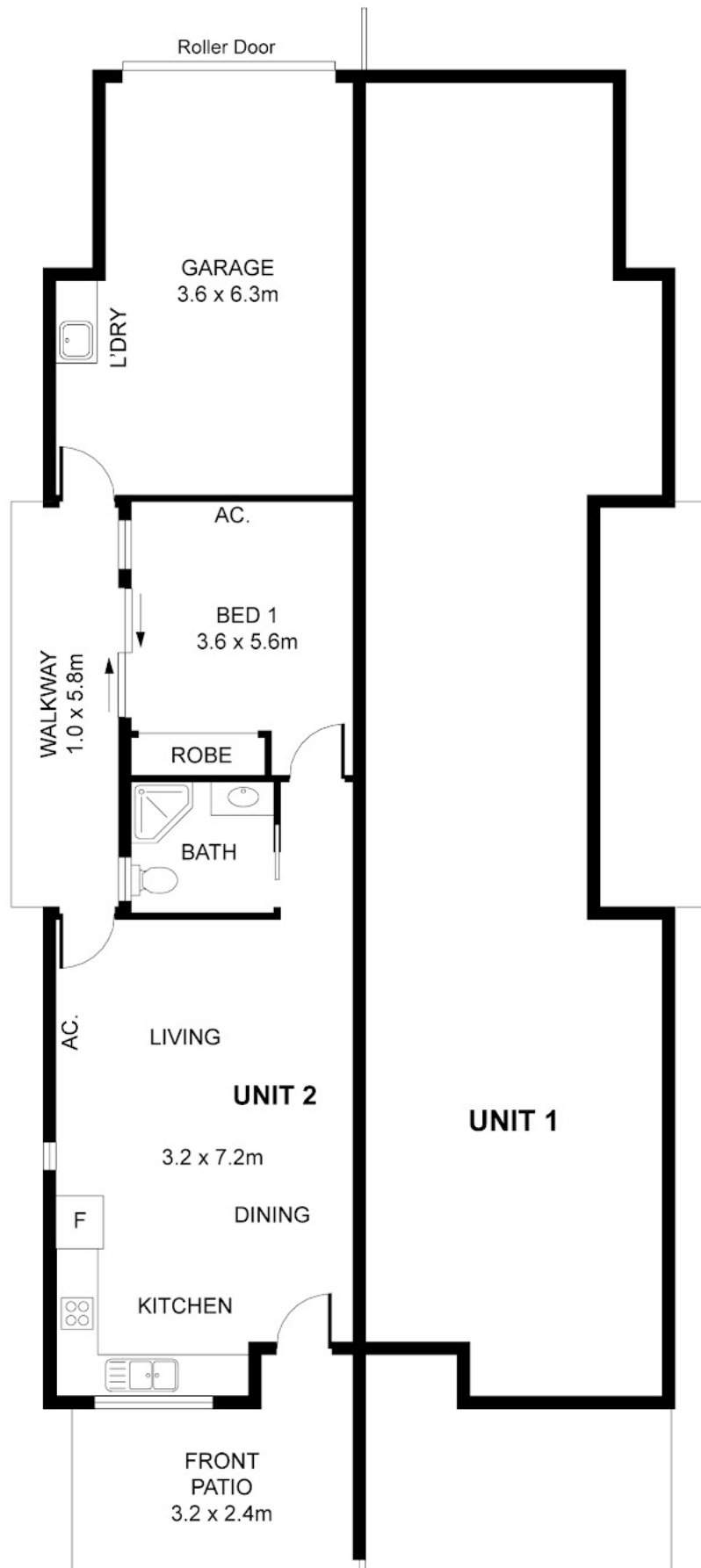

Disclaimer: Please note this floor plan is for marketing purposes and is to be used as a guide only. All dimensions are estimates only and may not be exact measurements.

TYNE LIFESTYLE RESORT,

DISCLOSURE: ALL MEASUREMENTS ARE APPROXIMATE AND MAY NOT BE EXACT. DO NOT RELY ON THE ACCURACY OF THIS FLOOR PLAN WHEN DETERMINING THE PRICE OF A PROPERTY OR MAKING DECISIONS REGARDING BUYING OR SELLING OF PROPERTIES WITHOUT INDEPENDENT VERIFICATION.

Kendall Booth
 0417167695
 kendall@atrealty.com.au
[Kendall Booth Website](#)

