



# SOLD

## EXPERIENCE THE BEST OF BEACHFRONT LIVING IN THE ICONIC FOCUS BUILDING

Perched on the 6th floor of the prestigious Focus building, this spacious apartment offers breathtaking, uninterrupted 180 degree ocean views from Main Beach to Coolangatta. Situated directly opposite lifeguard tower 35 and just a mere 10-second walk to the beach, you'll enjoy the tranquility of coastal living with the added convenience of being only 400 meters from the bustling Cavill Avenue—perfectly placed to embrace both peace and proximity to the action.

Spanning 144 square meters, this apartment features three generously sized bedrooms, two and a half bathrooms, and a separate laundry. With three covered balconies, there's ample space to relax and take in the spectacular ocean views. This unit is ready for you to move in and make it your own.

### Additional Features:

- Pet Friendly building
- Close to Public Transport
- Ceiling fans for year-round comfort
- Dishwasher and microwave for added convenience
- Expansive 7-metre-long lock-up garage with extra storage space and cupboards

### Building Amenities:

- Spacious visitor parking for up to 20 vehicles
- Newly installed heated pool
- Hot spa
- Tennis court, basketball court, table tennis room, and a small gym
- Two large covered BBQ areas
- Lush gardens and vast grounds, ideal for future development

Whether you're seeking a prime beachfront residence, looking to earn rental income of \$1,300 +/- per week, or considering holiday letting, the options are endless. This is a rare gem, nothing else compares in terms of size and price on the beachfront in Surfers Paradise.

Seize this exceptional opportunity before it's gone!

### 3 BED | 2 BATH | 1 CAR

PRICE:

**\$1,300,000**

OPEN FOR INSPECTION:

N/A



**Raine Scott**

**0415250414**

[raine@mandate2.com.au](mailto:raine@mandate2.com.au)

[mandate2.com.au](http://mandate2.com.au)

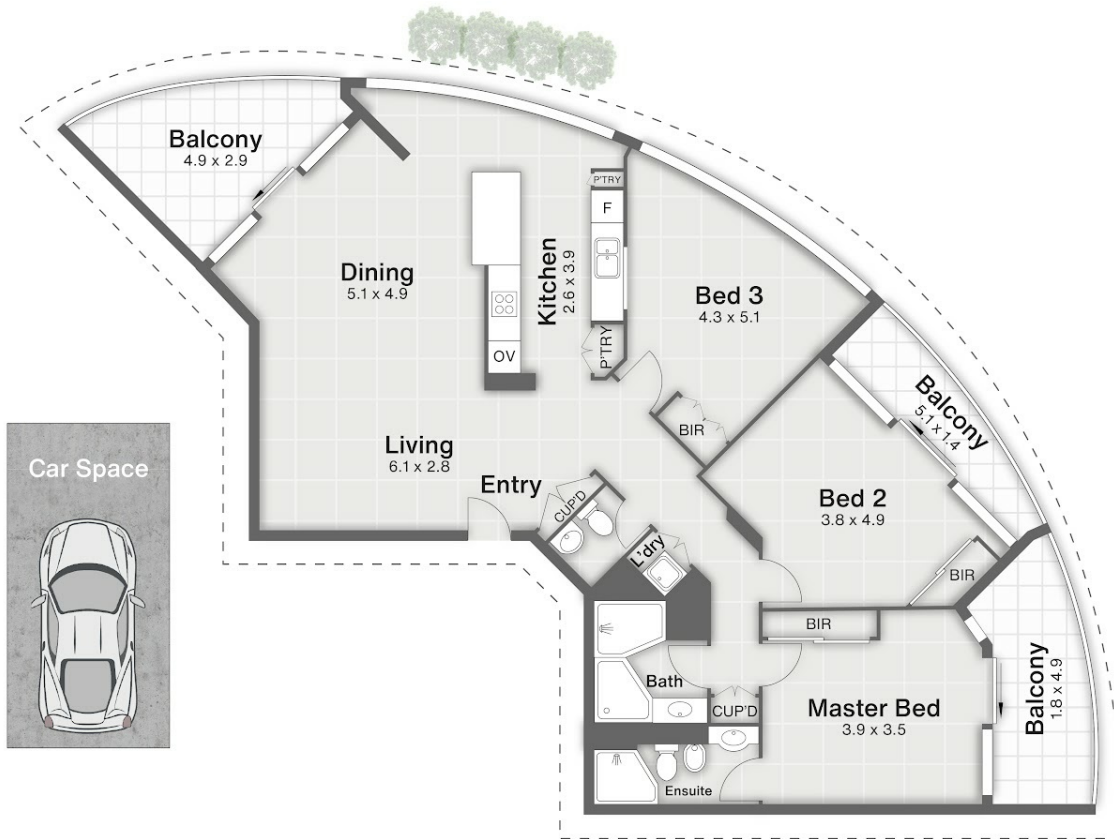

26/114 The Esplanade **SURFERS PARADISE**

3 | 2.5 | 1 | 144m<sup>2</sup>

**Mandate**  
PROPERTIES

All dimensions are approximate; they are subject to errors and inaccuracies and no liability will be accepted. Plans are shown for marketing purposes only.

Disclaimer: Please note this floor plan is for marketing purposes and is to be used as a guide only. All dimensions are estimates only and may not be exact measurements.

**Raine Scott**  
0415250414  
raine@mandate2.com.au  
mandate2.com.au

@realty