



**SOLD**

## CHARMING 3-BEDROOM EASY RENOVATOR PROPERTY IN SCENIC FLAXTON

Nestled in the heart of Flaxton's rural charm, this easy renovator 3-bedroom house presents an exceptional opportunity to embrace the tranquil hinterland lifestyle. Set on a generous 840 square metre fully fenced block with district views, this 200 square metre home combines country living with modern convenience just minutes from the Sunshine Coast.

The thoughtfully designed layout features three comfortable bedrooms, 2 of which are fitted with built-in wardrobes for optimal storage solutions. The single bathroom services the home efficiently, while the spacious lounge and Deck area provides the perfect gathering space for family and friends to relax and unwind.

Beautiful floorboards flow throughout the interior, creating a warm and inviting atmosphere that showcases the home's quality construction. The well-appointed kitchen and living areas are complemented by practical built-in storage solutions, ensuring everything has its place in this well-organised residence.

Step outside to discover your own private oasis featuring:

- Covered balcony perfect for morning coffee with district views
- Dedicated outdoor entertainment area ideal for hosting gatherings
- Fully fenced property ensuring privacy and security
- Workshop space for hobbies, storage, or potential home business
- Eco-friendly water tank System for sustainable living

The property includes a double garage, providing ample space for two vehicles plus additional storage. The expansive grounds offer endless possibilities for gardens, play areas, or future extensions, all while maintaining the peaceful rural ambiance that makes Flaxton so desirable.

Flaxton's rich agricultural heritage dating back to the 1880s has evolved into a sought-after residential area known for its banana and citrus farming history. The locality offers the perfect balance of rural tranquillity and accessibility, with the area's rolling hills and panoramic coastal views creating a picturesque backdrop for daily life.

Families will appreciate the proximity to quality educational facilities, with Mapleton State School

**3 BED | 1 BATH | 2 CAR**

**PRICE:**  
**\$900,000**

**OPEN FOR INSPECTION:**  
**N/A**



**Len Geary**  
**0418221281**  
len.geary@atrealty.com.au  
[www.atrealty.com.au](http://www.atrealty.com.au)

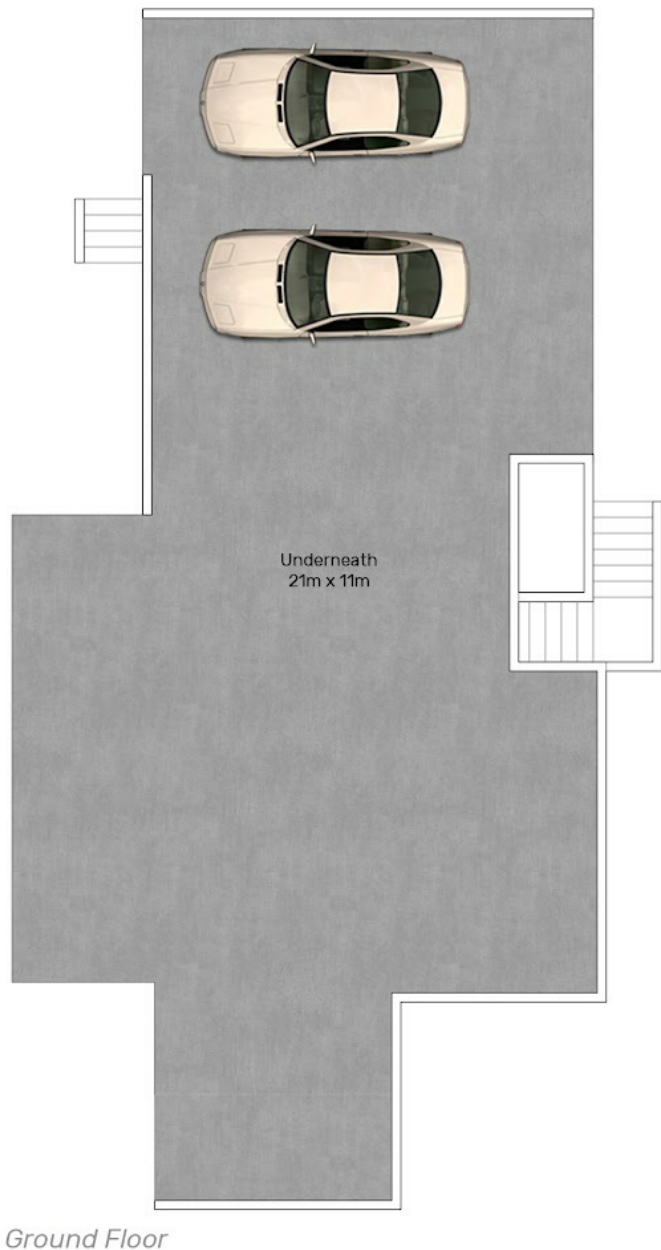

Disclaimer: Please note this floor plan is for marketing purposes and is to be used as a guide only. All dimensions are estimates only and may not be exact measurements.