



FOR SALE

FOUR BEDROOM HOME ON 80 HECTARES QUALITY FARMLAND IN EUREKA

Owner is negotiable with WIWO furnishings and equipment.
Property exchange considered.

Embrace the tranquil rural lifestyle at this 4-bedroom acreage property on 80.27 hectares of pristine Queensland countryside. Nestled on Griggs Road in the peaceful locality of Eureka, this country haven offers the perfect escape from city life while maintaining convenient access to regional amenities.

This thoughtfully designed home showcases country living with four generous bedrooms and two well-appointed bathrooms. The property features built-in wardrobes for ample storage and modern conveniences including a dishwasher and air conditioning to ensure year-round comfort. The rural aspect provides beautiful views across the expansive landscape, creating a sense of space and serenity that's hard to find elsewhere.

Step outside to discover the country living that enhances outdoor entertaining opportunities this property offers. The spacious deck provides the ideal setting for morning coffee while watching the sunrise over your land, or evening gatherings under the stars. Multiple sheds offer practical storage solutions for farm equipment, vehicles, or hobbies, while four carport spaces ensure plenty of covered parking for your vehicles and machinery. There is approximately 32 acres of land which is leased to a local ginger grower with a one-year lease in place, with a two-year option.

- 80.27 hectares of prime rural land offering endless possibilities
- Sustainable living features including water tank and grey water system
- Multiple outdoor structures perfect for rural lifestyle and storage needs
- Domestic bore a feature a lake/dam that supplies water for irrigation to farming parcel
- Air conditioning throughout for climate comfort
- Built-in wardrobes maximizing storage efficiency

The eco-friendly credentials of this property are impressive, featuring both a water tank system and grey water system that support sustainable living while reducing environmental impact. These thoughtful additions not only benefit the environment but also provide practical cost savings for the discerning rural property owner.

4 BED | 2 BATH | 4 CAR

PRICE:
CONTACT AGENT

OPEN FOR INSPECTION:
N/A



Kristina Georges
0499938838

kristinageorges@atrealty.com.au

www.atrealty.com.au

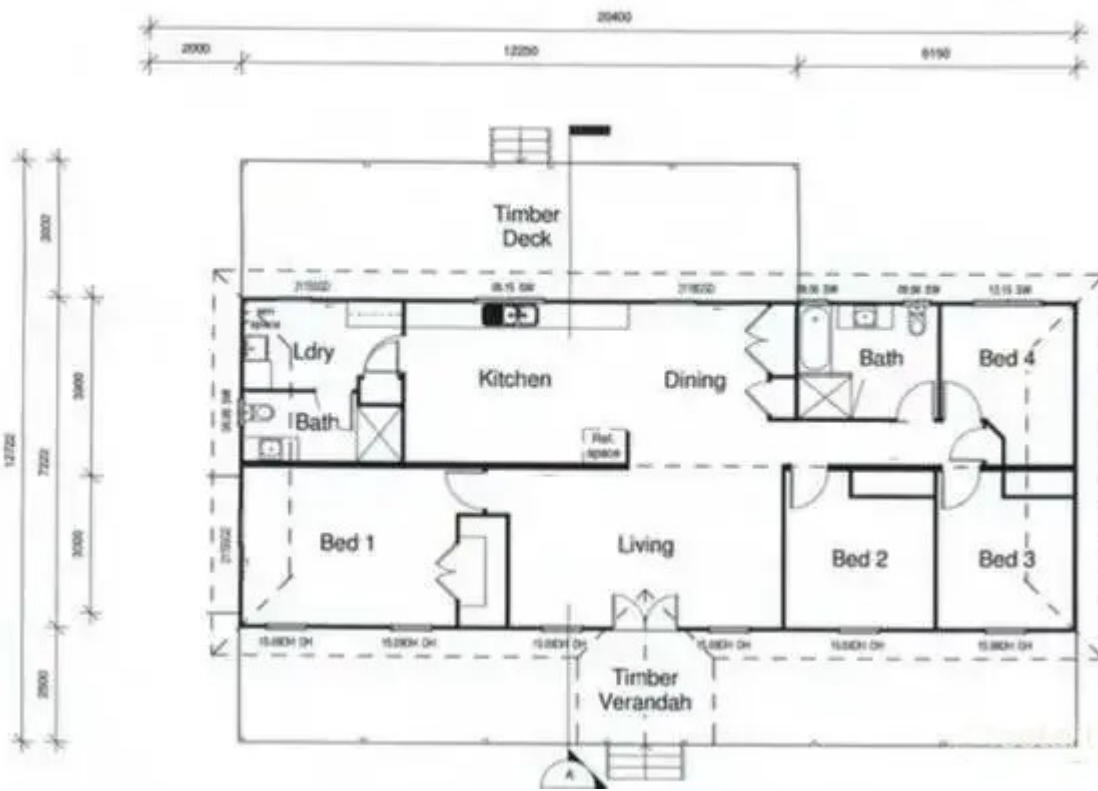

Disclaimer: Please note this floor plan is for marketing purposes and is to be used as a guide only. All dimensions are estimates only and may not be exact measurements.