

**SOLD**

## MODERN ACREAGE LIVING WITH VIEWS, PRIVACY & SPACE FOR THE FAMILY

Submit an enquiry over Christmas to express your interest and see this property first.

2 Pine Court sits proudly in one of Kingaroy's most desirable acreage estates - quiet, elevated, and just a short drive into town.

Offering neat established gardens, plenty of yard space, and multiple indoor and outdoor living areas, this home delivers an ideal lifestyle for families, downsizers who still want space, or anyone wanting peace and privacy without being remote.

The brick home presents beautifully, with fresh paint and near-new carpets adding a modern, cared-for feel. The layout is functional and spacious, with open-plan living, a separate lounge, and a central kitchen positioned to overlook the outdoor area.

The main living zone features a large split system air-conditioner. The bedrooms include built in robes, and the master bedroom includes an ensuite and built in robes.

Outdoors, the main covered entertaining area flows off the main living space, creating a private spot to enjoy morning coffees, family meals and easy weekends, while another sitting area provides you with options for enjoying your relaxation.

The yard is fully established, with landscaped lawns, mature plantings and plenty of room for kids, pets and activities, and beautiful views of the Bunya Mountain and surrounding countryside from various parts of the property.

The double garage features electric opening doors and plenty of storage, and connects directly to the home, plus there's a separate powered 6m x 9m shed—ideal for trailers, workshop, gym space or extra parking.

Recent updates and extras include:  
New electric hot water system  
Solar on roof to reduce running costs  
Compliant new smoke alarms

**4 BED | 2 BATH | 4 CAR**

**PRICE:**  
\$825,000

**OPEN FOR INSPECTION:**  
N/A



**Julian Gregson**  
**0421577537**  
julian.gregson@atrealty.com.au  
[www.juliangregson.com.au](http://www.juliangregson.com.au)

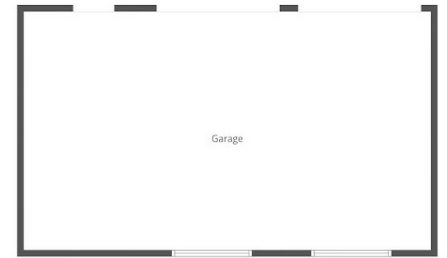

Floor plan is provided as indicative layout only. Measurements are not available, floor plan is not to scale. No guarantees provided on accuracy. Exterior elements are not in position

Disclaimer: Please note this floor plan is for marketing purposes and is to be used as a guide only. All dimensions are estimates only and may not be exact measurements.

