



FOR SALE

AMAZING 3 BED FULLY OVERLOOKING THE PACIFIC OCEAN IN VICTORIA TOWERS OVER 50'S

CALL JACKIE TAYLOR-FOX TO PRIVATELY INSPECT TODAY 0411236823

VICTORIA TOWERS OVER 50'S FREEHOLD APARTMENTS - Enjoy the Retirement Lifestyle you Deserve.

This spacious apartment offers the perfect combination of stunning views, convenience, luxury and security. With the added bonus of a sought after north-easterly aspect, this is a clear winner if looking for your next HOME

At Victoria Towers you can relax, enjoy the SECURE resort style facilities including:

- * Magnificent OCEAN views from the large balcony which is great for entertaining
- * Main bedroom with walk-in robe and fully-tiled ensuite
- * 3 Bedrooms 2 Bathrooms 2 Carparks LARGE BALCONY WITH WIDE OCEAN VIEWS
- * Two extra bedrooms with built-in robe - extra bathroom with bathtub and stone top vanity
- * Ducted reverse cycle air-conditioning throughout for year round comfort
- * Exclusive & Highly Sought after FREEHOLD OVER 50's Resort Style Apartments
- * Stylish and luxuriously appointed with quality fittings
- * Designer Kitchen with European appliances, Stone Benchtops, plenty of cupboard space
- * On-site Facilities Manager - Enjoy a Social Calendar of Events
- * 25 Meter Lap pool - Heated all year Hot Spa, Sauna and Steam room
- * Room to socialize in the Residents Lounge Library with Cinema,
- * Professionally equipped GYM Open-Air Bowling Green BBQ and Dining Terrace
- * Full Calendar of Social Events including Happy Hours/Bus Trips/Craft Classes/Poolside BBQs
- * Plus, Aqua Aerobics/Chair Yoga/Coffee Mornings/Ladies Lunches/Film Nights/Special Events
- * On-site Security and Intercom access with Visitors parking available - Privacy Assured
- * ESTIA - 5-star aged care facilities with separate entrance - great for later years
- * Stroll to the Beach & Broadwater Parklands with Australia Fair virtually on your doorstep
- * Minutes to Southport Yacht Club & Marina and Gold Coast Hospital and adjacent to RSL CLUB
- * 100m to Light Rail Station which takes you Sth to Broadbeach and Nth to Helensvale Connection

3 BED | 2 BATH | 2 CAR

PRICE:
OFFERS OVER \$1,55M

OPEN FOR INSPECTION:
N/A



Jackie Taylor-Fox
0411236823

jackietaylorfox@atrealty.com.au

www.atrealty.com.au

FLOORPLAN - TYPE E-NE

LEVELS 33 - 35

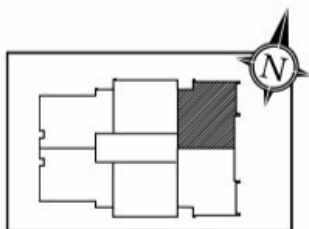

Disclaimer: Please note this floor plan is for marketing purposes and is to be used as a guide only. All dimensions are estimates only and may not be exact measurements.

| | |
|---------------|-------------------------|
| Internal Area | 122m ² |
| Balcony | 19m ² |
| Total | 141m² |

Jackie Taylor Fox
 0411236823
 jackietaylorfox@atrealty.com.au
www.atrealty.com.au

