



FOR LEASE

SINGLE LOCK UP GARAGE + WORKSHOP, VIEW, PRIVACY

Great location, Privacy, Space, Secure & great outlook.

Freshly renovated and positioned on the top floor, this bright and private two-bedroom apartment enjoys an excellent outlook at the Sundale Bridge and Broadwater end of Southport. Light-filled and breezy, the home captures views across the Bowls Club to the Surfers Paradise skyline, offering a relaxed coastal lifestyle with urban convenience.

Stroll to the Broadwater, G:Link light rail, Australia Fair and the CBD, all just moments from your door.

Recently refreshed throughout, the apartment features a brand-new kitchen, new flooring and fresh paint, creating a modern and inviting feel. The open-plan living area is air-conditioned and flows to a spacious balcony, ideal for enjoying the outlook and cooling breezes.

With a single lock-up garage plus secure, lockable storage, this property is ideal for tradies, business owners or anyone requiring additional secure space.

Property features include:

- * Secure top-floor position - no lift
- * Brand-new, generous kitchen with fridge included
- * Tiled entry and dining area with enclosed sunroom
- * Bright, airy open-plan living with air conditioning
- * Spacious balcony overlooking the Bowls Club with Surfers skyline views
- * Two good-sized bedrooms with walk-in robes and ceiling fans
- * Large internal storage cupboard
- * Bathroom with bathtub and internal laundry (washing machine included)
- * Single lock-up garage with auto remote
- * Lockable storage area approx. 3.2m x 2.8m

Available immediately.

Living here means being part of Southport's rich tapestry – Australia's most populous Gold Coast suburb and the region's central business district. You'll be surrounded by the area's fascinating history, from its origins as a timber port to its current status as a thriving cosmopolitan hub with a diverse community representing cultures from around the world.

2 BED | 1 BATH | 1 CAR

PRICE:

\$780 per week

OPEN FOR INSPECTION:

N/A



Audrey Goetz

0412148078

audrey@atrealty.com.au

www.atrealty.com.au

8/2 Marine Parade, Southport

2 1 1

internal: 86 m² | external: 13 m² | garage + storage: 28 m² | total: 127 m²

@realty
Audrey Goetz 0412 148 078

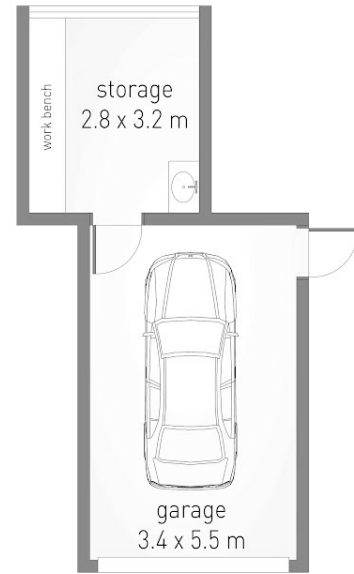
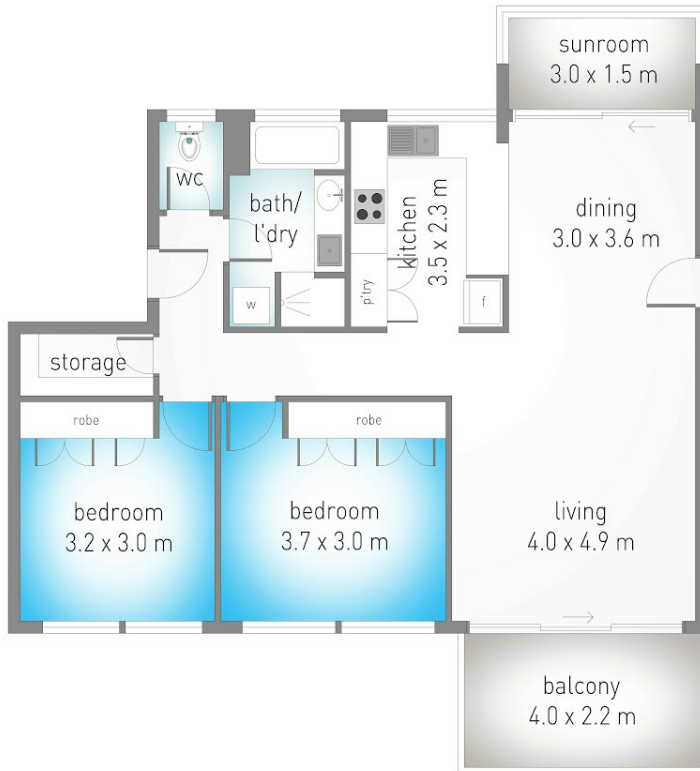

Dimensions are approximate. All information contained herein is gathered from sources we believe to be reliable. However we cannot guarantee its accuracy and interested persons should rely on their own enquiries. north

Disclaimer: Please note this floor plan is for marketing purposes and is to be used as a guide only. All dimensions are estimates only and may not be exact measurements.

Audrey Goetz
0412148078
audrey@atrealty.com.au
www.atrealty.com.au

@realty