

ADDRESS UPON REQUEST



## FOR SALE

### LOW-MAINTENANCE MODERN TOWNHOUSE OPPORTUNITY IN GROWING GRIFFIN!

This modern three-bedroom townhouse is located within the growing suburb of Griffin and presents a low-maintenance investment opportunity in a high-demand area.

The property includes three bedrooms with built-in wardrobes, two bathrooms, and the kitchen is fitted with modern appliances.

Outdoor features include a private courtyard and outdoor entertainment area. Secure parking is provided via a remote-controlled garage. The property is situated on an approximately 198m<sup>2</sup> block within a well-maintained complex.

The location offers close proximity to Murrumba Downs Shopping Centre, providing convenient access to Coles, medical services including a GP, and everyday retail needs. The property is also just minutes from Griffin State School and Living Faith Lutheran Primary School, with Westfield North Lakes a short drive away, offering a major retail, dining, and service precinct. Residents benefit from easy access to key road connections, public transport options, and established community infrastructure, with a new shopping centre planned for Brays Road, expected to be delivered in early to mid 2027.

This property presents a straightforward investment opportunity, offering a functional layout, modern inclusions, and a location supported by established infrastructure and amenities.

Email us for the comprehensive information pack.

\* Details correct to the best of our knowledge; images may have been enhanced with AI.

3 BED | 2 BATH | 1 CAR

PRICE:  
Contact Agent

OPEN FOR INSPECTION:  
N/A



**Frontline Properties**  
0452426095  
fpa@atrealty.com.au  
[www.atrealty.com.au](http://www.atrealty.com.au)

# TYPE K



**GROUND FLOOR**  
SCALE 1:100

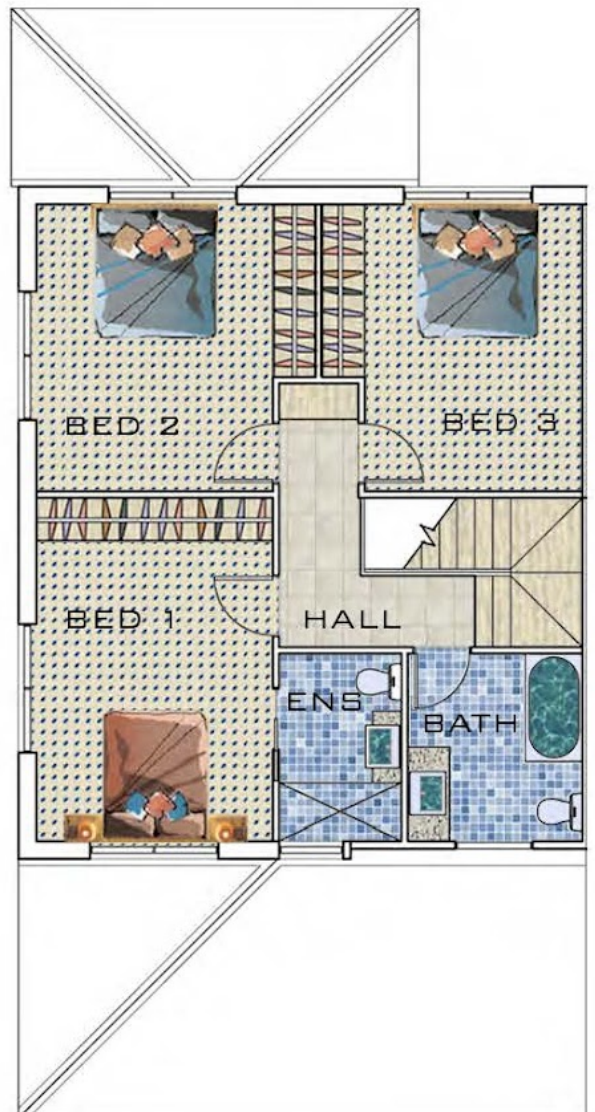

**FIRST FLOOR**  
SCALE 1:100

AREAS	
GFA	- 112.67 M2
GARAGE	- 19.79 M2
PATIO	- 16.71 M2

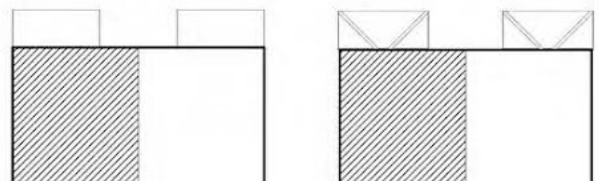

Disclaimer: Please note this floor plan is for marketing purposes and is to be used as a guide only. All dimensions are estimates only and may not be exact measurements.

**DENMACK DEVELOPMENTS**

Frontline Properties

0452426095

fpa@atrealty.com.au

www.atrealty.com.au



© Copyright RAL Architects. These plans must not be used or copied without the permission of RAL Architects.