



**SOLD**

## COASTAL DUPLEX IN SOUGHT AFTER LOCATION - SANDSTONE POINT

Embrace coastal living at its finest in this beautiful 3-bedroom duplex, perfectly positioned in the sought-after waterside community of Sandstone Point. This semi-detached home offers the ideal blend of comfort and convenience, just 52 kilometres north of Brisbane with easy access to Moreton Bay's pristine waters.

Some of the features include the following:

- \* Single garage providing secure parking and additional storage
- \* Side access that where you could park a boat/caravan
- \* Built-in wardrobes in all bedrooms for optimal organisation
- \* Private rear covered pergola area perfect for entertaining or quiet relaxation
- \* Fully fenced property ensuring privacy, security, child and pet friendly
- \* Front patio captures district views and stunning sunsets
- \* Solar panels
- \* Easy access to Bribie Island Road
- \* Close to Sandstone Point Hotel
- \* Ideal for downsizers, investors and first home buyers.

Step inside to discover thoughtfully designed living spaces that cater to easy lifestyle. The home features three bedrooms, each equipped with built-in wardrobes for seamless storage solutions. A well-appointed bathroom services the home, while the comfortable open plan living area provides the perfect space for relaxation and entertaining.

**3 BED | 1 BATH | 1 CAR**

**PRICE:**  
**\$745,000**

**OPEN FOR INSPECTION:**  
**N/A**



**Ross Hincksman**  
**0417687379**  
rossh@atrealty.com.au  
[www.atrealty.com.au](http://www.atrealty.com.au)

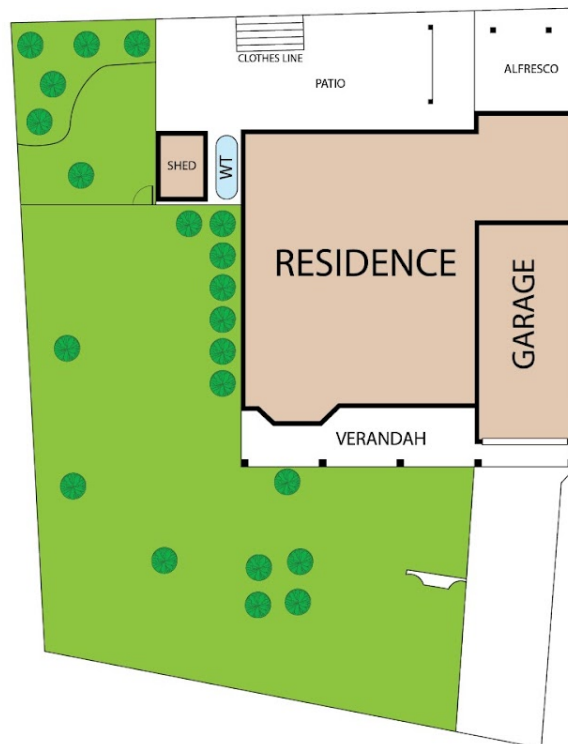

Unit 2/14 Nelson Street, Sandstone Point, QLD, 4511

TOTAL APPROX. FLOOR AREA 96 SQ.M

Whilst every attempt has been made to ensure the accuracy of the floor plan contained here, measurements of doors, windows, rooms and any other items are approximate and no responsibility is taken for any error, omission, or misstatement. This plan is for illustrative purposes only and should be used as such by any prospective purchaser.



Disclaimer: Please note this floor plan is for marketing purposes and is to be used as a guide only. All dimensions are estimates only and may not be exact measurements.

Ross Hincksman  
0417687379  
rossh@atrealty.com.au  
[www.atrealty.com.au](http://www.atrealty.com.au)

