



FOR SALE

RURAL COUNTRY PARADISE ON 80 HECTARES QUALITY LAND IN EUREKA EXPRESSION OF INTEREST CONSIDERED

Owner is negotiable with WIWO furnishings and equipment.
Property exchange considered.

Embrace the tranquil rural lifestyle at this 4-bedroom acreage property on 80.27 hectares of pristine Queensland countryside.

Multiple sheds offer practical storage solutions for farm equipment, vehicles, or hobbies, while four carport spaces ensure plenty of covered parking for your vehicles and machinery. There is approximately 32 acres of land which is leased to a local ginger grower with a one-year lease in place, with a two-year option.

- 80.27 hectares of prime rural land offering endless possibilities
- Sustainable living features including water tank and grey water system
- Multiple outdoor structures perfect for rural lifestyle and storage needs
- Domestic bore a feature a lake/dam that supplies water for irrigation to farming parcel
- Air conditioning throughout
- Built-in wardrobes

Located in the Bundaberg Region, Eureka offers the perfect balance of rural tranquility and regional accessibility.

While Eureka itself maintains its peaceful rural character, families have access to quality education options in nearby Childers, including Childers State School and Isis District State High School. The proximity to Childers also provides access to shopping, medical facilities, and other essential services without sacrificing the rural lifestyle you desire.

- Convenient access to Childers for education and services
- Ideal location within the productive Bundaberg Region

This thoughtfully designed home showcases country living with four generous bedrooms and two well-appointed bathrooms. The property features built-in wardrobes for ample storage and modern conveniences including a dishwasher and air conditioning to ensure year-round comfort. The rural aspect provides beautiful views across the expansive landscape, creating a sense of space and serenity that's hard to find elsewhere.

4 BED | 2 BATH | 4 CAR

PRICE:

\$2,100,000 with expression of interest considered

OPEN FOR INSPECTION:

N/A



Kristina Georges

0499938838

kristinageorges@atrealty.com.au

www.atrealty.com.au

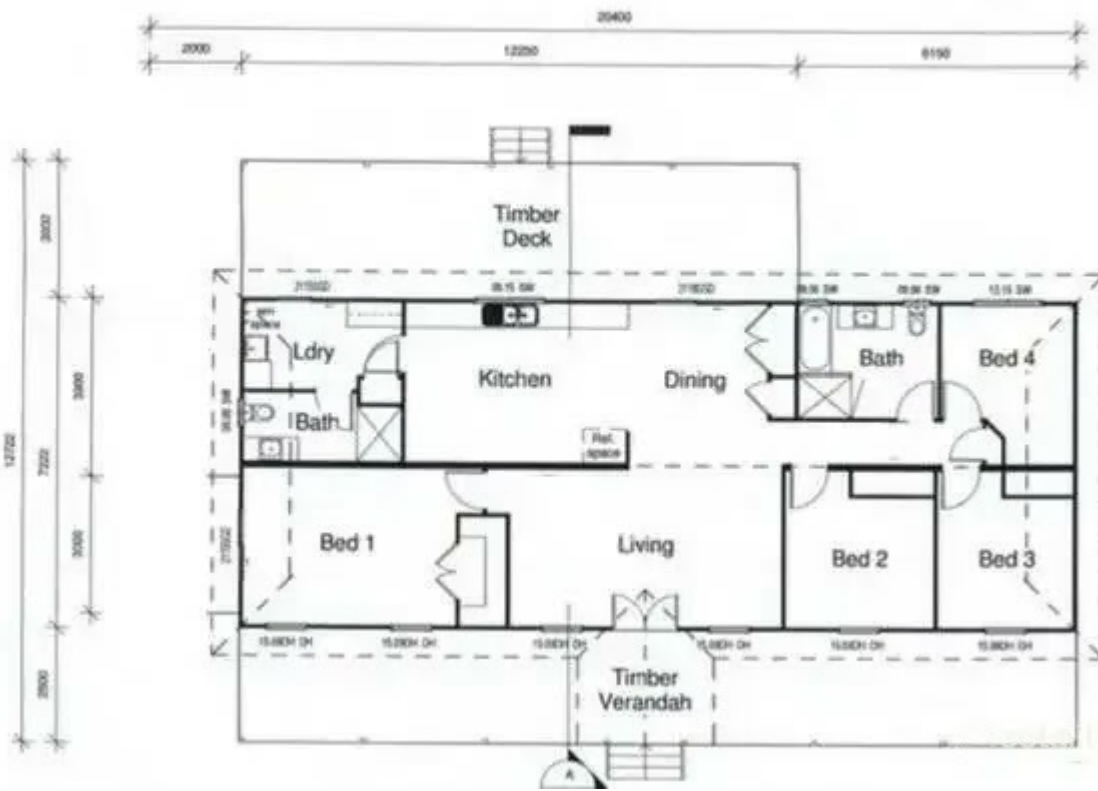

Disclaimer: Please note this floor plan is for marketing purposes and is to be used as a guide only. All dimensions are estimates only and may not be exact measurements.