



FOR SALE

MOVE IN READY: CENTRE UNIT WITH HARBOUR VIEWS – RESORT-STYLE LIFESTYLE

This charming upmarket apartment living awaits at 'The Sentinel,' where style meets comfort in a truly privileged location. This centre unit offers a rare opportunity to secure a home that combines effortless living with stunning vistas. From the moment you step inside, the sense of space, light, and tranquility is immediately evident, creating an environment designed for both relaxation and entertaining. This beauty has just been freshly painted inside and will impress. Located on level 3 allowing sea views over the tree tops. This complex also has two lifts for convenience.

Enjoy uninterrupted sea views and sunsets of Darwin Harbour and Bicentennial Gardens from the comfort of your large balcony, or unwind in the resort-style saltwater pool. Every detail has been considered to provide a lifestyle of refinement, convenience, and effortless enjoyment, all within a location that is highly sought after and rarely available.

Property Highlights:

- Rarely available centre unit
- Exceptional views of Harbour and Bicentennial Gardens
- Spacious living and dining areas flowing to a large balcony
- Three generous bedrooms and two bathrooms
- Two dedicated car parks
- Fully tiled and air conditioned throughout
- Storeroom for extra storage
- Resort-style saltwater pool
- Secure complex

This is a unique chance to embrace a lifestyle of tranquility, sophistication, and effortless indoor-outdoor living. Do not miss the opportunity to make this exceptional apartment your own.

Additional Information:

- Year Built: 1999
- Status: Vacant possession – ready for you to move in immediately.
- Body Corp Manager: Ace Body Corporate
- Total Body Corporate Fees (approx.): \$3750 per quarter

3 BED | 2 BATH | 2 CAR

PRICE:
\$799,000

OPEN FOR INSPECTION:
Apr 4 at 1:00pm - 1:15pm



Nicole Wheeler
0417508800
nicolewheeler@atrealty.com.au
www.atrealty.com.au

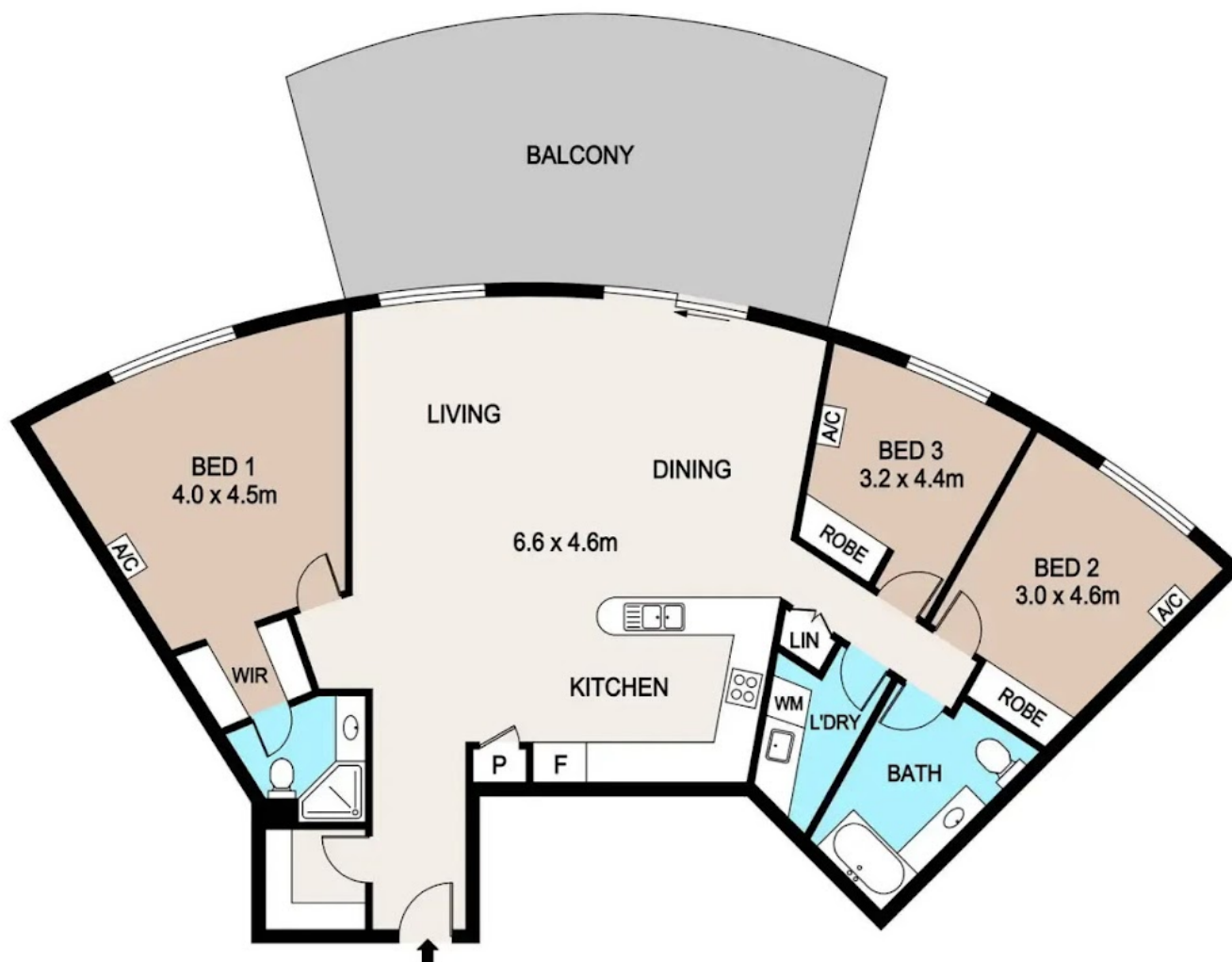

18/1 DALY STREET, LARRAKEYAH, NT, 0820

Disclaimer: Please note this floor plan is for marketing purposes and is to be used as a guide only. All dimensions are estimates only and may not be exact measurements.