

43 MONTICELLO KEY,
PAPAMOA BEACH, TAURANGA, BAY OF

YOUR PROPERTY 

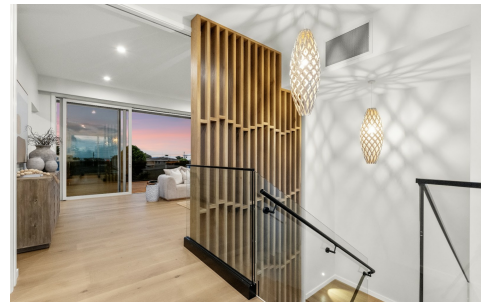

FOR SALE

COASTAL MASTERPIECE, JUST MOMENTS FROM THE BEACH

5  | 3  | 2 

Set against a dazzling coastal backdrop, this luxurious new home situated on a highly desirable, well-established cul de sac sits close to shoreline and surf. Capturing wide panoramas of the Pacific Ocean and Papamoa Hills, a simple linear aesthetic influences the architecturally designed 345 sqm (approx.) residence complete with layout suited to multigenerational families or guests.

A full-length balcony featuring a strip-lit Alaskan Cedar soffit, offers a dress circle rendezvous for alfresco dining and sundowner drinks. The flush, sill stackable sliders separate the balcony from a bespoke media room and spacious open plan living and dining areas. The engineered oak flooring extends to a customised gourmet kitchen with scullery where high-quality cabinetry, porcelain benchtops, and state of the art appliances dominate. A central American White Oak stairwell atrium capturing picturesque vistas, features iconic David Trubridge fittings. Three underfloor-heated, porcelain-tiled bathrooms are supported by a separate powder room. The ensuite and powder room feature LED backlit mirrors, while monsoon shower systems are included in the guest bathroom and master ensuite. Five bedrooms include a substantial master suite upstairs while downstairs, the guest area shares a third lounge with a chic galley kitchenette and pantry. This assigned domain benefits from exterior flow to wide decking and fenced lawns (with room here for a pool.) The energy-efficient high-tech residence with elevator between floors, has temperature-controlled ducted heating and cooling, gas fireplace, extensive insulation, and Low-E thermal glazing in upper floor entertainment zones for year-round comfort.

Nicholas Meloni | 0275544898 | nicholas@yourpropertyhq.co.nz | yourpropertyhq.co.nz

@realty Limited Licensed REA 2008

PRICE: Asking price \$2,795,000

OPEN FOR INSPECTION: Apr 19 at 1:30pm - 2:00pm

