



SOLD

SPACIOUS ST GEORGES BASIN FAMILY HOME

Wright Way Realty Jervis Bay proudly presents an exceptional coastal opportunity. Positioned on a generous 773sqm parcel in the highly desirable enclave of St Georges Basin, this impressive four-bedroom home at 7 Claylands Drive delivers space, comfort, and relaxed seaside living. Located just 25 kilometres south of Nowra and only moments from the crystal-clear waters of the Basin, this residence offers an outstanding lifestyle for families and sea-changers alike.

- @ Spacious and well-designed home offering 214sqm of living space
- @ Excellent street appeal with side access and a peaceful reserve at the rear
- @ Enjoy a leisurely 500-metre stroll to the pristine shoreline of St Georges Basin
- @ Light-filled central kitchen with gas cooking and wall ovens
- @ Two expansive living zones, ideal for entertaining or quiet retreat
- @ Generous master suite with walk-in robe and private ensuite
- @ Additional bedrooms with built-in wardrobes for seamless storage
- @ Family bathroom featuring spa bath, separate shower, and separate toilet
- @ Solar hot water provides an eco-friendly solution with ongoing savings
- @ Split-system air conditioning, abundant storage, and year-round comfort
- @ Step outside to a private outdoor haven, creating a tranquil, island-like atmosphere
- @ Ideal for growing families, downsizers seeking peace and privacy, or those wanting to embrace the coastal lifestyle without compromise, this outstanding home is one not to miss.
- @ Contact Glenn today to arrange your inspection.

4 BED | 2 BATH | 2 CAR

PRICE:
\$880,000

OPEN FOR INSPECTION:
N/A



Glenn Wright
0408120866
glenn.wright@atrealty.com.au
Wright Way Realty

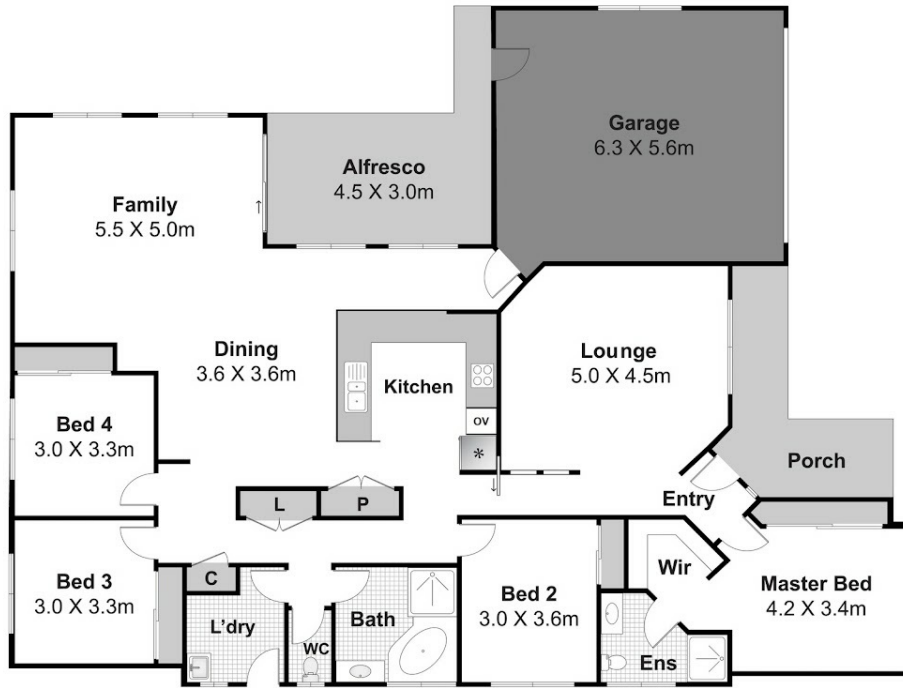

7 Claylands Drive, ST GEORGES BASIN



Scale is in Metres & indicative only & dimensions are only approximate.
 The information contained & gathered herein is we believe from sources to be reliable.
 We can not guarantee it's accuracy & persons should rely on their own enquiries.



Disclaimer: Please note this floor plan is for marketing purposes and is to be used as a guide only. All dimensions are estimates only and may not be exact measurements.