



SOLD

STEP INTO ELLERSLIE

Marking its first appearance on the market in three decades, this solid brick and tile unit in a private block of four represents reliable 1960s craftsmanship in one of Ellerslie's most sought-after locations.

Natural light floods through both double bedrooms, each featuring built-in wardrobes, while the thoughtfully designed layout maximises the 60 square metre floor area. The functional kitchen connects to a sun-drenched lounge that flows onto a sunny porch, perfect for morning coffee with easy access to the front garden area.

Located in a quiet street in the heart of Ellerslie, you'll enjoy everything this historic suburb offers. Known as Auckland's racing capital, the area features the famous Ellerslie Racecourse nearby, excellent schools and convenient transportation with the train station providing direct city access.

- Allocated carport with small storage shed
- Proximity to Michaels Avenue Reserve with playground and sports facilities
- Walking distance to revitalised town centre with cafes and local services
- Easy Southern Motorway access.

The unit is currently rented to a lovely long term tenant. Whether you're a first-home buyer, downsizer, or investor, this property presents an exceptional opportunity in a suburb where such offerings are increasingly rare.

Call Paula now to arrange a private viewing or attend one of our scheduled open homes.

2 BED | 1 BATH | 0 CAR

PRICE:
\$620,000

OPEN FOR INSPECTION:
N/A



Paula Ihaka
0204778874
paula@reality.co.nz
www.atreality.co.nz

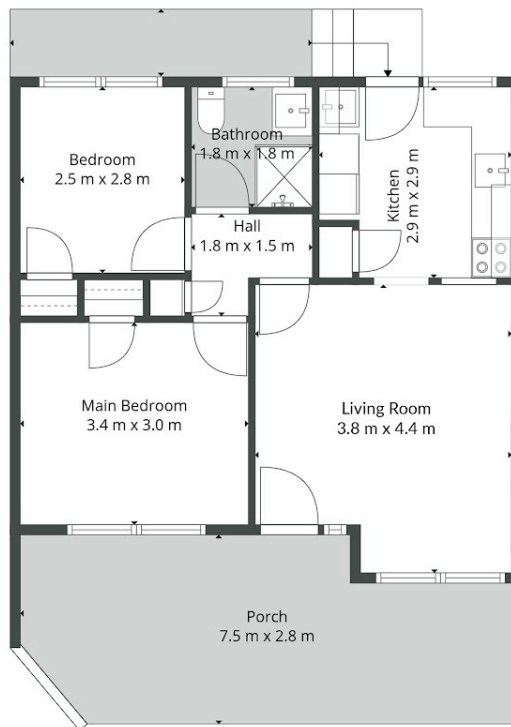
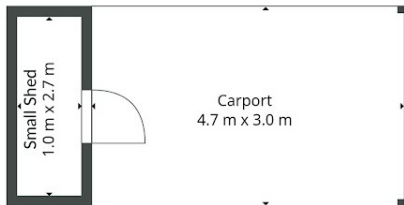

Sizes And Dimensions Are Approximate, Actual May Vary.



PAULA FERREIRA
real estate



Disclaimer: Please note this floor plan is for marketing purposes and is to be used as a guide only. All dimensions are estimates only and may not be exact measurements.