



SOLD

ACREAGE LIVING MINUTES TO TOWN WITH DUAL LIVING!!

Hugged by rolling hillside and set on approximately 2 hectares of cleared Royston land, this property offers the perfect combination of tranquility, space, and convenience. Just 10 minutes from Woodford's cafes, shops, and city-bound trains, it's ideal for families seeking room to grow, professionals wanting a peaceful retreat, or anyone dreaming of a lifestyle where the countryside meets practicality.

This fully renovated two-storey home has been designed for family living, entertaining, and multi-generational comfort. It features six spacious bedrooms and three bathrooms, including a master suite with walk-in robes, a twin-vanity ensuite, clerestory window, and a private balcony overlooking the pool. The U-shaped kitchen is the heart of the home, complete with sleek cabinetry and a large pantry perfect for bulk storage. Light-filled open plan living and dining areas, a sunroom and rumpus space provide flexibility for family life, while the lower level includes additional bedrooms, a full bathroom, laundry, and direct access to the outdoor entertaining areas. Outside, a covered timber-edged area and fenced pool create the perfect space for gatherings, while the 4-bay shed with self-contained granny flat offers versatility for guests, hobby storage, or rental income. Water security is guaranteed with two large tanks fed by a windmill-sourced spring.

Features and highlights include:

- 6 bedrooms and 3 bathrooms with dual living options
- Master suite with walk-in robes, ensuite and private balcony
- Fully renovated, two-storey home with refined country finishes
- U-shaped kitchen with large pantry for storage
- Open plan living, dining, sunroom and rumpus areas
- Lower level with additional bedrooms, bathroom and laundry
- Covered timber-edged entertaining areas and fenced pool
- 4-bay shed with self-contained granny flat
- Two large water tanks with windmill-fed spring water
- Plenty of space for horses, hobbies and outdoor activities
- Approximately 2 hectares (nearly 5 acres) of usable land
- Tranquil rural outlooks with surrounding rolling hills

6 BED | 3 BATH | 14 CAR

PRICE:
\$1,660,000

OPEN FOR INSPECTION:
N/A



Paige Creedon
0413402110
paige@creedonpropertygroup.com
creedonpropertygroup.com

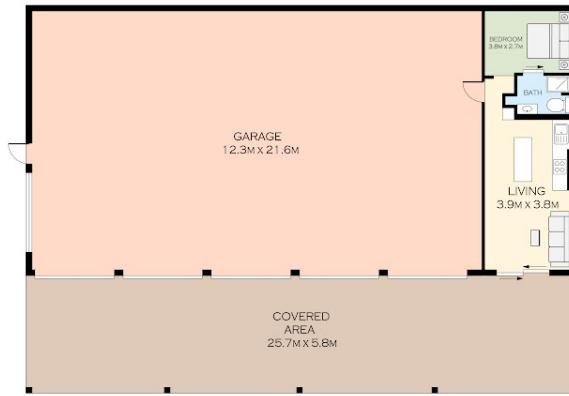

Disclaimer: Please note this floor plan is for marketing purposes and is to be used as a guide only. All dimensions are estimates only and may not be exact measurements.