



SOLD

A PRIVATE FAMILY OASIS ON OVER 900M²

Set in a quiet, family-friendly street on an impressive 900m²+ block, this beautifully presented home is a true credit to its owners. From the picturesque gardens to the thoughtful layout, it's clear this home has been loved and meticulously maintained.

Designed for relaxed family living and effortless entertaining, the home offers multiple living areas, generous outdoor spaces and a stunning pebblecrete saltwater pool (approx. 9m x 4.5m).

Key features include:

- Two bathrooms within the main home, including a recently renovated bathroom with quality fixtures and fittings
- A separate sleep-out with its own full bathroom, ideal as a fifth bedroom, guest accommodation or home office
- Multiple living zones perfect for growing families
- Covered entertaining deck overlooking the landscaped gardens and pool
- Quality double carport with additional space behind and convenient side access
- Established, landscaped gardens supported by a 5,000-litre water tank

The location is equally impressive, with waterfront, cycleways and local shops just a short walk away, and schools, cafés, beaches, medical facilities and the M1 Motorway only minutes from your door.

Homes offering this level of space, lifestyle and versatility are rarely available and never last long.

For more information or to arrange a private inspection, contact Brad Barker on 0413 875 833.

4 BED | 3 BATH | 3 CAR

PRICE:
\$1,115,000

OPEN FOR INSPECTION:
N/A



Brad Barker
0413875833
bradbarker@atrealty.com.au
www.atrealty.com.au

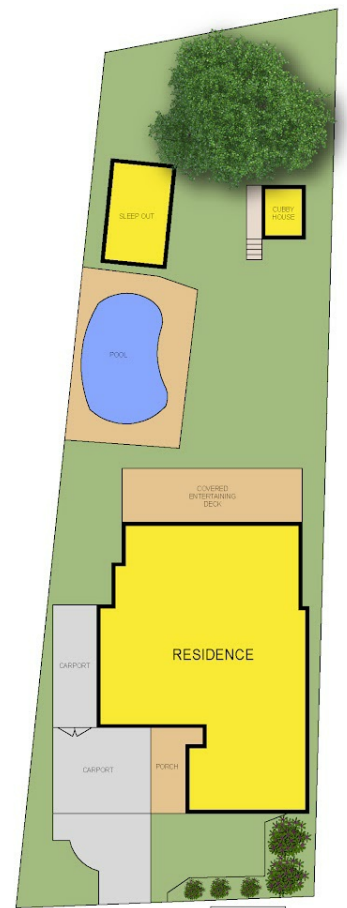
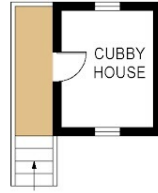
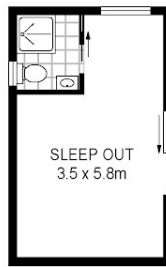

10 Moola Road
Buff Point



Total Internal Floor Area: 166 sqm

Scale in metres. Indicative only. Dimensions are approximate. All information contained herein is gathered from sources we believe to be reliable. However we cannot guarantee its accuracy and interested persons should rely on their own enquiries



Disclaimer: Please note this floor plan is for marketing purposes and is to be used as a guide only. All dimensions are estimates only and may not be exact measurements.