



Sold

3  | 1  | 4 

15 GREVILLEA DRIVE, REDRIDGE, QLD, 4660



ACREAGE LIVING WITH THE FAMILY POOL

This charming 3-bedroom weatherboard home at 15 Grevillea Dr, Redridge offers a blissful retreat, perfect for families or retirees seeking a spacious acreage lifestyle. Boasting 2.02 hectares (4.99 acres) of lush semi flat land, the property is surrounded by elegant white post and rail boundary fencing. Featuring an inground saltwater pool for leisurely dips on the warmer days, the low-maintenance yard and gardens ensure your time is spent enjoying the acreage lifestyle with family.

The residence is complemented by a multitude of practical features, including a 2-bay lockable garage with a workshop, additional carport space for two more vehicles, and a garden shed for all your outdoor storage needs. Power and water are conveniently provided to the main shed.

Property Features Include:

- 2.02 Hectares / 4.99 Acres
- Completely fenced yard with separate rear paddock
- 2 bay lockable garage plus workshop with power and water plus a separate Garden shed
- 2 bay carport
- Inground saltwater pool
- NBN service
- 3x bedrooms, 1x bathroom / 2 way into laundry & separate toilet
- House set back off the road
- Tiled throughout
- Front & rear under-covered patio's

PRICE:
\$650,000

OPEN FOR INSPECTION:
N/A

Ty Dan // 0437226831

ty@widebayregionalestate.com.au // www.widebayregionalestate.com.au



Sold

3  | 1  | 4 

15 GREVILLEA DRIVE, REDRIDGE, QLD, 4660

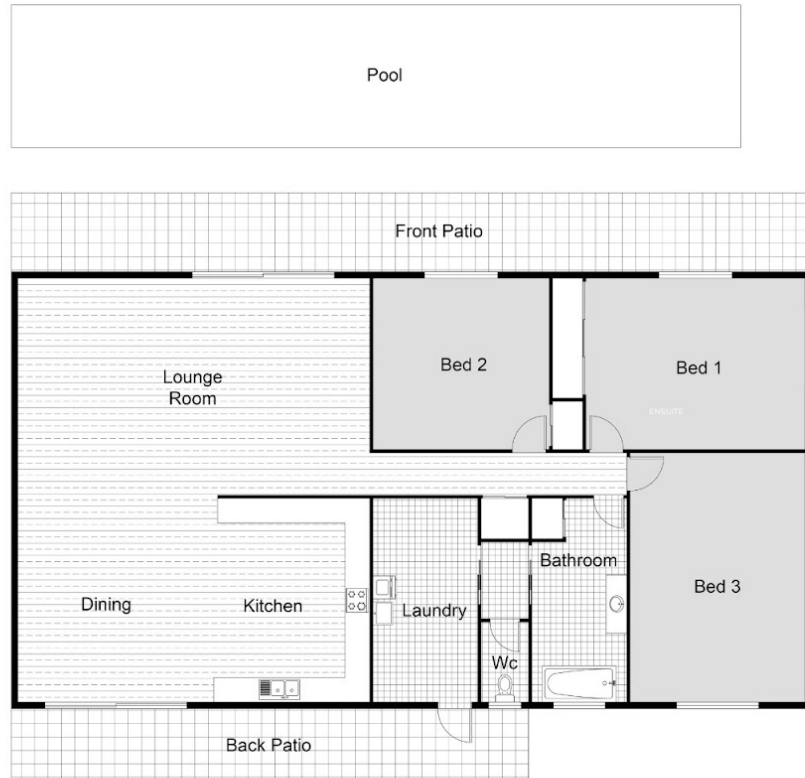

FLOOR PLAN

15 Grevillea Dr, Redridge Q 4660

The floor plan included in this marketing material is for illustration purpose only, all measurements are approximate and is the intended artists impression only.

Ty Dan // 0437226831

ty@widebayregionalestate.com.au // www.widebayregionalestate.com.au