

FOR SALE

FIRST FLOOR APARTMENT - GREAT PRICE – GREAT LOCATION – GREAT FOR FIRST HOME OR INVESTMENT!!

Tucked away at the rear of the complex, this North-East facing apartment enjoys a peaceful location, whilst still being close to everything.

The first floor, one bedroom apartment would suit owner occupiers, investors, or a first home buyer.

The kitchen is tucked back in the open plan living and dining areas, has ample storage, a floor-to-ceiling pantry, white appliances, and space for a larger fridge freezer. The open plan living and dining area has a split system, reverse-cycle air conditioning unit, and patio doors out to a sunny balcony. Just sit back and relax with your morning coffee or a glass of wine. The bedroom benefits from large windows with views over the rooftops and trees, and gives the apartment great cross ventilation, double, mirrored fronted built-in wardrobes and a ceiling fan.

The sunny pool area is beautifully maintained and is perfect for unwinding after a long day or enjoying a BBQ with friends and family.

Features Include

- Open plan, spacious lounge, separate dining, and kitchen areas
- Spacious bathroom with laundry
- Split system air-conditioner in living room
- Open plan kitchen with breakfast bar
- Sparkling pool in complex with BBQ area
- Private terrace
- 1 Secure gated underground parking space & gated entry, state-of-the-art security
- Small boutique complex

For the Investor:

- Currently tenanted until August 28th 2026
- Tenant paying \$520pw

1 BED | 1 BATH | 1 CAR

PRICE:
UNDER OFFER

OPEN FOR INSPECTION:
N/A



Francine Setchell
0408143464

francine@atrealty.com.au
www.atrealty.com.au

Unit 20, 217-219 Scarborough Street, Southport

1 Bed 1 Bath 1 Car

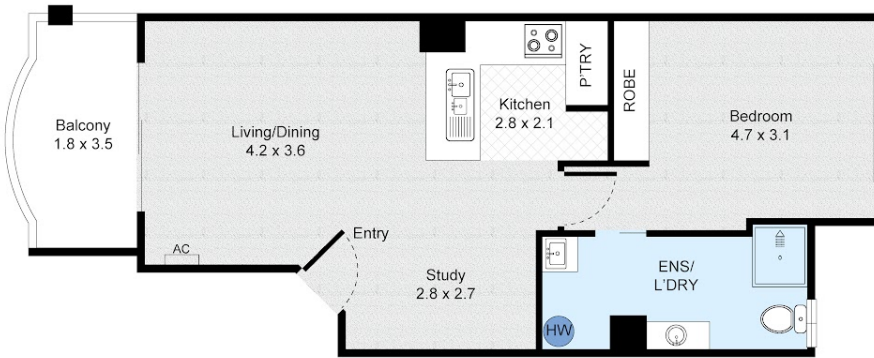

FLOOR PLAN

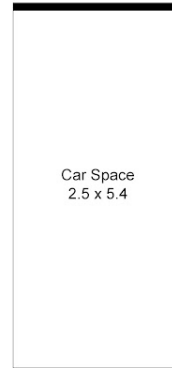

(Not In Position)

CAR SPACE

Internal : 50m²
Balcony : 06m²
Car Space : 13m²
Total : 69m²

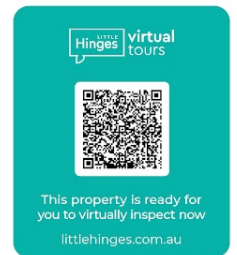

All information contained herein is gathered by Little Hinges. Whilst the scanning technology is highly reliable, we cannot guarantee its accuracy and interested parties should rely on their own enquiries.

Disclaimer: Please note this floor plan is for marketing purposes and is to be used as a guide only. All dimensions are estimates only and may not be exact measurements.

Francine Setchell
0408143464
francine@atrealty.com.au
www.atrealty.com.au

