

16 JENKIN AVENUE, WONTHAGGI, VIC, 3995

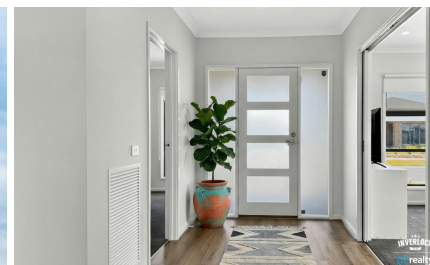

**SOLD**

## ROOM TO BREATHE, ROOM TO LIVE

Some homes simply have it all — and 16 Jenkin Avenue is one of them. Freshly completed and immaculately presented in the sought-after Parklands Estate, this five-bedroom residence delivers the kind of space, quality, and flexibility that growing families and down-sizers alike have been searching for.

Whether you're making the move to the Bass Coast for a better pace of life, or looking for the perfect base to host the grandkids in comfort, this home answers the brief beautifully. From the moment you arrive, the contemporary facade sets the tone — clean lines, a refined neutral palette, and a fully landscaped and concreted block that is as low-maintenance as it is good-looking. The expansive corner block position is a genuine point of difference, offering sliding gate access at the rear — ideal for securing the boat, caravan, or trailer out of sight and off the street. Everything has been thought through, and nothing has been left to chance. Inside, the home is defined by its generous proportions and intelligent layout. Two distinct living zones create natural separation — one for the main household, and one that adapts effortlessly to a teenage retreat, home office, or a self-contained space for visiting family. With five bedrooms across the floorplan, there is room for everyone to spread out without compromise. The master suite is a private sanctuary, complete with a walk-in robe and well-appointed ensuite, while the remaining bedrooms are serviced by quality shared bathrooms and feature quality shade and blackout blinds throughout — ensuring every room is comfortable year-round. At the heart of the home sits a kitchen that means business. Designed for real family life, it features a huge walk-in pantry — the kind of storage space that actually makes a difference day to day — quality appliances, sleek cabinetry, and generous bench space that makes cooking for a crowd genuinely enjoyable.

Year-round liveability is taken care of by the fully undercover entertainer's deck, complete with ziplock blinds that transform the space into an all-weather room — perfect for morning coffees in July or long summer lunches with extended family. Ducted heating and cooling throughout ensures the interior is equally comfortable whatever the season brings.

Parklands Estate is one of Wonthaggi's most appealing newer communities — a thoughtfully designed neighbourhood with easy access to the town centre, schools, medical services, and the stunning coastline that makes Bass Coast living so coveted. Inverloch, Cape Paterson, and the broader region's beaches and trails are all within easy reach.

This is a home built for living — generously, comfortably, and without compromise.

**5 BED | 2 BATH | 2 CAR**

**PRICE:**  
\$740,000

**OPEN FOR INSPECTION:**  
N/A



**Leo Edwards**  
**0472523445**  
leo@atrealty.com.au  
[www.atrealty.com.au](http://www.atrealty.com.au)

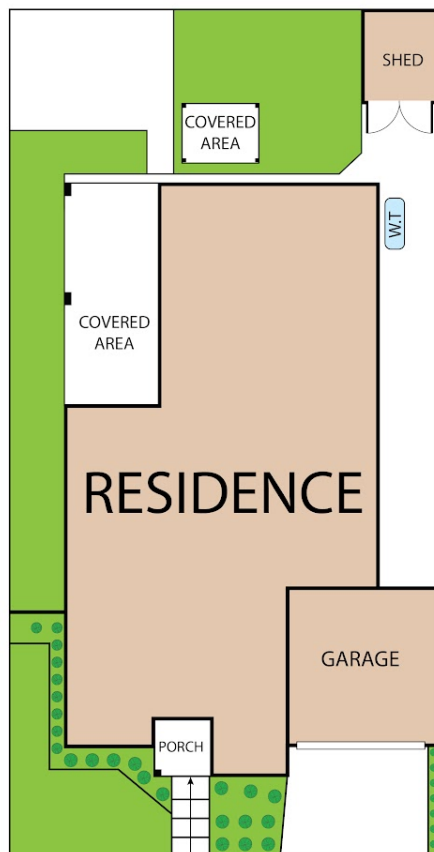
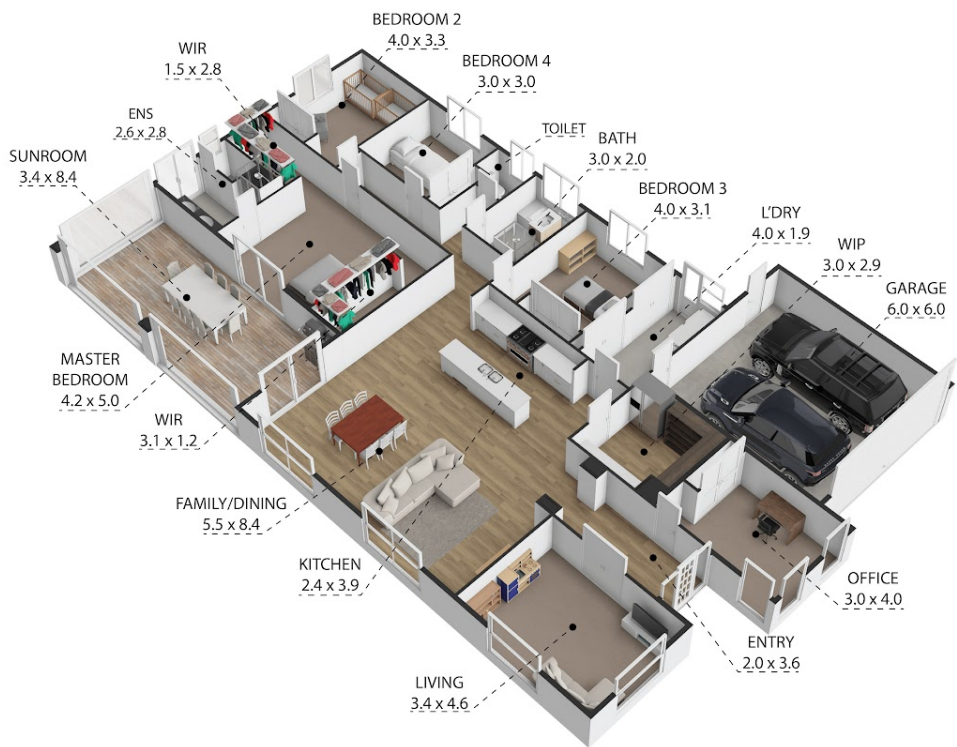

16 Jenkin Avenue, Wonthaggi, VIC, 3995

TOTAL APPROX. FLOOR AREA 267 SQ.M

Whilst every attempt has been made to ensure the accuracy of the floor plan contained here, measurements of doors, windows, rooms and any other items are approximate and no responsibility is taken for any error, omission, or misstatement. This plan is for illustrative purposes only and should be used as such by any prospective purchaser.

**INVERLOCH**  
RESIDENT

@realty

Disclaimer: Please note this floor plan is for marketing purposes and is to be used as a guide only. All dimensions are estimates only and may not be exact measurements.

Leo Edwards  
0472523445  
leo@atrealty.com.au  
www.atrealty.com.au

@realty