



FOR SALE

NORTH-FACING SORRENTO TOWNHOUSE WITH DESIGNER KITCHEN & PRIVATE STREET ACCESS

Perfectly positioned in the highly sought-after Sorrento precinct, this beautifully presented townhouse offers the perfect blend of privacy, lifestyle and effortless entertaining in one of the most desirable pockets of Bundall.

Thoughtfully designed for modern living, the home is centred around a stunning open-plan kitchen.

This is not just any kitchen, this one has been custom made with bespoke cabinetry and custom engineered stone that is thicker than your everyday off the shelf stone bench tops. Showcasing the sophisticated, light-toned natural stone aesthetic and offers strong resistance to stains, scratches, heat and durability to be enjoyed by your family for many years to come. Optimising functionality and connectivity with the dining and living areas. This clever layout creates an inviting space where family and guests can cook, dine and relax together while remaining engaged in the heart of the home.

The soaring ceilings provide a feeling more akin to a freestanding home offering that wow experience every time you walk into the main living areas.

Natural light floods the property thanks to the highly prized north-facing orientation, while the private courtyard provides a tranquil outdoor retreat. Framed by lush hedging for privacy and a sense of opulence, it is the perfect setting for morning coffee, long lunches or evening entertaining in the beautiful Gold Coast climate.

Adding to the uniqueness of the home is the rare private access directly from Freyburg Street, offering a level of convenience and independence rarely found in townhouse living.

Positioned within a tightly held complex in the prestigious Sorrento neighbourhood, this property places you just minutes from the vibrant lifestyle attractions the Gold Coast is renowned for, world-famous beaches, sought after dining hot spots, shopping and entertainment.

2 BED | 2 BATH | 2 CAR

PRICE:

Unconditional \$1,155,000

OPEN FOR INSPECTION:

N/A



Chris Cramp

0452032022

chris.cramp@atrealty.com.au

www.atrealty.com.au

Ground Floor

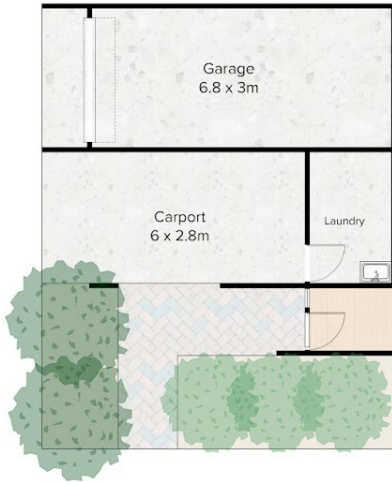

First Floor



Mezzanine



CHRIS CRAMP | 0452 032 022

7/9 Freyburg street,
Sorrento

Internal area approx: 134m²
External Area approx: 75m²
Total area approx: 209m²



Whilst every attempt has been made to ensure the accuracy of the floor plan contained here, measurements of floors, windows, rooms and any other items are approximate and no responsibility is taken for error, omission or mis-statement. This plan is for illustrative purposes only and should only be used as such by any prospective purchaser.

Disclaimer: Please note this floor plan is for marketing purposes and is to be used as a guide only. All dimensions are estimates only and may not be exact measurements.

Chris Cramp
0452032022
chris.cramp@atrealty.com.au
www.atrealty.com.au

