



# FOR LEASE

## SPACIOUS FAMILY HOME

This ideal family home is located at Springfield Lakes, It's in close proximity to take advantage of everything the area has to offer including parks, recreational areas, Mater Hospital and Orion Shopping Centre and close to the train station. The home features four bedrooms, the master bedroom has its own walk-in robe, ensuite and air conditioning, all the bedrooms have carpeted with fans and built-in robes.

### Property Features:

- \* Three bedrooms (all built-in)
- \* Master bedroom with ensuite and walk-through robe
- \* Fourth bedroom/teenagers retreat with ensuite downstairs - perfect for a teenager, parent or home office
- \* Modern kitchen with stone bench tops, gas stove, and dishwasher
- \* Family room/meals area and separate lounge
- \* Split system air conditioning
- \* Covered front verandah with local views and rear under roof timber deck
- \* Double remote lock-up garage

Contact today @0423 914 330 to organise private inspection or scheduled Open Home

Disclaimer- All information contained herein is gathered from sources we believe to be reliable. However we cannot guarantee its accuracy and interested persons should rely on their own enquiries.

4 BED | 3 BATH | 4 CAR

**PRICE:**  
\$680 per week

**OPEN FOR INSPECTION:**  
N/A



**Gagan KC**  
**0423914330**

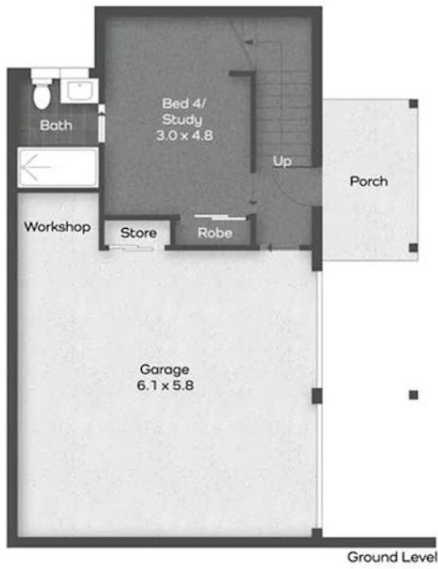

[gagan.primeestategroup@atrealty.com](mailto:gagan.primeestategroup@atrealty.com)  
[www.atrealty.com.au](http://www.atrealty.com.au)



**PROPERTY ADDRESS**

12 Horizon Drive  
Springfield Lakes, Qld 4300

**PROPERTY DETAILS**

-  - 4 Bed
-  - 3 Bath
-  - 2 Car

**PROPERTY FLOOR PLAN SIZE**

Approx. floor plan area is 213m<sup>2</sup>

Disclaimer: Please note this floor plan is for marketing purposes and is to be used as a guide only. All dimensions are estimates only and may not be exact measurements.