



**SOLD**

## FULLY RENOVATED QUEENSLANDER WITH SWEEPING MOUNTAIN VIEWS AND AN ENORMOUS DECK

Perfectly positioned on a 1,012 m2 block in Gympie's Medical Precinct, this beautifully renovated Queenslander delivers the charm of a classic home with the comfort, scale, and finish of modern living. Just moments from the hospital and within easy reach of the centre of town, this is a property that offers both lifestyle and convenience. With Specialised Centre zoning, there may also be added flexibility and future potential here, subject to council approval.

- Fully renovated Queenslander on a 1,012 m2 block
- Four bedrooms including a huge master suite with ensuite
- Beautiful VJ walls and high ceilings
- Polished timber floors
- Ducted air conditioning throughout
- Ceiling fans throughout
- Cosy wood heater
- Spacious open plan living plus separate lounge
- Stylish kitchen with premium Smeg cooker
- Quality cabinetry and excellent bench space
- Double doors opening onto the entertaining deck
- Enormous covered deck with sweeping mountain views
- The perfect spot for sunsets and storm watching
- Beautifully renovated bathrooms
- Well designed internal laundry
- Attached lock up garage plus separate single lock up garage
- Backyard access with room for more
- Positioned close to the hospital and within walking distance to the heart of town
- Located within the Gympie Medical Precinct with Specialised Centre zoning and potential upside STCA

From the moment you step inside, the home feels generous in every sense. High ceilings, oversized living spaces, and warm timber floors create an inviting feel, while the renovation throughout has been completed with real style and quality in mind. The kitchen is a standout,

**4 BED | 2 BATH | 2 CAR**

**PRICE:**  
\$890,000

**OPEN FOR INSPECTION:**  
N/A



**Chris Gablonski**  
**0408708271**  
gabba@atrealty.com.au  
[www.atrealty.com.au](http://www.atrealty.com.au)

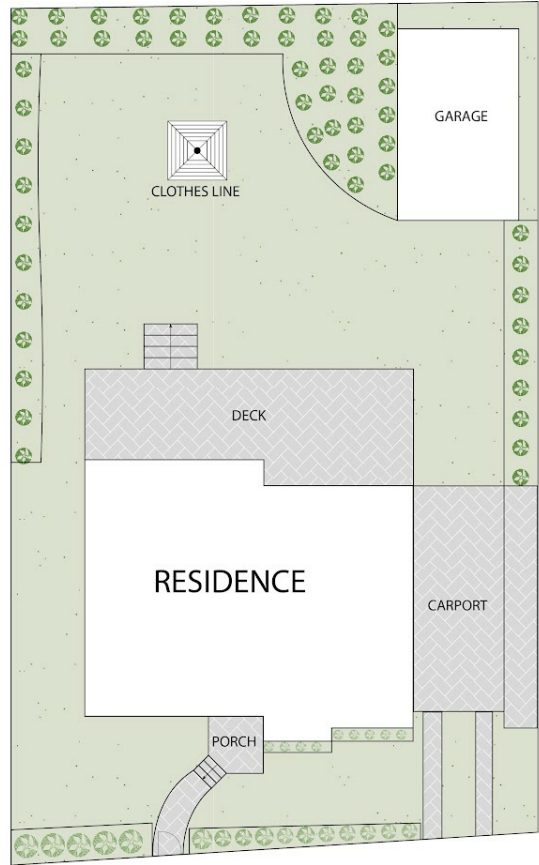

31 Jane Street, Gympie, Queensland, 4570  
 TOTAL APPROX. FLOOR AREA 154 SQM  
 Whilst every attempt has been made to ensure the accuracy of the floor plan contained here, measurements of doors, windows, rooms and any other items are approximate and no responsibility is taken for any error, omission, or misstatement.  
 This plan is for illustrative purposes only and should be used as such by any prospective purchaser.

Disclaimer: Please note this floor plan is for marketing purposes and is to be used as a guide only. All dimensions are estimates only and may not be exact measurements.