

# FOR SALE

## STOP VISITING. START LIVING.

Three levels. Five bedrooms. Protected ocean views stretching all the way to Wilsons Promontory. And not a single neighbour who will ever build in front of them.

This is the home you redesign your life around.

Thoughtfully designed in 2006, 19 Wheeler Road sits on the edge of Cape Paterson where Pea Creek bush meets the Bass Strait coastline — and where both the Bunurong Marine National Park and the State Coastal Bush Reserve ensure the panoramic views of open ocean and ancient bush remain yours, permanently, by an act of government. You're not just buying a view. You're buying its future.

The home is designed to be lived in across three intelligently planned levels, each with its own character and purpose. At ground level, an open-plan kitchen with stone bench tops and Bosch appliances anchors a generous family and dining space that flows out to a landscaped garden patio — the kind of layout that works just as well for Tuesday dinner as it does for a long weekend with family down from the city. Three bedrooms complete this floor, including a master with a full walk-in dressing room, and a separate multipurpose laundry with shower, second WC and direct outdoor access.

Above, the mid level transforms the idea of what a living space can be. Spanning the full width of the home, with floor-to-ceiling glass along the entire frontage, it opens onto a tiled balcony and an all-weather alfresco that together put roughly 75 square metres of outdoor living at your disposal — sheltered, sea-facing and usable across every season. On still mornings, the sound of the ocean drifts up from the Bunurong Marine Park below. On rough days, you watch the Bass Strait put on a show from complete comfort. Two further bedrooms with ensuites and a spa bath occupy this level, offering genuine separation for guests, adult children, or a home office set-up that would make the Monday commute to the city feel increasingly absurd.

At the top, a glass-enclosed observatory — reached via a hand-crafted marine-style spiral staircase — delivers the property's signature moment. Whether you're reading, working, or simply watching the light move across the Prom, this is a room that justifies the decision every single time.

Outside, 903 square metres of established gardens with drip irrigation, lawn sprinklers and 12,600 litres of water storage handle themselves. A three-bay garage and workshop — an increasingly rare asset on the Bass Coast — accommodates the tools, bikes, kayaks and gear that come with living here properly, not just visiting.

Safe swimming and surf beaches are a short walk in either direction. Walking trails through State Forest begin at the fence line. Tennis courts, boat ramps, quality local schools, and the services of Wonthaggi are within easy reach — as is Inverloch, for those who prefer their café culture

5 BED | 4 BATH | 4 CAR

PRICE:  
\$1,395,000

OPEN FOR INSPECTION:  
N/A



**Leo Edwards**  
0472523445  
leo@atrealty.com.au  
[www.atrealty.com.au](http://www.atrealty.com.au)

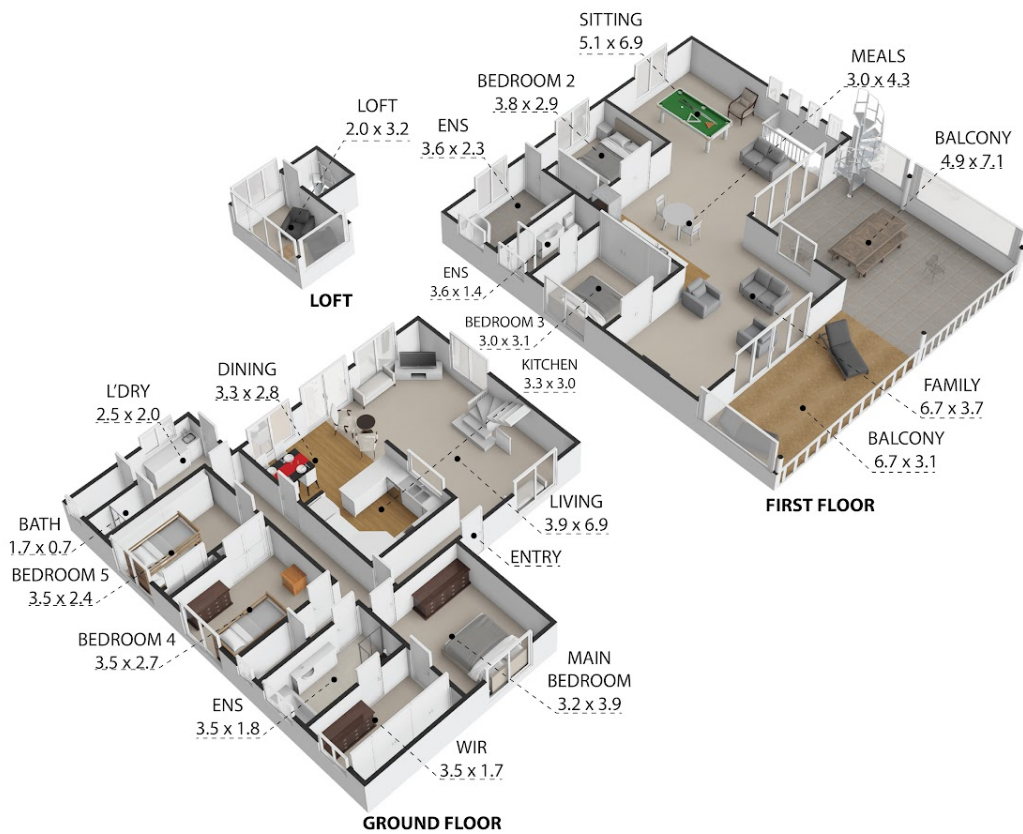
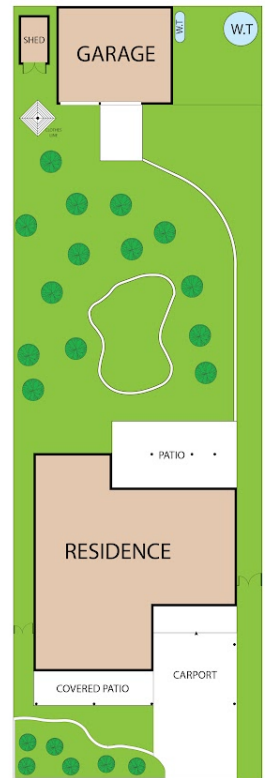

19 Wheeler Road, Cape Paterson, VIC, 3995

TOTAL APPROX. FLOOR AREA 233 SQ.M

Whilst every attempt has been made to ensure the accuracy of the floor plan contained here, measurements of doors, windows, rooms and any other items are approximate and no responsibility is taken for any error, omission, or misstatement. This plan is for illustrative purposes only and should be used as such by any prospective purchaser.

**INVERLOCH**  
RESIDENTIAL

@realty

Disclaimer: Please note this floor plan is for marketing purposes and is to be used as a guide only. All dimensions are estimates only and may not be exact measurements.

Leo Edwards  
0472523445  
leo@atrealty.com.au  
www.atrealty.com.au

@realty