

23 NOUVEL CRESCENT, CORINELLA, VIC, 3984



FOR SALE

DESIGNER COASTAL LIVING OPPOSITE PARKLANDS – MOVE-IN READY LUXURY

Positioned in the heart of the charming seaside township of Corinella, 23 Nouvel Crescent presents an exceptional opportunity to secure a quality, move-in-ready home built by renowned SJD Homes. Showcasing a seamless blend of style, comfort, and functionality, this beautifully appointed residence delivers a premium lifestyle just moments from the coast. Step inside and immediately appreciate the elevated finishes, including high ceilings, decorative cornices in the main living area, and oversized doors that enhance the sense of space throughout. Designed for year-round comfort, the home features refrigerated heating and cooling, double-glazed windows, and elegant plantation blinds that add both style and practicality.

At the heart of the home lies a stunning kitchen complete with stone benchtops, a 900mm stove, and a well-equipped butler's pantry featuring a convenient servery to the alfresco—perfect for effortless entertaining. The open-plan design allows the kitchen to flow seamlessly into the dining, living, and lounge zones, all extending out to the covered alfresco area for indoor-outdoor living at its best.

The primary suite is a true retreat, boasting a spacious walk-in robe and a luxurious ensuite with floor-to-ceiling tiles and an oversized 1800mm shower. Additional flexibility is offered with a theatre room or second living/retreat space, perfectly positioned to capture tranquil views over the parklands opposite.

Outside, low-maintenance gardens ensure you can spend more time enjoying your surroundings and less time on upkeep.

Located just a short stroll to the local café and close to the foreshore, boat ramps, and scenic walking tracks, this home also offers easy access to the stunning attractions of the Bass Coast, including fishing spots, coastal reserves, and day trips to nearby destinations.

Whether you're seeking a permanent residence, a coastal escape, or a lifestyle upgrade, this exceptional property ticks every box.

This is one you won't want to miss—inspect today and experience the best of Corinella living.

3 BED | 2 BATH | 2 CAR

PRICE:

\$790,000 - \$810,000

OPEN FOR INSPECTION:

Apr 11 at 1:00pm - 1:30pm



Tamara Leskie

0448809458

tamara.leskie@atrealty.com.au

www.atrealtypropertyexperts.com.au

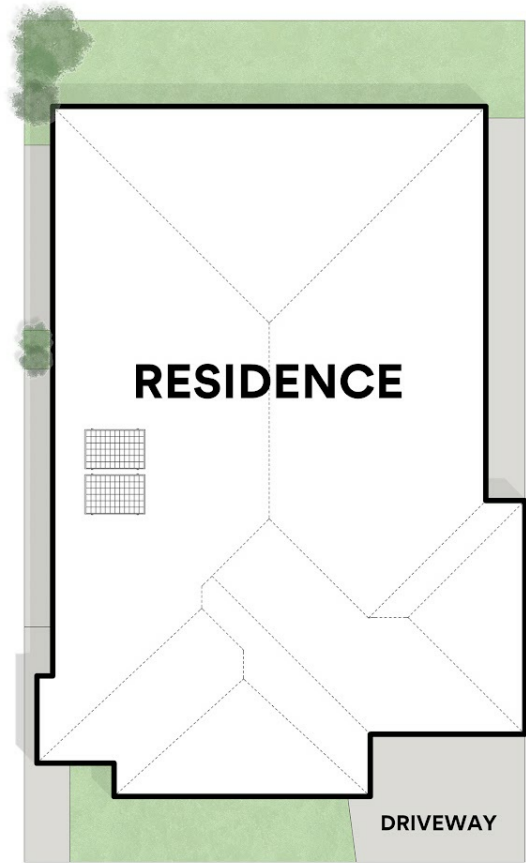

23 Nouvel Cres, Corinella

Whilst every attempt has been made to ensure the accuracy of the floorplans contained here, measurements of doors, windows and rooms are approximate and no responsibility is taken for any error, omission or misstatement. These plans are for representation purposes only.

Disclaimer: Please note this floor plan is for marketing purposes and is to be used as a guide only. All dimensions are estimates only and may not be exact measurements.