

FOR SALE

HUGE MODERN HOME ON 806M2 IN ELEVATED LOCATION!

Ladies and gentlemen, we are excited to present to you this ultra-large, modern and bespoke family home!

Featuring high-vaulted ceilings, the home incorporates 6 bedrooms, or 4 - 5 beds + rumpus/games + office.

There are spacious living areas + huge, well-appointed kitchen with large butler's pantry, and storage room.

This opens out onto a large deck that captures fresh breezes and elevated views of the surrounding locale.

All of the bedrooms are a fantastic size and there is a genuine sense of quality, light and space throughout.

The home includes 3 beautifully appointed and presented bathrooms, enormous laundry, and powder room.

The sprawling garage is capable of accommodating a host of vehicles or ample workshop or storage space.

There are double glazed windows + 2 heat-pump hot water systems + 19.5 kw solar panels + 15 kw inverter.

Constructed of ICF blocks, equivalent to "double-brick", fire resistant, improved acoustic and temp insulation.

And all of this is near shops, parks and is in the catchment for Shailer Park and Kimberley Park State Schools.

Plus, Brisbane and Gold Coast are easily accessible as the Pacific Highway and Logan Hyperdome are nearby.

6 BED | 3 BATH | 3 CAR

PRICE:

Please Contact For Price

OPEN FOR INSPECTION:

N/A



Ben Tafolo

0419260719

tafolo@atrealty.com.au

tafolorealty.com.au

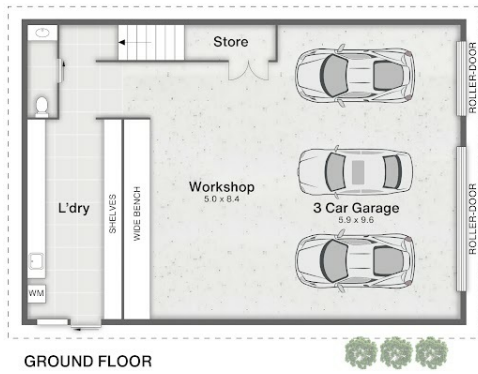

26 Reuben Street **CORNUBIA**

6 | 3 | 3 | 537m² | 806m²

All dimensions are approximate; they are subject to errors and inaccuracies and no liability will be accepted. Plans are shown for marketing purposes only.

Disclaimer: Please note this floor plan is for marketing purposes and is to be used as a guide only. All dimensions are estimates only and may not be exact measurements.